



OFFICIAL RECORDS OF
PINAL COUNTY RECORDER
VIRGINIA ROSS

DATE/TIME: 10/02/2013 0833

FEE: \$7.00

PAGES: 4

FEE NUMBER: 2013-079405



WHEN RECORDED RETURN
TO ARIZONA DEPARTMENT
OF TRANSPORTATION,
R/W OPERATIONS SEC.
205 S. 17TH AVE., MD 612E
PHOENIX, AZ 85007-3212

Escrow No. *N/A*

EXEMPT FROM AFFIDAVIT
By A.R.S. §11-1134-A-3

ARIZONA DEPARTMENT OF TRANSPORTATION

QUITCLAIM DEED

KNOW ALL MEN BY THESE PRESENTS,

That the **STATE OF ARIZONA**, acting by and through its **Department of Transportation**, and pursuant to A.R.S. §28-7092, for and in consideration of the sum of **ONE DOLLAR AND OTHER VALUABLE CONSIDERATION**, does hereby quitclaim to **THE CITY OF MARICOPA, an Arizona Municipal Corporation, P. O. Box 610, Maricopa, AZ, 85139**, all right, title and interest which the Grantor has controlling the right of access across the existing right of way at the following described location situated in the County of Pinal, State of Arizona:

SEE EXHIBIT "A" ATTACHED HERETO

AND BY REFERENCE MADE A PART HEREOF.

PROJECT: 347 PN 000 H2778 02R

LOCATION: Jct. SR 84 - Maricopa

PARCEL: D-T-110

RS - 347- (10)

(Vekol Wash Park)

sw 10-02-2013

IN WITNESS WHEREOF this instrument is executed this 2nd day of October, 2013.

ARIZONA DEPARTMENT
OF TRANSPORTATION

Paula I. Gibson

Chief Right of Way Agent

NOTARY CERTIFICATION

STATE OF ARIZONA)

) ss.

County of Maricopa)

The foregoing instrument was acknowledged before me this 2nd day of October, 2013
by Paula I. Gibson, the Chief Right of Way Agent of the
Arizona Department of Transportation, who acknowledged that he executed this instrument for the
purposes therein contained.

IN WITNESS WHEREOF, I have set my hand and official seal.

My commission expires:

7-12-14

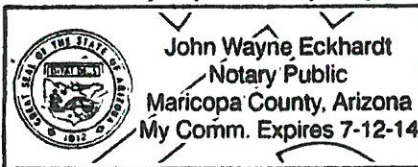

John Wayne Eckhardt
Notary Public
Document Type: QCD Parcel No: D-T-110

Wood, Patel & Associates, Inc.
(602) 335-8500
www.woodpatel.com

Revised September 27, 2013
Revised September 11, 2013
Revised November 20, 2012
Revised November 15, 2012
November 9, 2012
WP# 103547.01
Page 1 of 2
See Exhibit "A"

PARCEL DESCRIPTION
ADOT Access Control Break
Maricopa Regional Park
Maricopa, Arizona

A parcel of land lying within Section 34, Township 4 South, Range 3 East, of the Gila and Salt River Meridian, Pinal County, Arizona, more particularly described as follows:

Commencing at the northwest corner of said Section 34, a PK Nail with no identification, from which the west quarter corner of said section, a PK Nail with no identification, bears South 00°06'47" East (basis of bearing), a distance of 2631.71 feet;

THENCE along the north line of said section, South 89°54'45" East, a distance of 128.86 feet, to the east right-of-way line of John Wayne Parkway (State Route 347);

THENCE along said east right-of-way line, South 00°40'57" East, a distance of 1165.31 feet;

THENCE continuing along said east right-of-way line, South 89°19'03" West, a distance of 10.00 feet;

THENCE continuing along said east right-of-way line, South 00°40'57" East, a distance of 70.34 feet, to the **POINT OF BEGINNING** of said Access Control Break;

THENCE continuing along said east right-of-way line, South 00°40'57" East, a distance of 175.00 feet, to the **POINT OF ENDING** of said Access Control Break.

This parcel description is based on client provided information and is located within an area surveyed by Wood, Patel & Associates, Inc. during the month of May, 2012. Any monumentation noted in this parcel description is within acceptable tolerance (as defined in Arizona Boundary Survey Minimum Standards dated 02/14/2002) of said positions based on said survey.

Y:\WP\Parcel Descriptions\2010 Parcel Descriptions\103547.01 ADOT Access Control Break Maricopa Regional Park Maricopa Arizona L07R04 09-27-13.doc

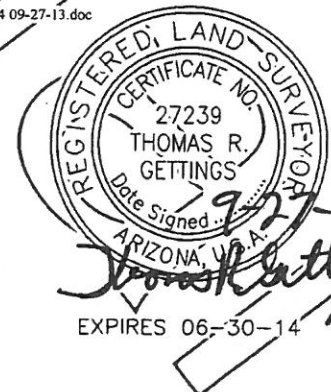

NORTH 1/4 CORNER
SECTION 34
T.4S., R.3E.

P.O.C.
NORTHWEST CORNER
SECTION 34
T.4S., R.3E.
PK NAIL WITH
NO IDENTIFICATION

S89°54'45"E 2649.53'

BOWLIN ROAD

F.P.=FINAL PLAT FOR DESERT CEDARS
CABINET E, SLIDE 086, P.C.R.

R.P.=RIGHT OF WAY PLAN OF THE
MARICOPA ROAD (SR 347) JCT. S.R.
84-MARICOPA 347 PN 000 H2778
02R RS-347-(10), DATED 1-6-92.

S00°06'47"E 2631.71'

**JOHN WAYNE PARKWAY
(STATE ROUTE 347)**

EXISTING ADOT RIGHT-OF-WAY LINE

LINE TABLE		
LINE	BEARING	DISTANCE
L1	S89°54'45"E	128.86'
L2	S00°40'57"E	1165.31'
L3	S89°19'03"W	10.00'
L4	S00°40'57"E	70.34'
L5	S00°40'57"E	175.00'

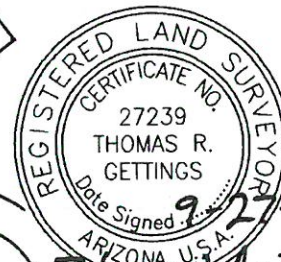

EXPIRES 06-30-14

WEST 1/4 CORNER
SECTION 34
T.4S., R.3E.
PK NAIL WITH
NO IDENTIFICATION

P.O.B. OF ACCESS
CONTROL BREAK

P.O.E. OF ACCESS
CONTROL BREAK

EXHIBIT "A"

ADOT ACCESS CONTROL BREAK
MARICOPA REGIONAL PARK
MARICOPA, ARIZONA
REVISED 09-27-13

WP#103457.01

PAGE 2 OF 2

NOT TO SCALE

WOOD/PATEL

2051 West Northern
Phoenix, AZ 85021
Phone: (602) 335-8500
Fax: (602) 335-8580
PHOENIX • MESA • TUCSON

T: \2010\103547\LEGAL\3547L07-DB\DWG\3547L07R04.DWG