

**Southbridge Marketplace**

NEC John Wayne Pkwy  
 and Honeycutt Avenue  
 Maricopa, Arizona

- ▲ Development Review Set
- △ Bid Set
- △ City Submittal
- △ Construction Set

Revisions:

**Ownership of Instruments of Service:**  
 This drawing is not to be used or reproduced without the consent of Suite 6 Architecture + Planning, Inc. The designs, images, and concepts on this drawing are the property of Suite 6 Architecture + Planning, Inc.



Seal  
 Date: June 20, 2024  
 Project Number: 763  
 Drawn by: dm/rdb

Sheet Number

# A1.2

Major C-Floor Plan

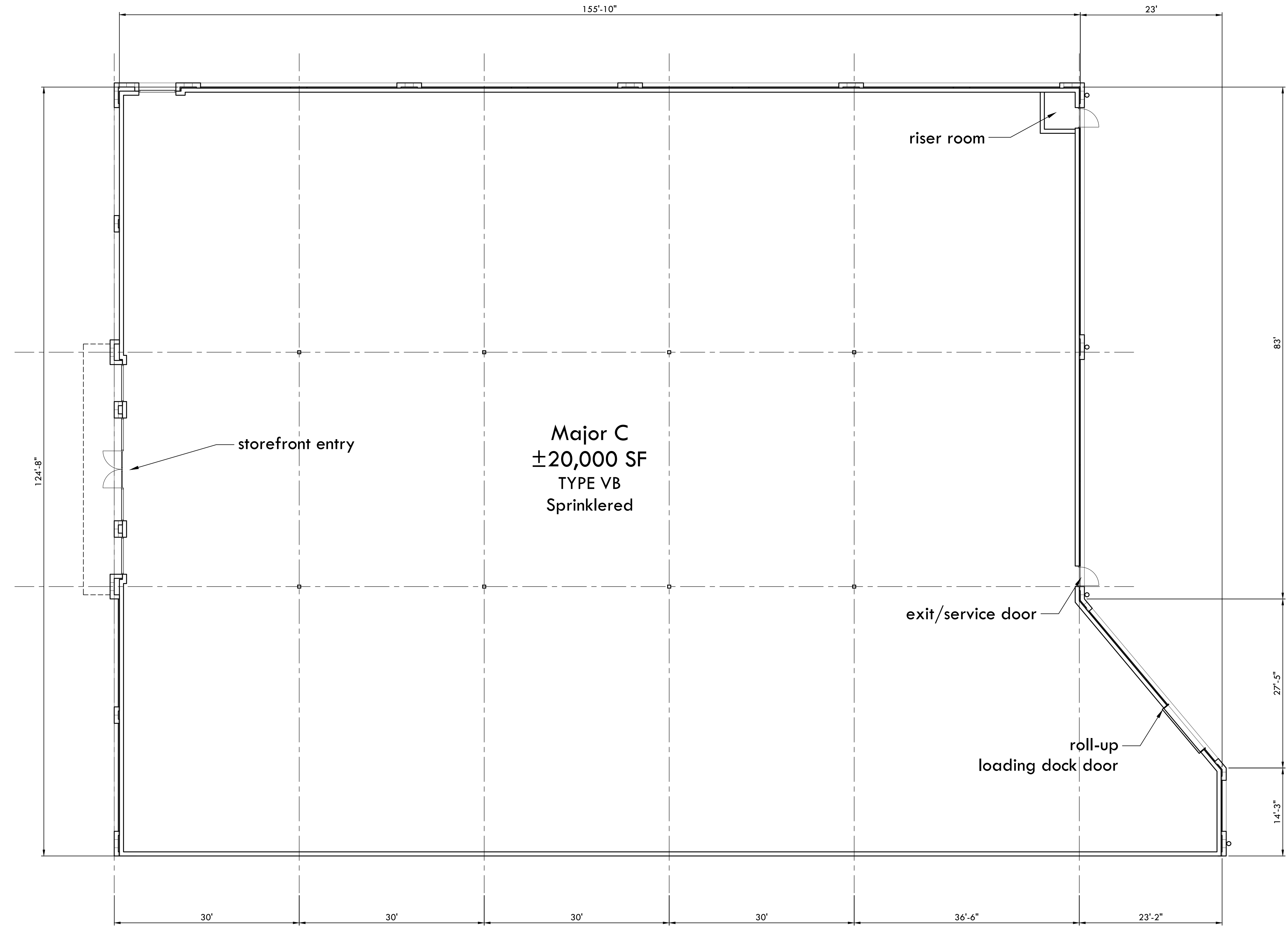

**Major C-Floor Plan**  
 0' 4' 8' 16' 32'

Copyright © 2023

APD Engineering & Architecture

Drawing Alteration

It is a violation of law for any person, unless acting under the direction of a licensed Architect, Professional Engineer, Landscape Architect, or Land Surveyor to alter any item on this document in any way. Any licensee who alters this document is required by law to affix his or her seal and to add the notation "Altered By" followed by his or her signature and the specific description of the alteration or revision.

DO NOT SCALE PLANS

Copying, Printing, Software and other processes required to produce these prints can stretch or shrink the actual paper or layout. Therefore, scaling of this drawing may be inaccurate. Contact APD E&A with any need for additional dimensions or clarifications.

Issued: Date:

A	Issued for Client Review	06/12/2024
B		
C		
D		
E		

Revisions: Date:

1		
2		
3		
4		
5		
6		
7		
8		
9		
10		
11		
12		

PROJECT ARCHITECT/ENGINEER DATE

PROJECT LEAD DATE

## NOT FOR CONSTRUCTION

Seal Seal

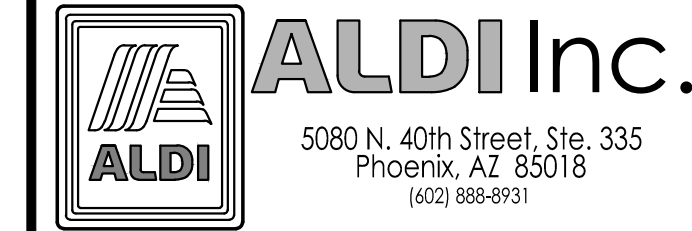

ALDI Inc. Store #: XX  
Maricopa, AZ  
N Maricopa Rd & W Honeycutt Ave  
Maricopa, AZ 85139  
Pinal County  
Project Name & Location:

Concept Floor Plan  
Drawing Name:  
Prototype: Project No.  
v7.0 23-0418A  
Type: GROUND UP  
Drawn By: DRW CFP-3  
Scale: As Noted Drawing No.

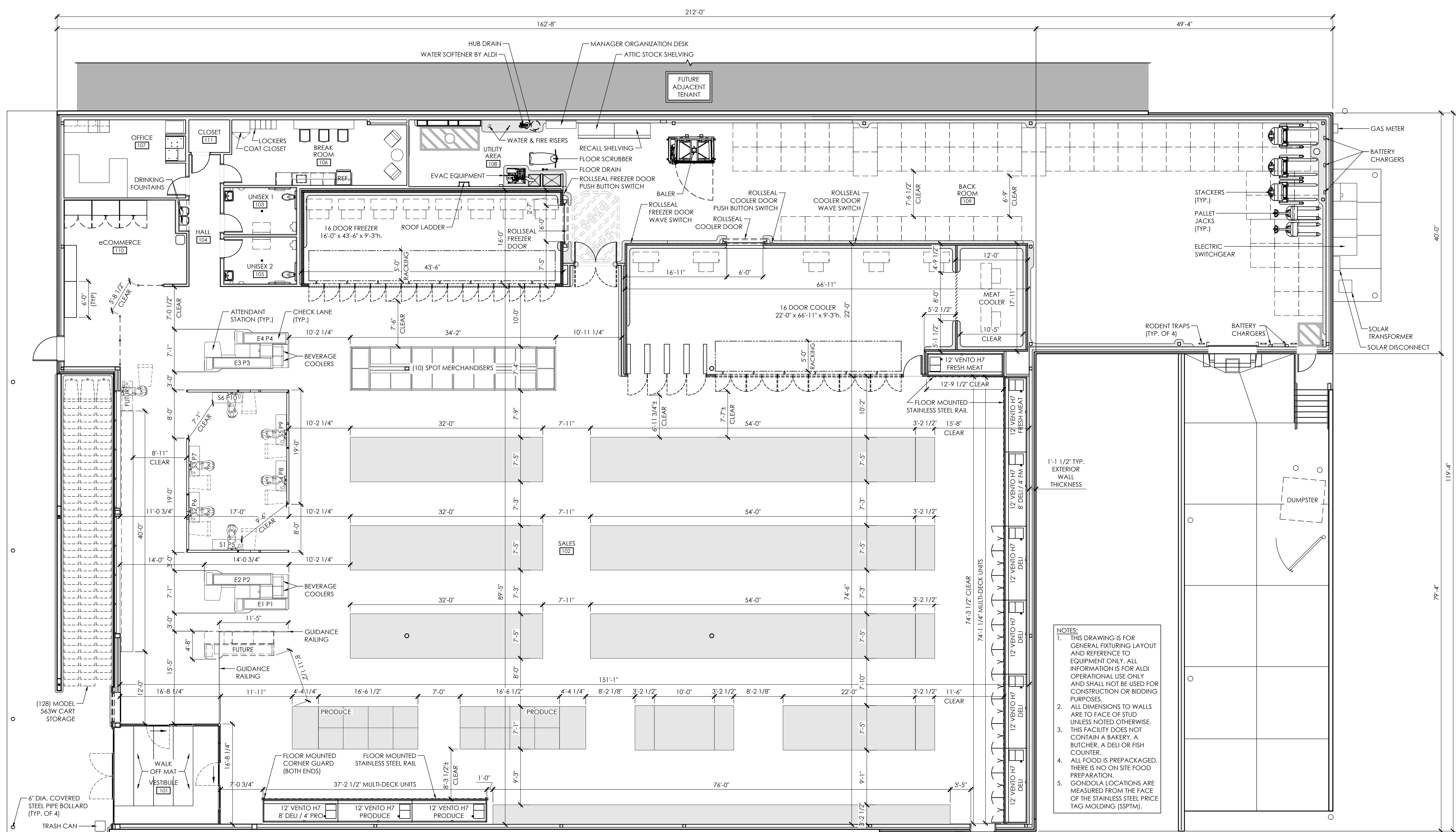

NOTES:  
1. THIS DRAWING IS FOR GENERAL FIXTURING LAYOUT AND REFERENCE TO EQUIPMENT ONLY. ALL INFORMATION IS FOR ALDI OPERATIONAL USE ONLY AND SHALL NOT BE USED FOR CONSTRUCTION OR BIDDING PURPOSES.  
2. ALL DIMENSIONS TO WALLS ARE TO FACE OF STUD UNLESS NOTED OTHERWISE.  
3. THIS FACILITY DOES NOT CONTAIN A BAKERY, A BUTCHER, A DELI OR FISH COUNTER.  
4. ALL FOOD IS PREPACKAGED. THERE IS NO ON SITE FOOD PREPARATION.  
5. GONDOLA LOCATIONS ARE MEASURED FROM THE FACE OF THE STAINLESS STEEL PRICE TAG MOLDING (SSPTM).

SIDE DOCK OPERATIONS DATA	
ITEM	V7.0 PROTOTYPE
LINEAR FOOTAGE OF BASE (PRODUCE INCLUDED)	779'-4"
ASSUMED PALLET STORAGE	74
BUILDING DIMENSIONS	119'-4" x 162'-8"
SALES FLOOR DIMENSIONS	74'-6" x 151'-1"
LENGTH OF MULTIDECK	120'
COOLER MILK DOORS	4
COOLER GENERAL DOORS	12
FREEZER GENERAL DOORS	16
SPOT MERCHANDISERS	10
CART STORAGE	128

SIDE DOCK AREA SUMMARY		
OCCUPANCY USE	ROOM NAME	SQUARE FOOTAGE
MERCANTILE (M)	SALES / VESTIBULE	12,573
	UNISEX 2	91
	UNISEX 1	91
	HALL	120
SUBTOTAL (MERCANTILE)		12,875
BUSINESS (B)	OFFICE	258
	BREAK ROOM	316
	eCOMMERCE	401
	CLOSET	36
SUBTOTAL (BUSINESS)		1011
STORAGE / STOCK (S-2)	BACKROOM	3,766
	COOLER	1,352
	FREEZER	647
SUBTOTAL (STORAGE / STOCK)		5,765
SUBTOTAL (OCCUPANCIES)		19,651
EXTERIOR / INTERIOR WALLS / UNOCCUPIED SPACE		1,131
BUILDING SQUARE FOOTAGE		20,782
EXTERIOR CANOPY		933
TOTAL SQUARE FOOTAGE (INCLUDING CANOPY)		21,715

1 Operations Plan  
SCALE: 1/8" = 1'-0"



▲	Development Review Set
△	Bid Set
△	City Submittal
△	Construction Set

Revisions:

Ownership of Instruments of Service:

This drawing is not to be used or reproduced without the consent of Suite 6 Architecture + Planning, Inc. The designs, images, and concepts on this drawing are the property of Suite 6 Architecture + Planning, Inc.



Seal

Date: June 20, 2024

Project Number: 763

Drawn by: dm/rdb

Sheet Number

**A1.1**

Shops/Pads Floor Plans

