

January 27, 2023

LEGAL DESCRIPTION FOR
MURPHY PARK
ZONING PARCEL

That part of Sections 9 and 10, Township 5 South, Range 4 East of the Gila and Salt River Meridian, Pinal County, Arizona, more particularly described as follows:

Beginning at the Cotton Picker Spindle marking the Northwest Corner of said Section 10;

Thence South 89°45'54" East, along the North line of the West Half of said Section 10, a distance of 2,595.34 feet to the Aluminum Cap stamped LS#36562 marking the North Quarter Corner thereof;

Thence South 00°01'51" East, along the East line of the West Half of said Section 10, a distance of 5,405.04 feet to the B.L.M. Brass Cap marking the South Quarter Corner thereof;

Thence North 89°44'02" West, along the South line of the West Half of said Section 10, a distance of 2,599.67 feet to the G.L.O. Brass Cap marking the Southeast Corner of said Section 9;

Thence North 25°30'39" West, a distance of 6,000.43 feet to the 1/2" Rebar marking the North Quarter Corner of said Section 9;

Thence South 89°44'18" East, along the North line of the Northeast Quarter of said Section 9, a distance of 2,585.73 feet to the Point of Beginning.

Containing 21,023,674 Square Feet or 482.637 Acres, more or less.

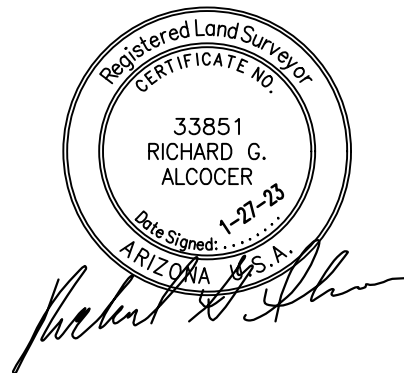

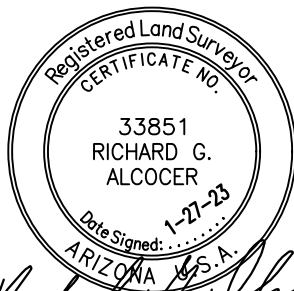

NORTH 1/4 CORNER
SECTION 9

POINT OF BEGINNING
NORTHEAST CORNER, SECTION 9
NORTHWEST CORNER, SECTION 10

STEEN ROAD

NORTH 1/4 CORNER
SECTION 10

S89°44'18"E 2585.73'

S89°45'54"E 2595.34'

N25°30'39"W 6000.43'

MURPHY ROAD

S00°01'51"E 5405.04'

PETERS & NALL ROAD

N89°44'02"W 2599.67'

SOUTH 1/4 CORNER
SECTION 10

SOUTHEAST CORNER, SECTION 9
SOUTHWEST CORNER, SECTION 10

SCALE 1" = 1000'

EXHIBIT

4550 North 12th Street
Phoenix, Arizona 85014
Phone 602-264-6831
<http://www.cvlci.com>

MURPHY PARK

ZONING PARCEL



1 OF 1

MURPHY PARK
ZONING PARCEL CLOSURE

The date and time is 1/27/2023 10:18 AM

* FILEPATH / NAME:
N:\01\0383901\CADD\COGO\CB.LEGALS
.dwg

BOUNDARY

S89°45'54.3915" E 2,595.34

S00°01'51.0549" E 5,405.04

N89°44'01.9708" W 2,599.67

N25°30'39.0468" W 6,000.43

S89°44'17.8277" E 2,585.73
to

Area = 21,023,674 482.637 AC

Closing course: 301°14'30.9194" 0.014329

Misclosure: 1/1,000,000+

North Error: 0.007432
East Error: 0.012251

N:\01\0383901\CADD\COGO\CB.LEGALS
.dwg

