

Arizona Department of Liquor Licenses and Control  
800 West Washington, 5th Floor  
Phoenix, Arizona 85007  
www.azliquor.gov  
602-542-5141

14 AUG 7 11:29 AM

**APPLICATION FOR LIQUOR LICENSE**  
TYPE OR PRINT WITH BLACK INK

Notice: Effective Nov. 1, 1997, All Owners, Agents, Partners, Stockholders, Officers, or Managers actively involved in the day to day operations of the business must attend a Department approved liquor law training course or provide proof of attendance within the last five years. See page 6 of the Liquor Licensing requirements.

**SECTION 1** This application is for a:

- MORE THAN ONE LICENSE
- INTERIM PERMIT *Complete Section 5*
- NEW LICENSE *Complete Sections 2, 3, 4, 13, 14, 15, 16*
- PERSON TRANSFER (Bars & Liquor Stores ONLY)  
*Complete Sections 2, 3, 4, 11, 13, 15, 16*
- LOCATION TRANSFER (Bars and Liquor Stores ONLY)  
*Complete Sections 2, 3, 4, 12, 13, 15, 16*
- PROBATE/WILL ASSIGNMENT/DIVORCE DECREE  
*Complete Sections 2, 3, 4, 9, 13, 16 (fee not required)*
- GOVERNMENT *Complete Sections 2, 3, 4, 10, 13, 15, 16*

**SECTION 2** Type of ownership:

- J.T.W.R.O.S. *Complete Section 6*
- INDIVIDUAL *Complete Section 6*
- PARTNERSHIP *Complete Section 6*
- CORPORATION *Complete Section 7*
- LIMITED LIABILITY CO. *Complete Section 7*
- CLUB *Complete Section 8*
- GOVERNMENT *Complete Section 10*
- TRUST *Complete Section 6*
- OTHER (Explain) \_\_\_\_\_

**SECTION 3** Type of license and fees LICENSE #(s): 06110029

1. Type of License(s): SERIES 6 - BAR

2. Total fees attached: \$ 2220

**APPLICATION FEE AND INTERIM PERMIT FEES (IF APPLICABLE) ARE NOT REFUNDABLE.**  
The fees allowed under A.R.S. 44-6852 will be charged for all dishonored checks.

**SECTION 4** Applicant

1. Owner/Agent's Name:  Mr. MORSE THERESA JUNE  
 Ms. Last First Middle  
(Insert one name ONLY to appear on license)

2. Corp./Partnership/L.L.C.: CHIMI'S, LLC  
(Exactly as it appears on Articles of Inc. or Articles of Org.)

3. Business Name: O'SHAYS PUB & GRILL  
(Exactly as it appears on the exterior of premises)

4. Principal Street Location: 20800 N JOHN WAYNE PKWY #101 MARICOPA PINAL 85139  
(Do not use PO Box Number) City County Zip

5. Business Phone: 520-568-5338 Daytime Phone: 480-353-8035 Email: TJMORSE1208@Q.COM

6. Is the business located within the incorporated limits of the above city or town?  YES  NO

7. Mailing Address: 20800 N JOHN WAYNE PKWY #101 MARICOPA ARIZONA 85139  
City State Zip

8. Price paid for license only bar, beer and wine, or liquor store: Type 6 \$ 23,500.00 Type \$

DEPARTMENT USE ONLY				
Fees:	<u>2000</u>			<u>2200</u>
Application	Interim Permit	Site Inspection	Finger Prints	TOTAL OF ALL FEES
Is Arizona Statement of Citizenship & Alien Status For State Benefits complete? <input type="checkbox"/> YES <input type="checkbox"/> NO				
Accepted by:	<u>AE</u>	Date:	<u>8/7/2014</u>	Lic. # <u>06110029</u>

**SECTION 5 Interim Permit:**

1. If you intend to operate business when your application is pending you will need an Interim Permit pursuant to A.R.S. 4-203.01.
2. There **MUST** be a valid license of the same type you are applying for currently issued to the location.
3. Enter the license number currently at the location. \_\_\_\_\_
4. Is the license currently in use?  YES  NO If no, how long has it been out of use? \_\_\_\_\_

14 AUG 7 11:41 AM '13

**ATTACH THE LICENSE CURRENTLY ISSUED AT THE LOCATION TO THIS APPLICATION.**

I, \_\_\_\_\_, declare that I am the CURRENT OWNER, AGENT, CLUB MEMBER, PARTNER,  
(Print full name)  
 MEMBER, STOCKHOLDER, OR LICENSEE (circle the title which applies) of the stated license and location.

State of \_\_\_\_\_ County of \_\_\_\_\_

X \_\_\_\_\_  
(Signature)

The foregoing instrument was acknowledged before me this

\_\_\_\_\_ day of \_\_\_\_\_, \_\_\_\_\_ Year  
Day Month Year

My commission expires on: \_\_\_\_\_

\_\_\_\_\_  
(Signature of NOTARY PUBLIC)

**SECTION 6 Individual or Partnership Owners:**

**EACH PERSON LISTED MUST SUBMIT A COMPLETED QUESTIONNAIRE (FORM LIC0101), AN "APPLICANT" TYPE FINGERPRINT CARD, AND \$22 PROCESSING FEE FOR EACH CARD.**

1. Individual:

Last	First	Middle	% Owned	Mailing Address	City State Zip

Partnership Name: (Only the first partner listed will appear on license) \_\_\_\_\_

General-Limited	Last	First	Middle	% Owned	Mailing Address	City State Zip
<input type="checkbox"/> <input type="checkbox"/>						
<input type="checkbox"/> <input type="checkbox"/>						
<input type="checkbox"/> <input type="checkbox"/>						
<input type="checkbox"/> <input type="checkbox"/>						

) Y R A S S E C E N F I T

2. Is any person, other than the above, going to share in the profits/losses of the business?  YES  NO  
 If Yes, give name, current address and telephone number of the person(s). Use additional sheets if necessary.

Last	First	Middle	Mailing Address	City, State, Zip	Telephone#

**SECTION 7 Corporation/Limited Liability Co.:**

EACH PERSON LISTED MUST SUBMIT A COMPLETED QUESTIONNAIRE (FORM LIC0101), AN "APPLICANT" TYPE FINGERPRINT CARD, AND \$22 PROCESSING FEE FOR EACH CARD.

CORPORATION Complete questions 1, 2, 3, 5, 6, 7, and 8.

\*14 AUG 7 Lic. Lic. #11129

L.L.C. Complete 1, 2, 4, 5, 6, 7, and 8.

1. Name of Corporation/L.L.C.: CHIMI'S, LLC  
(Exactly as it appears on Articles of Incorporation or Articles of Organization)

2. Date Incorporated/Organized: 02/11/2009 State where Incorporated/Organized: ARIZONA

3. AZ Corporation Commission File No.: \_\_\_\_\_ Date authorized to do business in AZ: \_\_\_\_\_

4. AZ L.L.C. File No: L-1505390-7 Date authorized to do business in AZ: 03/17/2009

5. Is Corp./L.L.C. Non-profit?  YES  NO

6. List all directors, officers and members in Corporation/L.L.C.:

Last	First	Middle	Title	Mailing Address	City State Zip
SCHRODER	TED	RICHARD	MANAGER	20800 N JOHN WAYNE PKWY #101 MARICOPA AZ	85139

(ATTACH ADDITIONAL SHEET IF NECESSARY)

7. List stockholders who are controlling persons or who own 10% or more:

Last	First	Middle	% Owned	Mailing Address	City State Zip
SCHRODER	TED	RICHARD	100	20800 N JOHN WAYNE PKWY #101 MARICOPA AZ	85139

(ATTACH ADDITIONAL SHEET IF NECESSARY)

8. If the corporation/L.L.C. is owned by another entity, attach a percentage of ownership chart, and a director/officer/member disclosure for the parent entity. Attach additional sheets as needed in order to disclose personal identities of all owners.

**SECTION 8 Club Applicants:**

EACH PERSON LISTED MUST SUBMIT A COMPLETED QUESTIONNAIRE (FORM LIC0101), AN "APPLICANT" TYPE FINGERPRINT CARD, AND \$22 PROCESSING FEE FOR EACH CARD.

1. Name of Club: \_\_\_\_\_ Date Chartered: \_\_\_\_\_  
(Exactly as it appears on Club Charter or Bylaws) (Attach a copy of Club Charter or Bylaws)

2. Is club non-profit?  YES  NO

3. List officer and directors:

Last	First	Middle	Title	Mailing Address	City State Zip

(ATTACH ADDITIONAL SHEET IF NECESSARY)

**SECTION 9 Probate, Will Assignment or Divorce Decree of an existing Bar or Liquor Store License:**

- 1. Current Licensee's Name: \_\_\_\_\_  
(Exactly as it appears on license) Last First Middle
- 2. Assignee's Name: \_\_\_\_\_  
Last First Middle
- 3. License Type: \_\_\_\_\_ License Number: \_\_\_\_\_ Date of Last Renewal: \_\_\_\_\_
- 4. ATTACH TO THIS APPLICATION A CERTIFIED COPY OF THE WILL, PROBATE DISTRIBUTION INSTRUMENT, OR DIVORCE DECREE THAT SPECIFICALLY DISTRIBUTES THE LIQUOR LICENSE TO THE ASSIGNEE TO THIS APPLICATION.

**SECTION 10 Government: (for cities, towns, or counties only)**

- 1. Governmental Entity: \_\_\_\_\_
- 2. Person/designee: \_\_\_\_\_  
Last First Middle Contact Phone Number

**A SEPARATE LICENSE MUST BE OBTAINED FOR EACH PREMISES FROM WHICH SPIRITUOUS LIQUOR IS SERVED.**

**SECTION 11 Person to Person Transfer:**

Questions to be completed by CURRENT LICENSEE (Bars and Liquor Stores ONLY-Series 06,07, and 09).

- 1. Current Licensee's Name: LOPEZ ENRIQUEZ RAMON ANTONIO Entity: AGENT  
(Exactly as it appears on license) Last First Middle (Indiv., Agent, etc.)
- 2. Corporation/L.L.C. Name: PUEBLO VIEJO NIGHT CLUB, LLC  
(Exactly as it appears on license)
- 3. Current Business Name: PUEBLO VIEJO NIGHT CLUB & SPORT BAR EL ROMANCE SAN  
(Exactly as it appears on license)
- 4. Physical Street Location of Business: Street 300 E. FRONTIER ST  
City, State, Zip ELOY, AZ 85231 85131
- 5. License Type: #6-BAR License Number: 06110029
- 6. If more than one license to be transferred: License Type: N/A License Number: N/A
- 7. Current Mailing Address: Street 3065 W. CORNMAN RD.  
(Other than business) City, State, Zip ELOY, AZ 85131

14 AUG 7 11:01 AM '09

- 8. Have all creditors, lien holders, interest holders, etc. been notified of this transfer?  YES  NO
- 9. Does the applicant intend to operate the business while this application is pending?  YES  NO If yes, complete Section 5 of this application, attach fee, and current license to this application.

10. I, RAMON ANTONIO LOPEZ ENRIQUEZ, hereby authorize the department to process this application to transfer the  
(print full name)

privilege of the license to the applicant, provided that all terms and conditions of sale are met. Based on the fulfillment of these conditions, I certify that the applicant now owns or will own the property rights of the license by the date of issue.

I, RAMON ANTONIO LOPEZ ENRIQUEZ, declare that I am the CURRENT OWNER, AGENT, MEMBER, PARTNER  
(print full name)

STOCKHOLDER, or LICENSEE of the stated license. I have read the above Section 11 and confirm that all statements are true, correct, and complete.

[Signature]  
(Signature of CURRENT LICENSEE)

State of Arizona County of Maricopa  
The foregoing instrument was acknowledged before me this  
6 Day July Month 2014 Year

[Signature]  
(Signature of NOTARY PUBLIC)

My Commission Expires on 2-3-18  
Geronimo M Chavez  
Notary Public  
Maricopa County, Arizona  
My Comm. Expires 02-03-18

STATE OF ARIZONA

DEPARTMENT OF LIQUOR LICENSES  
AND CONTROL  
ALCOHOLIC BEVERAGE LICENSE

License 06110029

Issue Date: 2/29/2012

Expiration Date: 8/31/2014

Issued To:  
RAMON ANTONIO LOPEZ ENRIQUEZ, Agent  
PUEBLO VIEJO NIGHT CLUB LLC, Owner

Bar

Mailing Address:

RAMON ANTONIO LOPEZ ENRIQUEZ  
PUEBLO VIEJO NIGHT CLUB LLC  
EL ROMANCE  
3065-W CORNMAN RD  
ELOY, AZ 85131

Location:  
EL ROMANCE  
300 E FRONTIER ST  
ELOY, AZ 85131

INACTIVE



EXP 8/31/2014

POST THIS LICENSE IN A CONSPICUOUS PLACE



# Bill of Sale

DATE 7-10-14 BY Ted Schroder

IN CONSIDERATION OF THE SUM OF:

**\*\*\* Twenty-Three Thousand Five Hundred Dollars And No Cents \*\*\*** lawful currency of the United States of America, and other valuable consideration, receipt of which is hereby acknowledged, the SELLER:

**Pueblo Viejo Night Club, LLC, an Arizona Limited Liability Company**

hereby grants, bargains, sells and transfers unto the BUYER:

**Ted Schroder, a married man as his sole and separate property**

and his, her or their heirs, personal representatives, or assigns, to have and to hold forever, the following described personal property, goods or chattels:

That certain State of Arizona Liquor License #06110029

FURTHERMORE, Seller warrants that he, she or they are the lawful owner of said goods and hereby certifies, under oath, that he, she or they have good right to sell the same as aforesaid, and that the above described property is free and clear of all claims, liens and other encumbrances whatsoever, EXCEPT, as specified herein. Seller further agrees to warrant and defend same against the lawful claims and demands of all persons whomsoever.

DATED: July 3, 2014

**Pueblo Viejo Night Club, LLC, an Arizona  
Limited Liability Company**

Ramon Antonio Lopez Enriquez  
Ramon Antonio Lopez Enriquez, Manager

14 AUG 7 11:41 AM  
LIC. #06110029

State of ARIZONA } ss:  
County of Maricopa

On July 3, 2014, before me, the undersigned, a Notary Public in and for said County and State, personally appeared Ramon Antonio Lopez Enriquez, Manager, personally known to me (or proved to me on the basis of satisfactory evidence) to be the person(s) whose name(s) is/are subscribed to the within instrument and acknowledged to me that he/she/they executed the same in his/her/their authorized capacity(ies), and that by his/her/their signature(s) on the instrument the person(s), or the entity upon behalf of which the person(s) acted, executed the instrument.  
WITNESS my hand and official seal.

[Signature]  
Notary Public

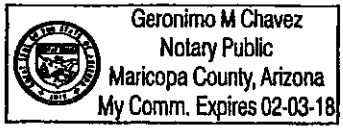

Escrow No.: 00143535

**SECTION 13 - continued**

- 7. Has a license or a transfer license for the premises on this application been denied by the state within the past one (1) year?  
 YES  NO If yes, attach explanation.
- 8. Does any spirituous liquor manufacturer, wholesaler, or employee have any interest in your business?  YES  NO
- 9. Is the premises currently licensed with a liquor license?  YES  NO If yes, give license number and licensee's name:

License # 12113207 (exactly as it appears on license) Name THERESA JUNE MORSE

**SECTION 14 Restaurant or hotel/motel license applicants:**

- 1. Is there an existing restaurant or hotel/motel liquor license at the proposed location?  YES  NO  
 If yes, give the name of licensee, Agent or a company name:

\_\_\_\_\_ and license #: \_\_\_\_\_  
Last First Middle

- 2. If the answer to Question 1 is YES, you may qualify for an Interim Permit to operate while your application is pending; consult A.R.S. § 4-203.01; and complete SECTION 5 of this application.
- 3. All restaurant and hotel/motel applicants must complete a Restaurant Operation Plan (Form LIC0114) provided by the Department of Liquor Licenses and Control.
- 4. As stated in A.R.S. § 4-205.02.G.2, a restaurant is an establishment which derives at least 40 percent of its gross revenue from the sale of food. Gross revenue is the revenue derived from all sales of food and spirituous liquor on the licensed premises. By applying for this  hotel/motel  restaurant license, I certify that I understand that I must maintain a minimum of 40 percent food sales based on these definitions and have included the Restaurant Hotel/Motel Records Required for Audit (form LIC 1013) with this application.

\_\_\_\_\_  
 applicant's signature

As stated in A.R.S. § 4-205.02 (B), I understand it is my responsibility to contact the Department of Liquor Licenses and Control to schedule an inspection when all tables and chairs are on site, kitchen equipment, and, if applicable, patio barriers are in place on the licensed premises. With the exception of the patio barriers, these items are not required to be properly installed for this inspection. Failure to schedule an inspection will delay issuance of the license. If you are not ready for your inspection 90 days after filing your application, please request an extension in writing, specify why the extension is necessary, and the new inspection date you are requesting. To schedule your site inspection visit [www.azliquor.gov](http://www.azliquor.gov) and click on the "Information" tab.

\_\_\_\_\_  
 applicants initials

**SECTION 15 Diagram of Premises: (Blueprints not accepted, diagram must be on this form)**

- 1. Check ALL boxes that apply to your business:  
 Entrances/Exits       Liquor storage areas      Patio:  Contiguous  
 Service windows       Drive-in windows       Non Contiguous
- 2. Is your licensed premises currently closed due to construction, renovation, or redesign?  YES  NO  
 If yes, what is your estimated opening date? \_\_\_\_\_  
month/day/year
- 3. Restaurants and hotel/motel applicants are required to draw a detailed floor plan of the kitchen and dining areas including the locations of all kitchen equipment and dining furniture. Diagram paper is provided on page 7.
- 4. The diagram (a detailed floor plan) you provide is required to disclose only the area(s) where spirituous liquor is to be sold, served, consumed, dispensed, possessed, or stored on the premises unless it is a restaurant (see #3 above).
- 5. Provide the square footage or outside dimensions of the licensed premises. Please do not include non-licensed premises, such as parking lots, living quarters, etc.

**As stated in A.R.S. § 4-207.01(B), I understand it is my responsibility to notify the Department of Liquor Licenses and Control when there are changes to boundaries, entrances, exits, added or deleted doors, windows or service windows, or increase or decrease to the square footage after submitting this initial drawing.**

  
 applicants initials



**SECTION 15 Diagram of Premises**

4. In this diagram please show only the area where spirituous liquor is to be sold, served, consumed, dispensed, possessed or stored. It must show all entrances, exits, interior walls, bars, bar stools, hi-top tables, dining tables, dining chairs, the kitchen, dance floor, stage, and game room. Do not include parking lots, living quarters, etc. When completing diagram, North is up ↑.

If a legible copy of a rendering or drawing of your diagram of premises is attached to this application, please write the words "diagram attached" in box provided below.

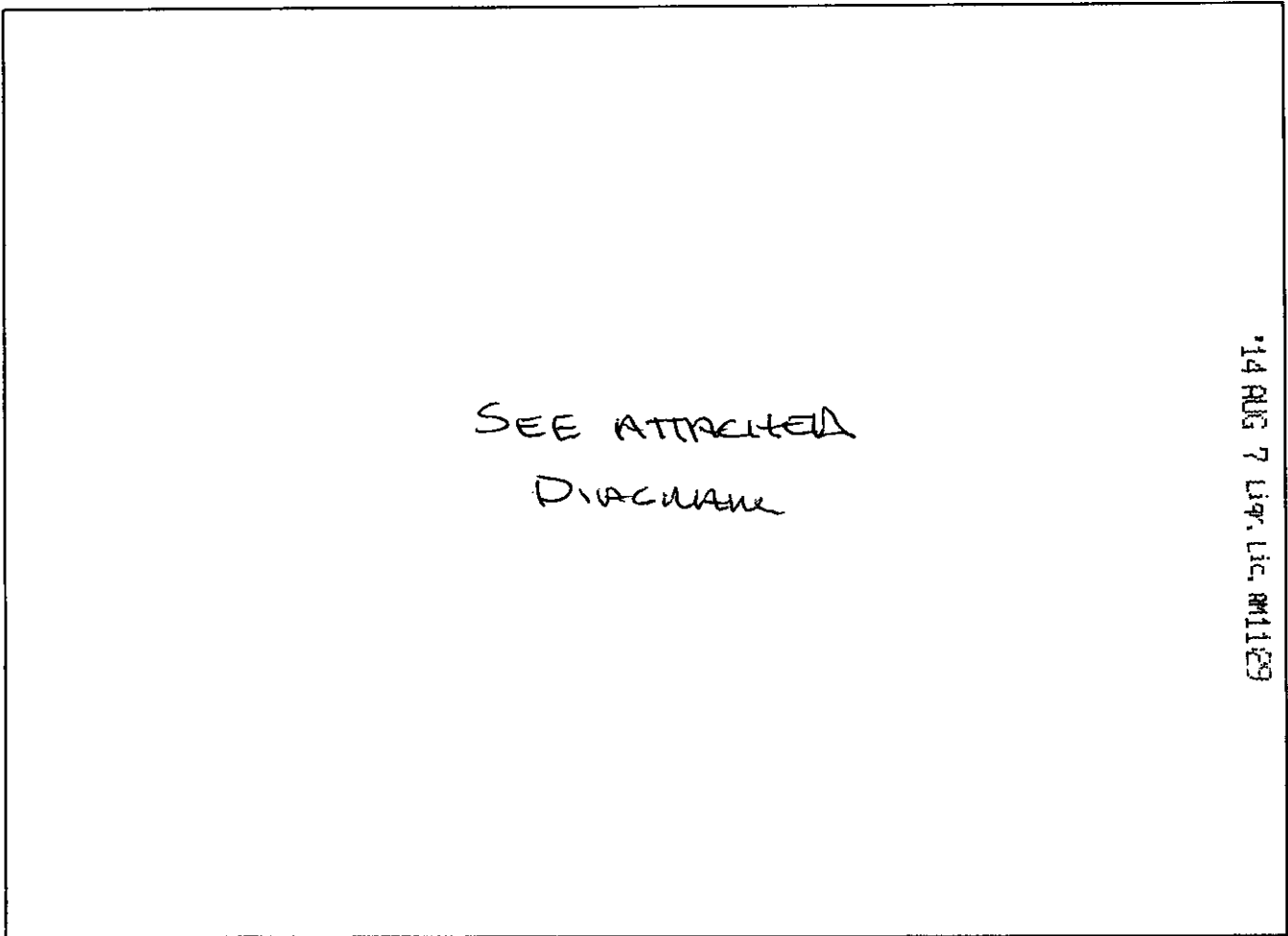

**SECTION 16 Signature Block**

I, THERESA JUNE MORSE, hereby declare that I am the OWNER/AGENT filing this application as stated in Section 4, Question 1. I have read this application and verify all statements to be true, correct and complete.

X [Handwritten Signature]  
(signature of applicant listed in Section 4, Question 1)

State of ARIZONA County of COCHISE

The foregoing instrument was acknowledged before me this 7 of AUGUST, 2014

[Handwritten Signature]  
signature of NOTARY PUBLIC

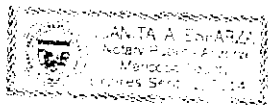

My commission expires on : \_\_\_\_\_  
Day Month Year

↑ N

11 SEP 19 194. Lic. PM 2:07

14 AUG 7 194. Lic. PM 11:29

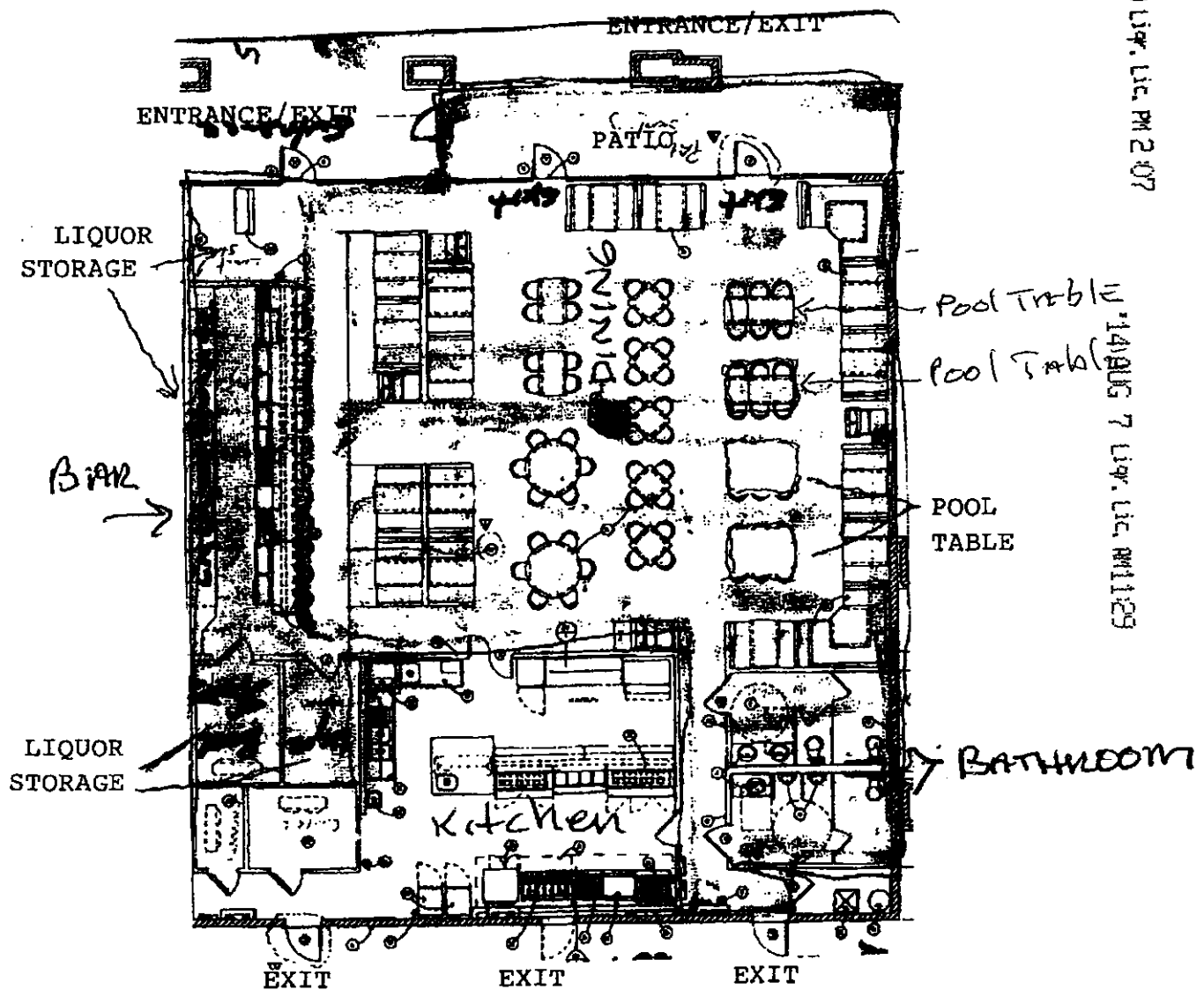

4000 SQ FT