



**Legal Description
RWCD Irrigation Easement - Lateral 14
EAST GERMANN ROAD RIGHT-OF-WAY**

Job No. 17-007.32

December 30, 2020

A portion of the southwest quarter of Section 5, Township 2 South, Range 6 East of the Gila and Salt River Meridian, Maricopa County, Arizona, more particularly described as follows:

COMMENCING at a nail at the southwest corner of said Section 5, from which a brass cap in handhole at the south quarter corner of said Section 5 bears North 89 degrees 36 minutes 32 seconds East, 2678.25 feet.

thence along the west line of said Section 5, North 0 degrees 06 minutes 35 seconds West, 64.64 feet to the POINT OF BEGINNING;

thence continuing along the west line of said Section 5, North 0 degrees 06 minutes 35 seconds West, 14.01 feet;

thence South 88 degrees 29 minutes 26 seconds East, 84.18 feet;

thence South 45 degrees 15 minutes 02 seconds East, 1.20 feet;

thence North 89 degrees 36 minutes 32 seconds East, 24.82 feet;

thence South 88 degrees 29 minutes 26 seconds East, 60.30 feet to a point on a line parallel with and 73 feet north of the south line of said southwest quarter;

thence along said parallel line, North 89 degrees 36 minutes 32 seconds East, 371.49 feet;



thence South 0 degrees 23 minutes 28 seconds East, 3.00 feet to a point on a line parallel with and 70 feet north of the south line of said southwest quarter;

thence along said parallel line, North 89 degrees 36 minutes 32 seconds East, 2112.69 feet;

thence South 0 degrees 23 minutes 30 seconds East, 14.00 feet to a point on a line parallel with and 56 feet north of the south line of said southwest quarter;

thence along said parallel line, South 89 degrees 36 minutes 32 seconds West, 2115.69 feet;

thence North 87 degrees 53 minutes 35 seconds West, 68.83 feet to a point on a line parallel with and 59 feet north of the south line of said southwest quarter;

thence along said parallel line, South 89 degrees 36 minutes 32 seconds West, 299.97 feet;

thence North 88 degrees 29 minutes 26 seconds West, 170.00 feet to the POINT OF BEGINNING.

Contains 37,261 square feet and 0.8554 acres, more or less.

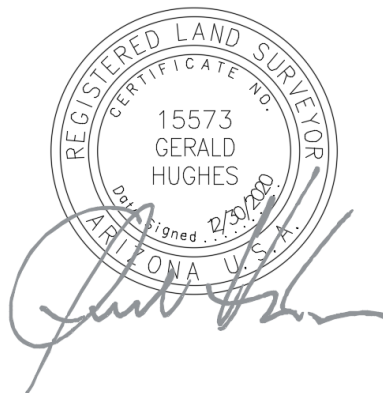

EPS Group, Inc. • 1130 N. Alma School Rd, Suite 120 • Mesa, AZ 85201
Tel (480) 503-2250 • Fax (480) 503-2258

S:\Projects\2017\17-007\17-007.32-RWCD-Lat-14-TOG-ST-145\Legal Survey\Legals\3_Legal_TOG Legal Description.docx