

2.13 D3 PAD Proposed Land Use Plan

The proposed D3 PAD is, in general terms, the site of the Medical and Innovation Campuses as well as related site improvements for parking, vehicular and pedestrian circulation and helistop medical transport services.

The specific D3 PAD is comprised of two campuses totaling 1.6 million square feet of building area upon completion on 26.3-acres as described below:

1. The Medical Campus is approximately fourteen (14.3) acres.
2. The Innovation Campus is twelve (12) acres.

The below illustrates the future development of two campuses within Copper Sky Park.

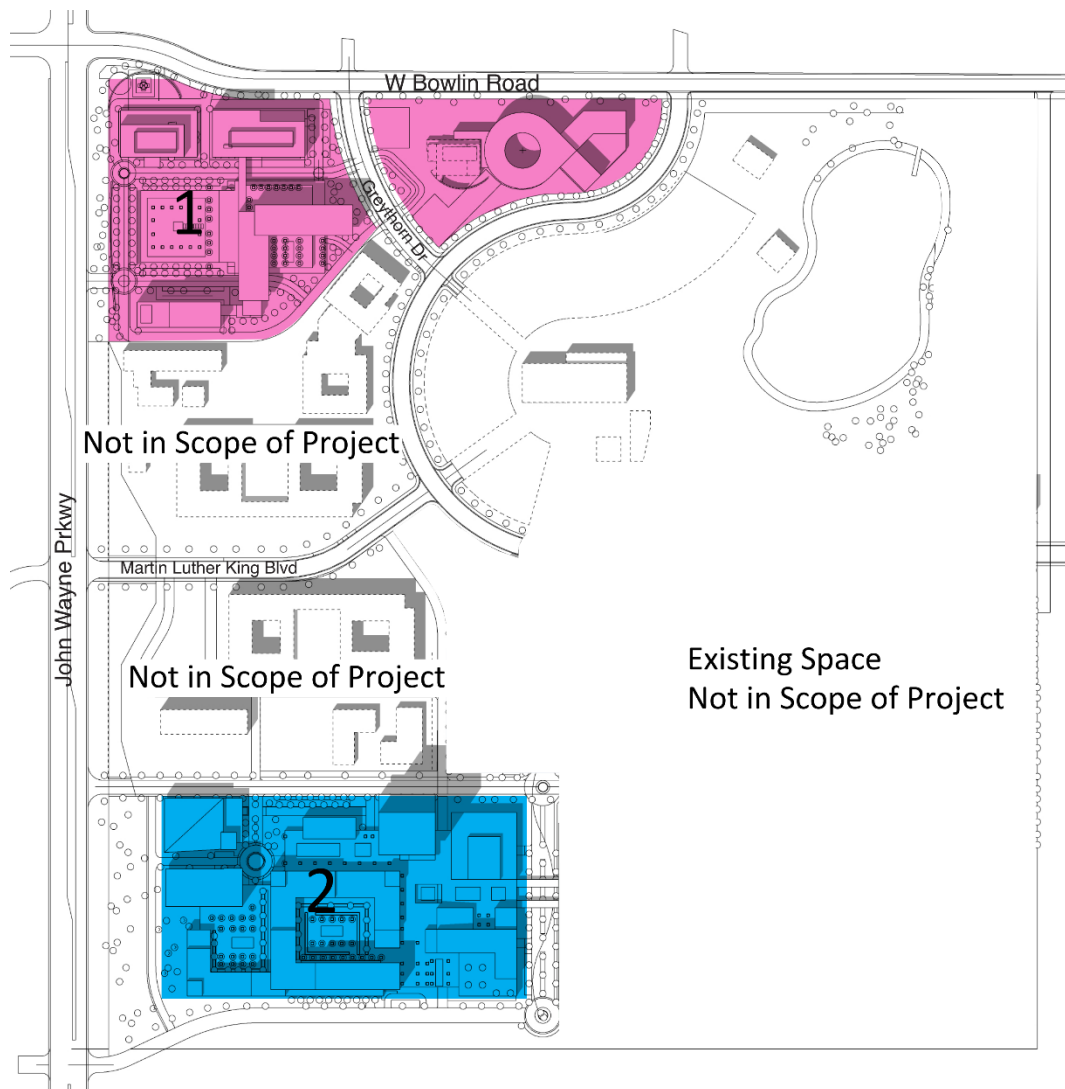

D3 PAD Proposed Land Use Plan