

# ELECTRICAL SYMBOLS AND ABBREVIATIONS

## REFERENCE SYMBOLS

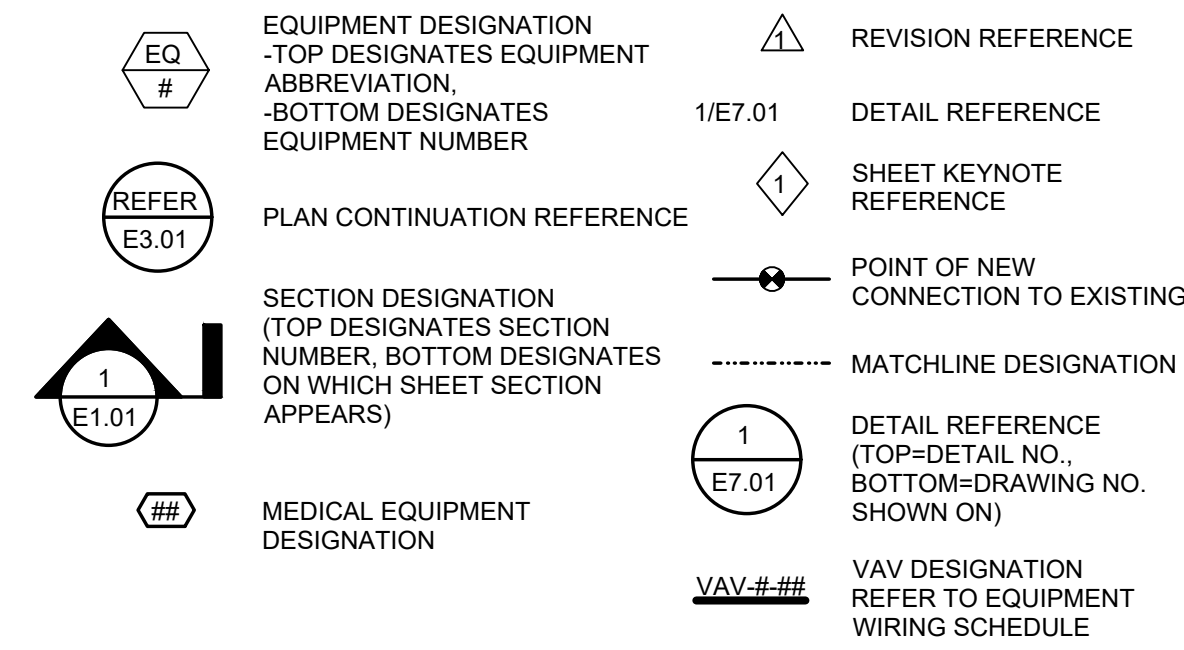

## SITE LIGHTING



## PANELBOARDS

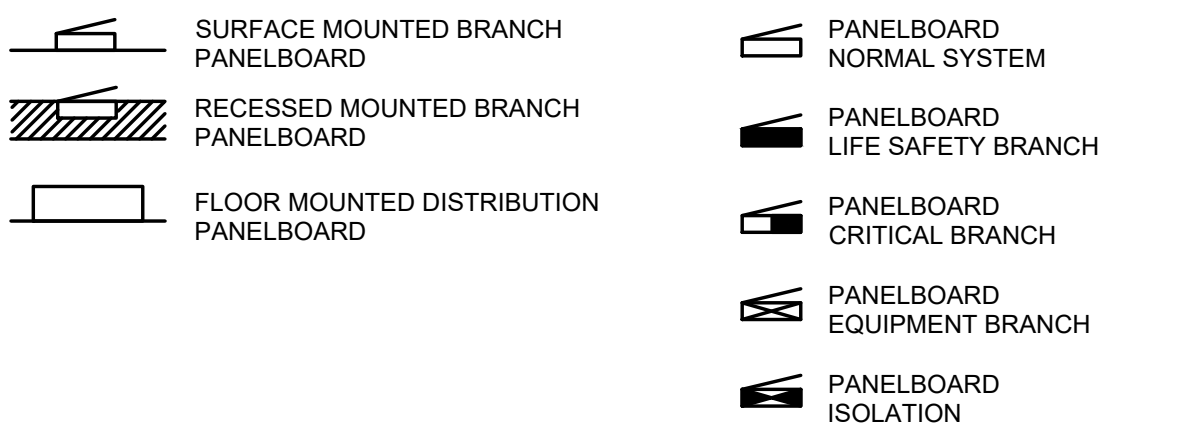

## LIGHTING

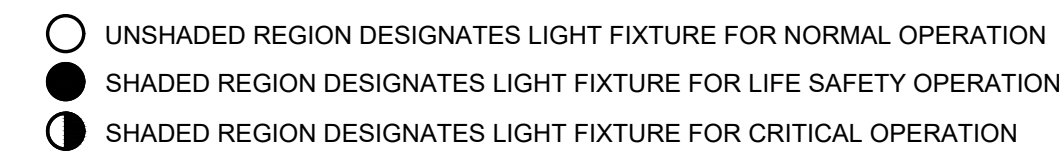

LIGHT FIXTURE ID - SEE LIGHT FIXTURE SCHEDULE

TAG	DESCRIPTION	TAG	DESCRIPTION
D	DOWNLIGHT RECESSED	PL	PENDANT LINEAR
DS	DOWNLIGHT SURFACE	RF	RECESSED FLANGE
EL	ELEVATOR LINEAR	RL	RECESSED LINEAR
H	HALO PENDANT	RP	RECESSED PERIMETER
HW	HEADWALL	RR	RING FIXTURE
L	LINEAR	S	SITE
M	MRI TROFFER	WS	WALL SCONCE
MD	MRI DOWNLIGHT	V	VANITY
NL	NIGHT LIGHT FIXTURE	X	EXIT
OR	OPERATING ROOM		
P	PENDANT		

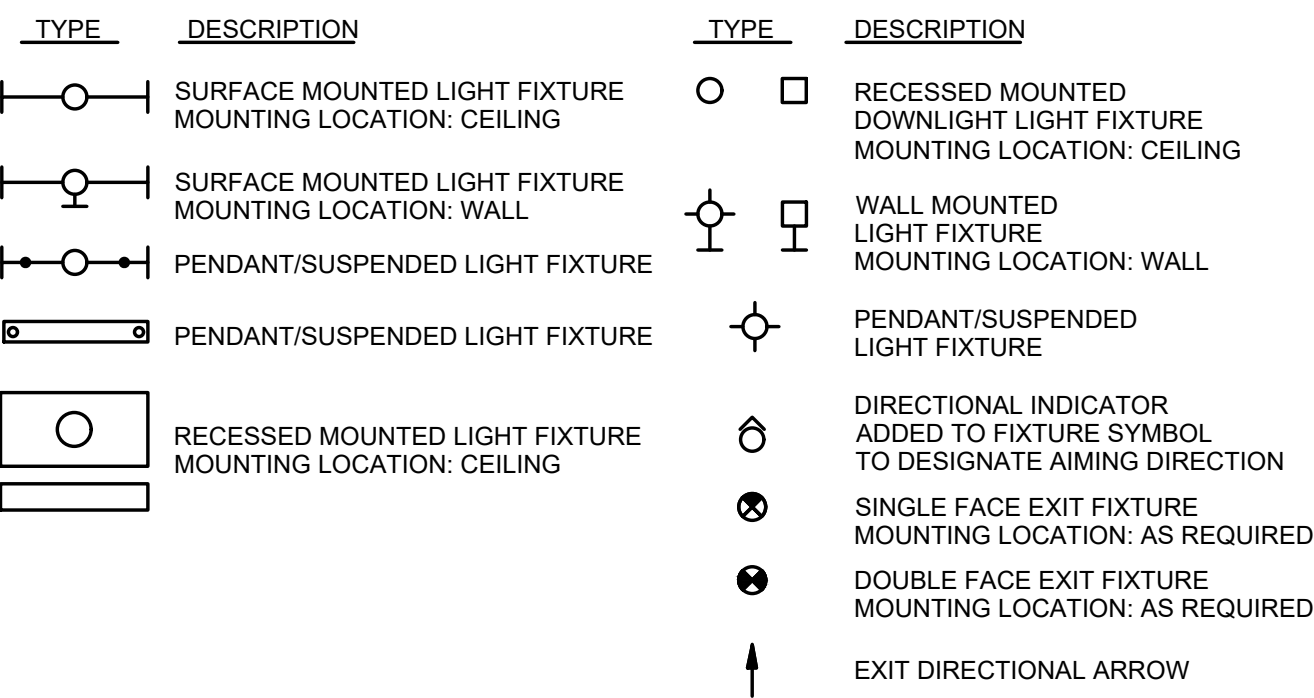

## LIGHTING CONTROL

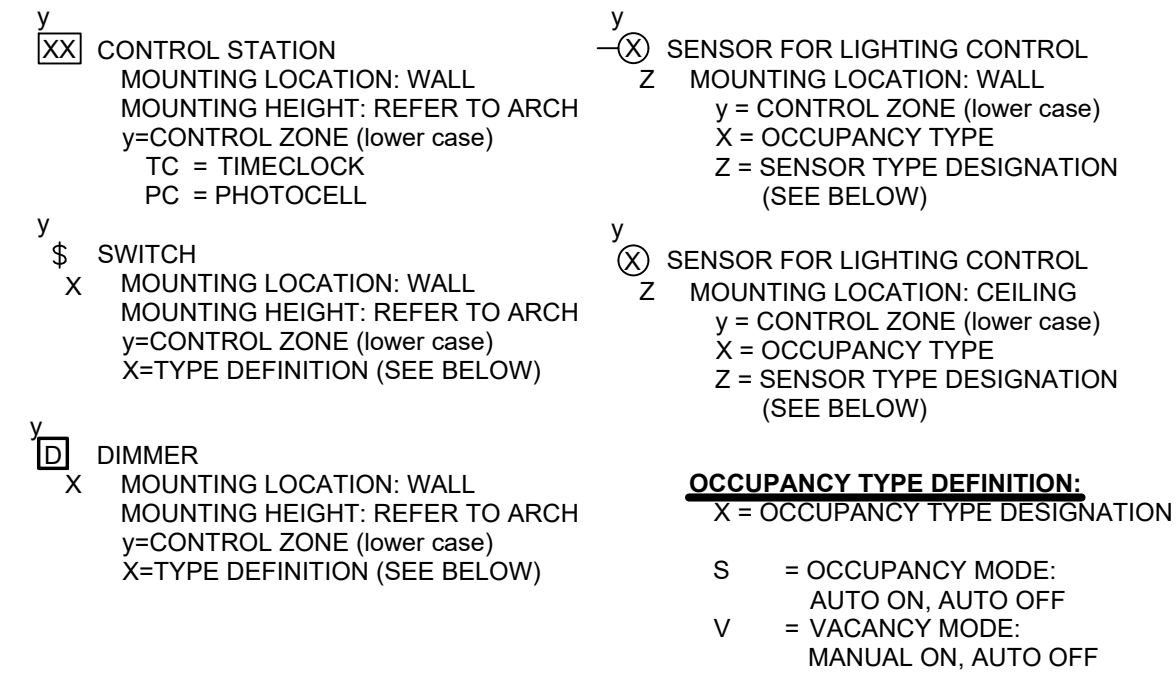

### TYPE DEFINITION:

- X = TYPE DEFINITION
- BLANK = SINGLE POLE
- 3 = THREE-WAY SWITCH
- 4 = FOUR-WAY SWITCH
- K = KEY SWITCH
- P = SWITCH WITH PILOT LIGHT WIRED SUCH THAT THE SWITCH GLOWS WHEN THE POWER IS 'OFF'
- TS = TIMER SWITCH
- LV# = LOW VOLTAGE
- # = SWITCH TYPE

### SENSOR TYPE DEFINITION:

- Z = SENSOR TYPE DESIGNATION
- PIR = PASSIVE INFRARED
- DT = DUAL TECHNOLOGY
- DTD = DUAL TECHNOLOGY DIMMER

## ABBREVIATIONS

A	- AMPERES	GB	- GROUNDING BUSBAR	PA	- PUBLIC ADDRESS
AC	- ABOVE CEILING / ALTERNATING CURRENT	GC	- GENERAL CONTRACTOR	PB	- PULL BOX / PUSHBUTTON
ADO	- AUTOMATIC DOOR OPENER	GEN	- GENERATOR	PC	- PLUMBING CONTRACTOR / PHOTOCELL
AF	- AMPERE FRAME	GFCI	- GROUND FAULT INTERRUPTER	PDU	- POWER DISTRIBUTION UNIT
AFCI	- ARC FAULT CIRCUIT INTERRUPTER	GFI	- GROUND FAULT INTERRUPTER	PF	- POWER FACTOR
AFF	- ABOVE FINISHED FLOOR	GND	- GROUND	PH	- PHASE
AFG	- ABOVE FINISHED GRADE	HOA	- HAND OFF AUTOMATIC	PLBG	- PLUMBING
AIC	- AMP INTERRUPTING CAPACITY	HP	- HORSE POWER	PNL	- PANEL
ALT	- ALTERNATE	HV	- HIGH VOLTAGE	PS	- POWER SUPPLY
ARCH	- ARCHITECTURAL	IMC	- INTERMEDIATE METAL CONDUIT	PT	- POTENTIAL TRANSFORMER
AT	- AMPERE TRIP	INV	- INVERTER	PUE	- PUBLIC UTILITY EASEMENT
ATS	- AUTOMATIC TRANSFER SWITCH	J or JB	- JUNCTION BOX	PWR	- POWER
AUTO	- AUTOMATIC	KEYPAD	- KEYPAD	RECEP	- RECEPTACLE
BFC	- BELOW FINISH CEILING	KV	- KILOVOLT	REL	- RELOCATE
BLDG	- BUILDING	KVA	- KILOVOLT-AMPERES	REQD	- REQUIRED
C	- CONDUIT	KW	- KILOWATTS	RMC	- RIGID METAL CONDUIT
CAM	- CAMERA	KWH	- KILOWATT HOURS	RVAT	- REDUCED VOLTAGE AUTO TRANSFORMER
CB	- CIRCUIT BREAKER	LAN	- LOCAL AREA NETWORK	SCCR	- SHORT CIRCUIT CURRENT RATING
CCTV	- CLOSED CIRCUIT TELEVISION	LED	- LIGHT EMITTING DIODE	SIM	- SIMILAR
CFCI	- CONTRACTOR FURNISHED, CONTRACTOR INSTALLED	LI	- LONG-TIME/INSTANTANEOUS	SPD	- SURGE PROTECTIVE DEVICE
CKT	- CIRCUIT	LSI	- LONG-TIME/SHORT-TIME/INSTANTANEOUS	SPEC	- SPECIFICATION
CLK	- CLOCK	LSIA	- LONG-TIME/SHORT-TIME/INSTANTANEOUS/GROUND ALARM	SRP	- SALT RIVER PROJECT
COMM	- COMMUNICATIONS	LSIG	- LONG-TIME/SHORT-TIME/INSTANTANEOUS/GROUND	SSBJ	- SUPPLY SIDE BONDING JUMPER
CORR	- CORRIDOR	LTS	- LIGHTING	STR	- STARTER
COX	- COX COMMUNICATIONS	LV	- LOW VOLTAGE	SUSE	- SUITABLE FOR USE AS SERVICE ENTRANCE
CSP	- CEILING SERVICE PANEL	MC	- MECHANICAL CONTRACTOR	SW	- SWITCH
CT	- CURRENT TRANSFORMER	MCB	- MAIN CIRCUIT BREAKER	SWBD	- SWITCHBOARD
DC	- DIRECT CURRENT	MCC	- MOTOR CONTROL CENTER	SWGR	- SWITCHGEAR
DET	- DETAIL	MGB	- MAIN GROUNDING BUSBAR	TEL	- TELEPHONE
DISC	- DISCONNECT	MH	- MANHOLE	TGB	- TELECOMMUNICATIONS GROUNDING BUSBAR
DN	- DOWN	MLO	- MAIN LUGS ONLY	TMGB	- TELECOMMUNICATIONS MAIN GROUNDING BUSBAR
DP	- DISTRIBUTION PANEL	MTD	- MOUNTED	TMR	- TIMER
DS	- DISCONNECT SWITCH	MTG	- MOUNTING	TS	- TAMPER SWITCH / TIME SWITCH
EC	- ELECTRICAL CONTRACTOR	MTR	- MOTOR / METER	TV	- TELEVISION
EGC	- EQUIPMENT GROUND CONDUCTOR	MV	- MEDIUM VOLTAGE	TVTC	- TELEVISION TERMINAL CABINET
EGS	- ENGINE GENERATOR SET	NA	- NOT APPLICABLE	TYP	- TYPICAL
ELEC	- ELECTRIC / ELECTRICAL	NAC	- NOTIFICATION APPLIANCE CIRCUIT	UC	- UNDER COUNTER
EMER	- EMERGENCY	NC	- NORMALLY CLOSED	UG	- UNDERGROUND
EMI	- ELECTROMAGNETIC INTERFERENCE	NEC	- NATIONAL ELECTRICAL CODE	UNO	- UNLESS NOTED OTHERWISE
EMT	- ELECTRICAL METALLIC TUBING	NIC	- NOT IN CONTRACT	UPS	- UNINTERRUPTED POWER SUPPLY
EQUIP	- EQUIPMENT	NO	- NORMALLY OPEN	V	- VOLTAGE
EVC	- ELECTRIC VEHICLE CHARGING	NTS	- NOT TO SCALE	VFD	- VARIABLE FREQUENCY DRIVE
EWC	- ELECTRIC WATER COOLER	OC	- ON CENTER	W	- WIRE
FA	- FIRE ALARM	OFCI	- OWNER FURNISHED, CONTRACTOR INSTALLED	W/	- WITH
FACU	- FIRE ALARM CONTROL PANEL	OFI	- OWNER FURNISHED, OWNER INSTALLED	WP	- WEATHERPROOF
FCU	- FAN COIL UNIT	OSC	- OVERHEAD SERVICE CARRIER	WS	- WALL SURFACE
FDR	- FEEDER			WT	- WATER TIGHT
FLA	- FULL LOAD AMPERES			XFMR	- TRANSFORMER
FLEX	- FLEXIBLE				
FLUOR	- FLUORESCENT				
FVNR	- FULL VOLTAGE NON-REVERSING				

## NEC 408.4 CIRCUIT NAMING CONVENTION

- CIRCUIT NAMING WITHIN PANEL SCHEDULES INCLUDED IN THIS SET OF DRAWINGS DESCRIBE ROOM IDENTIFIERS (ROOM NAME AND/OR NUMBERS) AND BASIC LOAD IDENTIFIERS (AND/OR SPECIFIC CONNECTED LOADS) ONLY. CONTRACTOR SHALL ELABORATE ON THE CIRCUIT DESCRIPTIONS AND ABBREVIATIONS AS REQUIRED TO PROVIDE PANELBOARD CIRCUIT DIRECTORIES IN ACCORDANCE WITH NEC 408.4 AS SHOWN BELOW:

- ROOM NUMBER/NAME
- QTY OF RECEPTACLES
- LOCATION WITHIN ROOM (NORTH WALL, EAST WALL, ETC)
- LOAD SERVED (FURNITURE, FLOORBOX, CENTRIFUGE, ETC.)

EXAMPLE: 101A BREAK RM - (3) RECEPTS EAST WALL  
101B WORKROOM - FURNITURE S. WALL



**SITE LUMINAIRE SCHEDULE**

ID	DESCRIPTION	MANUFACTURER	MODEL NO.	LAMP		DRIVER TYPE	DRIVER VOLTAGE	MOUNTING	REMARKS
				TYPE	WATTS				
SA	TYPE 1 AREA LUMINAIRE ON BLACK 20" ROUND, 3000K, 205W, 24087 DELIVERED LUMENS.	VISIONAIRE LIGHTING	LSO-L_T1_25L_3K_PTS	LED	205 W	INTEGRAL	277 V	POLE ARM MOUNT	1
SB	TYPE 4 AREA LUMINAIRE ON BLACK 20" ROUND, 3000K, 205W, 23352 DELIVERED LUMENS.	VISIONAIRE LIGHTING	LSO-L_T4_25L_3K_PTS	LED	205 W	INTEGRAL	277 V	POLE ARM MOUNT	1
SBH	TYPE 4 AREA LUMINAIRE ON BLACK 20" ROUND, 3000K, 205W, 23352 DELIVERED LUMENS. HOUSEHOLD SHIELD INCLUDED.	VISIONAIRE LIGHTING	LSO-L_T4_25L_3K_PTS	LED	205 W	INTEGRAL	277 V	POLE ARM MOUNT	1
SC	TYPE 5SR AREA LUMINAIRE ON BLACK 20" ROUND, 3000K, 205W, 24618 DELIVERED LUMENS.	VISIONAIRE LIGHTING	LSO-L_T5SR_25L_3K_PTS	LED	205 W	INTEGRAL	277 V	POLE ARM MOUNT	1
SD	5" BOLLARD, BLACK, 3000K, 873 DELIVERED LUMENS	LUMENPULSE	BLDB-TM1-120_277-CSL-N07-27K	LED	11 W	INTEGRAL	277 V	PAD	1
WSA	WALL-MOUNTED SCONCE LED, 971 LUMENS, 3000K, MVOLT WITH 0-10V DIMMING, WIDE DISTRIBUTION, MOUNTED AT 10"	LUMENPULSE	BLDN-SD_WM-120_277-HFSL-N10-2	LED	11 W	INTEGRAL	277 V	SURFACE - WALL	1,2

**LIGHT FIXTURE SCHEDULE NOTES:**

1. LIGHT FIXTURE MANUFACTURER/MODEL HAS BEEN SELECTED TO MATCH EXISTING LIGHTING LOCATED ON ADJACENT PARCELS. ALTERNATES WILL NOT BE ACCEPTED.
2. COORDINATE MOUNTING HEIGHT OF PENDANT AND WALL-MOUNTED FIXTURES PRIOR TO ROUGH-IN.

**GENERAL NOTES**

- A. POLE-MOUNTED 277V SITE LIGHT FIXTURES SHALL BE CONNECTED USING 2#10, 1#10G IN 1" CONDUIT.
- B. POLE-MOUNTED LIGHT FIXTURES SHALL BE MOUNTED AT 20'-0" FG TO BOTTOM OF FIXTURE UNLESS NOTED OTHERWISE.
- C. SITE LIGHTING SHALL BE CONTROLLED VIA PHOTOCELL.
- D. WALL-MOUNTED LIGHT FIXTURES TO BE MOUNTED AT 9'-0" UNLESS NOTED OTHERWISE.

JOHN WAYNE PARKWAY (SR 347)

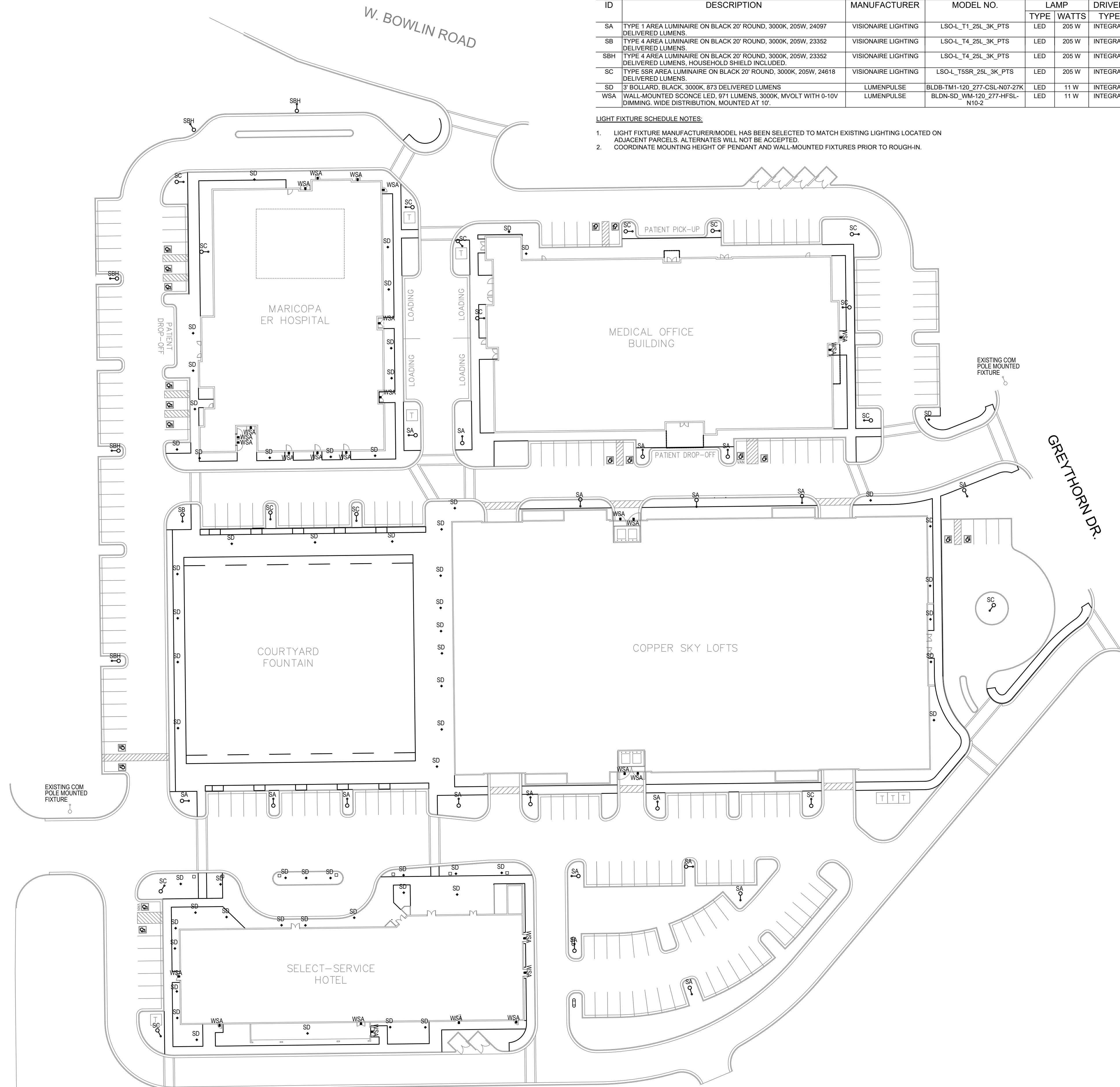

**Electrical Site Plan**

1"=40'-0"



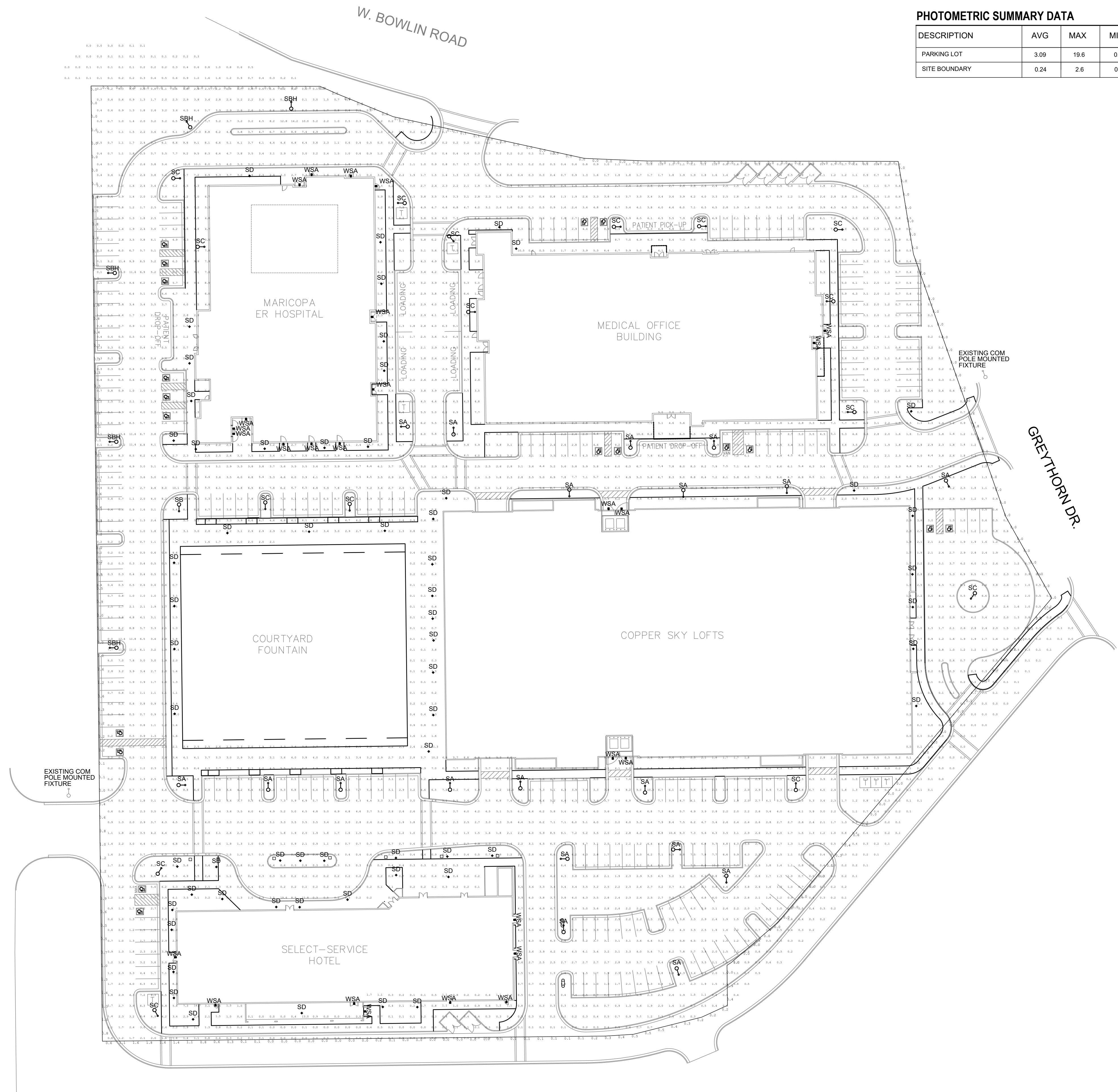

**PHOTOMETRIC SUMMARY DATA**

DESCRIPTION	AVG	MAX	MIN	MAX/MIN	AVG/MIN
PARKING LOT	3.09	19.6	0.0	39.2	6.18
SITE BOUNDARY	0.24	2.6	0.0	5.2	0.48

JOHN WAYNE PARKWAY (SR 347)

GREYTHORN DR.

EXISTING COM POLE MOUNTED FIXTURE

EXISTING COM POLE MOUNTED FIXTURE



# Site Photometric Plan

1"=40'-0"

