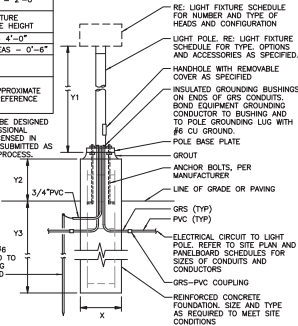

TABLE OF DIMENSIONS

- X POLE HEIGHT > 16' = 2'-0"
- Y1 REFER TO LIGHT FIXTURE SCHEDULE FOR POLE HEIGHT
- Y2 NON-VEHICULAR AREAS = 4'-0"
- Y3 PER STRUCTURAL

* NOTE: ALL DIMENSIONS ARE APPROXIMATE AND ARE SHOWN FOR REFERENCE ONLY.

POLE FOUNDATION SHALL BE DESIGNED AND SEALED BY A PROFESSIONAL STRUCTURAL ENGINEER LICENSED IN THE PROJECT STATE AND SUBMITTED AS PART OF THE SUBMITTAL PROCESS.



1 POLE BASE DETAIL
NO SCALE

EXTERIOR LIGHT FIXTURE SCHEDULE

TYPE	MANUFACTURER/MODEL #	LAMPS		INPUT		DESCRIPTION	
		NO.	WATTS	VOLTS	VA		
S1A	HESS AMERICA - LINEAR800 LED #UN80-4LV-W-ME-LUN-A-26SR-COLOR-N MOUNTING - SINGLE	4	LED LIGHT BAR WITH 14 LED'S PER BAR 3000K MINIMUM 70 CRI	MVOLT	104	106	NOMINAL 54" LONG SLIM, LOW PROFILE CAST ALUMINUM SITE LIGHT FIXTURE. FIXTURE SHALL BE PROVIDED WITH 26" STEEL RECTANGULAR POLE GRADE MOUNTED. DRIVER SHALL BE A MULTI VOLT ELECTRONIC DRIVER, 500mA DRIVE CURRENT WITH GREATER THAN A 90% POWER FACTOR AND GREATER THAN 20K THD. FIXTURE SHALL BE PROVIDED WITH INTEGRAL 10KV SURGE SUPPRESSION PROTECTION STANDARD. ELECTRICAL CONNECTION HOUSING SHALL BE INTEGRAL TO FIXTURE, WEATHER TIGHT AND EASILY ACCESSIBLE FOR QUICK CONNECTION. FIXTURE SHALL BE UL LISTED FOR WET LOCATIONS. VERIFY FINISH WITH ARCHITECT. FIXTURE SHALL BE MOUNTED AS A SINGLE FIXTURE. PROVIDE ALL NECESSARY MOUNTING BRACKETS AS REQUIRED FOR A COMPLETE INSTALLATION.
S1B	HESS AMERICA - LINEAR800 LED #UN80-4LV-W-ME-LUN-A-26SR-COLOR-N MOUNTING - SINGLE	4	LED LIGHT BAR WITH 14 LED'S PER BAR 3000K MINIMUM 70 CRI	MVOLT	104	106	NOMINAL 54" LONG SLIM, LOW PROFILE CAST ALUMINUM SITE LIGHT FIXTURE. FIXTURE SHALL BE PROVIDED WITH 26" STEEL RECTANGULAR POLE ON A 4"-0" CONCRETE BASE. DRIVER SHALL BE A MULTI VOLT ELECTRONIC DRIVER, 500mA DRIVE CURRENT WITH GREATER THAN A 90% POWER FACTOR AND GREATER THAN 20K THD. FIXTURE SHALL BE PROVIDED WITH INTEGRAL 10KV SURGE SUPPRESSION PROTECTION STANDARD. ELECTRICAL CONNECTION HOUSING SHALL BE INTEGRAL TO FIXTURE, WEATHER TIGHT AND EASILY ACCESSIBLE FOR QUICK CONNECTION. FIXTURE SHALL BE UL LISTED FOR WET LOCATIONS. VERIFY FINISH WITH ARCHITECT. FIXTURE SHALL BE MOUNTED AS A SINGLE FIXTURE. PROVIDE ALL NECESSARY MOUNTING BRACKETS AS REQUIRED FOR A COMPLETE INSTALLATION.
S2	HESS AMERICA - LINEAR800 LED #UN80-4LV-W-ME-LUN-B-26SR-COLOR-N MOUNTING - SINGLE	4	LED LIGHT BAR WITH 14 LED'S PER BAR 3000K MINIMUM 70 CRI	MVOLT	208	212	NOMINAL 110" LONG SLIM, LOW PROFILE CAST ALUMINUM DOUBLE SITE LIGHT FIXTURE. FIXTURE SHALL BE PROVIDED WITH 26" STEEL RECTANGULAR POLE ON A 4"-0" CONCRETE BASE. DRIVER SHALL BE A MULTI VOLT ELECTRONIC DRIVER, 500mA DRIVE CURRENT WITH GREATER THAN A 90% POWER FACTOR AND GREATER THAN 20K THD. FIXTURE SHALL BE PROVIDED WITH INTEGRAL 10KV SURGE SUPPRESSION PROTECTION STANDARD. ELECTRICAL CONNECTION HOUSING SHALL BE INTEGRAL TO FIXTURE, WEATHER TIGHT AND EASILY ACCESSIBLE FOR QUICK CONNECTION. FIXTURE SHALL BE UL LISTED FOR WET LOCATIONS. VERIFY FINISH WITH ARCHITECT. FIXTURE SHALL BE MOUNTED AS A SINGLE FIXTURE. PROVIDE ALL NECESSARY MOUNTING BRACKETS AS REQUIRED FOR A COMPLETE INSTALLATION.
S3	HESS AMERICA - LINEAR800 LED #UN450-2LV-W-ME-LUN-A-15SR-COLOR-N MOUNTING - SINGLE	2	LED LIGHT BAR WITH 14 LED'S PER BAR 3000K MINIMUM 70 CRI	MVOLT	52	54	NOMINAL 54" LONG SLIM, LOW PROFILE CAST ALUMINUM SITE LIGHT FIXTURE. FIXTURE SHALL BE PROVIDED WITH 15" STEEL RECTANGULAR POLE DRIVER SHALL BE A MULTI VOLT ELECTRONIC DRIVER, 500mA DRIVE CURRENT WITH GREATER THAN A 90% POWER FACTOR AND GREATER THAN 20K THD. FIXTURE SHALL BE PROVIDED WITH INTEGRAL 10KV SURGE SUPPRESSION PROTECTION STANDARD. ELECTRICAL CONNECTION HOUSING SHALL BE INTEGRAL TO FIXTURE, WEATHER TIGHT AND EASILY ACCESSIBLE FOR QUICK CONNECTION. FIXTURE SHALL BE UL LISTED FOR WET LOCATIONS. VERIFY FINISH WITH ARCHITECT. FIXTURE SHALL BE MOUNTED AS A SINGLE FIXTURE. PROVIDE ALL NECESSARY MOUNTING BRACKETS AS REQUIRED FOR A COMPLETE INSTALLATION.
S4A	INTENSE LIGHTING - VRAL #NR2-RPS-COLOR-E42-10-30-30AS	1	CLOSELY PACKED LED ARRAY 3000K MINIMUM 85 CRI 241 INITIAL LUMENS PER LINEAR FOOT	277	4.2(w/10)	97	NOMINAL 2' OUTSIDE DIAMETER LED LT HANDRAIL SYSTEM. RAIL SYSTEM SHALL BE IMBEDDED IN CONCRETE STAIRWAY AND COMPLY WITH ALL ADA REQUIREMENTS AND HEIGHTS. PROVIDE WITH 3000K LED LIGHTING SYSTEM WITH 30 DEGREE ASYMMETRIC BEAM MOUNTED 50 DEGREE BEAM ANGLE IS TOWARD STAIRWAY WALKING SURFACE. PROVIDE REMOTE MOUNTED LED DRIVER/24V LOW VOLTAGE TRANSFORMER. VERIFY WITH ELECTRICAL PLANS FOR EXACT LOCATION, FIXTURE AND ASSEMBLY SHALL BE UL LISTED FOR WET LOCATIONS.
S4B	INTENSE LIGHTING - VRAL #NR2-RPS-COLOR-E42-10-30-60S	1	CLOSELY PACKED LED ARRAY 3000K MINIMUM 85 CRI 241 INITIAL LUMENS PER LINEAR FOOT	277	4.2(w/10)	97	NOMINAL 2' OUTSIDE DIAMETER LED LT HANDRAIL SYSTEM. RAIL SYSTEM SHALL BE IMBEDDED IN CONCRETE STAIRWAY AND COMPLY WITH ALL ADA REQUIREMENTS AND HEIGHTS. PROVIDE WITH 3000K LED LIGHTING SYSTEM WITH 60 DEGREE SYMMETRIC BEAM MOUNTED 50 DEGREE BEAM ANGLE IS TOWARD STAIRWAY WALKING SURFACE. PROVIDE REMOTE MOUNTED LED DRIVER/24V LOW VOLTAGE TRANSFORMER. VERIFY WITH ELECTRICAL PLANS FOR EXACT LOCATION, FIXTURE AND ASSEMBLY SHALL BE UL LISTED FOR WET LOCATIONS.
S5	BEGA-US LIGHTING #B302LED (ADA)	1	LED LIGHT BAR(S) 3000K MINIMUM 85 CRI 241 INITIAL LUMENS	277	4	5	NOMINAL 15" X 1.5" IN GRADE LED MARKER UPLIGHT. FIXTURE HOUSING SHALL BE DIE-CAST ALUMINUM WITH .250" THICK TEMPERED GLASS LENS WITH INTERNAL WHITE TRANSLUCENT CERAMIC COATING. LENS SHALL BE MACHINE FINISHED TO BE FLUSH WITH TRIM. FIXTURE SHALL BE PROVIDED WITH REMOTE MOUNTED 24V DC LED DRIVER LISTED AS COMPATIBLE TO DRIVE THE BEGA LED BOARD. LED'S SHALL BE 3000K COLOR TEMPERATURE. FIXTURE SHALL BE PROVIDED WITH (1) 10K THD ELECTRONIC BALLAST. COORDINATE FINISH WITH ARCHITECT PRIOR TO ORDERING.
S6	PRUDENTIAL LIGHTING #P61-1T5-04-PCL-TMW-D1-SC-277-SUR-10THD	1	F28W/15/835/ECO 3500K MINIMUM 85 CRI	277	34	34	NOMINAL 4'X6'X6" IP65 RATED WET LOCATION LUMINAIRE. FIXTURE SHALL HAVE DIE-FORMED 18-GAUGE ALUMINUM HOUSING WITH ONE-PIECE EXTRUDED GASKETED DOOR FRAME. FIXTURE SHALL BE PROVIDED WITH (1) 10K THD ELECTRONIC BALLAST. COORDINATE FINISH WITH ARCHITECT PRIOR TO ORDERING.

GENERAL NOTES:
A. ANY PROPRIETARY, SOLE-SOURCED LIGHT FIXTURE LISTED IN THE LIGHT FIXTURE SCHEDULE SHALL BE UNIT PRICED ONLY. NO PACKAGING OR LOT PRICING OF THESE LIGHT FIXTURES SHALL BE ALLOWED. UNIT PRICES SHALL BE CLEARLY IDENTIFIED ON THE BID FORM.
B. REPRESENTATIVE AGENTS SHALL BE ALLOWED TO OFFER MINI-LOT PRICING (MLP) FOR LIGHT FIXTURES SPECIFIED IN 265100 AND 265600 ONLY. REFER TO SPECIFICATION 265100 FOR DEFINITION, TERMS AND LIMITATIONS OF MLP.
C. PACKAGING OF LIGHT FIXTURES WILL NOT BE CONSIDERED OR APPROVED.
D. LIGHTING CONTROLS PRICING, INCLUDING BUT NOT LIMITED TO THOSE REFERENCED IN 260923 AND 262726, SHALL BE COMPLETELY SEPARATE OF ANY LIGHT FIXTURE PRICING. ANY LIGHTING CONTROLS PRICING THAT IS SUBMITTED WITH LIGHT FIXTURE PRICING (UNIT OR MINI-LOT) WILL BE IMMEDIATELY REJECTED IN ITS ENTIRETY.
E. VERIFY MOUNTING CONDITIONS AND COORDINATE LIGHT FIXTURE MOUNTING HARDWARE AND TRIMS NEEDED TO SUIT CONDITIONS PRIOR TO ORDERING.
F. VERIFY QUANTITIES, MODEL NUMBERS AND DESCRIPTIONS WITH MANUFACTURER PRIOR TO PLACING ORDER.
G. VERIFY FINISH AND DRAWINGS WITH ARCHITECT PRIOR TO PLACING ORDER.
H. REFER TO ARCHITECTURAL DRAWINGS AND DETAILS FOR EXACT LOCATIONS, MOUNTING HEIGHTS AND ADDITIONAL MOUNTING INFORMATION. CONTACT ARCHITECT IMMEDIATELY IF THERE ARE DISCREPANCIES BETWEEN THE ARCHITECTURAL AND ELECTRICAL LIGHTING PLANS.
I. CATALOG NUMBERS SHALL NOT BE CONSIDERED COMPLETE AND MATERIAL SHALL NOT BE ORDERED BY MANUFACTURER AND CATALOG NUMBERS ONLY. FIRST READ THE COMPLETE DESCRIPTION, NOTES AND SPECIFICATIONS IN CONJUNCTION WITH THE CATALOG NUMBER TO DETERMINE THE EXACT MATERIAL AND ACCESSORIES TO BE ORDERED. THE MANUFACTURES LISTED ARE THE BASIS FOR THE DESIGN.
J. CONTRACTOR SHALL PROVIDE ALL LIGHT FIXTURES UNLESS NOTED OTHERWISE.

FIXTURE NOTES:
1. CATALOG NUMBER REPRESENTS MANUFACTURER LISTED FIRST. OTHER MANUFACTURERS LISTED ARE CONSIDERED EQUIVALENT FOR SUBSTITUTION.
2. DUE TO AESTHETIC OR PERFORMANCE CRITERIA, SPECIFIED MANUFACTURER SHALL BE THE ONLY MANUFACTURER ALLOWED TO BID UNLESS OTHERWISE APPROVED BY ARCHITECT.
3. CONTRACTOR SHALL SUPPLY A COMPLETE AND OPERATIONAL SYSTEM TO COMPLY WITH DESIGN INTENT.
4. CONFIRM FINAL FIXTURE LENGTHS WITH FIELD-CONFIRMED CONDITIONS PRIOR TO ORDERING.
5. REFER TO POLE BASE DETAILS FOR ADDITIONAL INFORMATION.
6. DUE TO AESTHETIC OR PERFORMANCE CRITERIA, SPECIFIED FIXTURE OR LAMP MANUFACTURER SHALL BE THE ONLY MANUFACTURER ALLOWED TO BID UNLESS OTHERWISE STATED BY OWNER OR ARCHITECT. FAILURE TO COMPLY WITH SPECIFICATION SHALL HOLD CONTRACTOR FINANCIALLY RESPONSIBLE FOR PROVIDING SPECIFIED FIXTURE.
7. PROVIDE MANUFACTURER'S REMOTE 100VA, 300VA, OR 500VA 120V/12V WET LOCATION MAGNETIC TRANSFORMER AS INDICATED. LOCATE TRANSFORMER SO AS TO REDUCE VOLTAGE DROP TO LOW VOLTAGE FIXTURES. WHERE VERTICAL MOUNTING OF TRANSFORMER WITHIN PLANTING BED IS ACCEPTABLE, PROVIDE VERTICAL UNISTRUT FOR MOUNTING TRANSFORMER.
8. CONTRACTOR SHALL PROVIDE JUNCTION BOX END FEEDS FOR 12 VOLT OR 24 VOLT SYSTEM OPERATING AT 25 AMPS OR A TOTAL OF 300 WATTS OR 600 WATTS PER FEED. CONTRACTOR SHALL LOCATE END FEED JUNCTION BOXES AT ENDS OF RUN, WHERE APPROPRIATE AND RUN LOW VOLTAGE LINEAR SYSTEM IN OPPOSITE DIRECTION.
9. CONTRACTOR SHALL REFERENCE INTERIOR DESIGNER'S FIXTURE SPECIFICATIONS FOR EXACT FIXTURE AND COST INFORMATION.
10. MANUFACTURER SHALL FURNISH TO SITE A COMPLETE AND OPERATIONAL SYSTEM TO COMPLY WITH DESIGN INTENT. MANUFACTURER SHALL REFER TO CATALOG INFORMATION AND DESCRIPTION FOR DESIGN INTENT. MANUFACTURER SHALL BE RESPONSIBLE FOR VERIFYING CATALOG NUMBER FOR COMPLETENESS, FURNISHING ALL PERTINENT EQUIPMENT, AND COORDINATING WITH CONTRACTOR REGARDING CONTRACTOR'S RESPONSIBILITIES PRIOR TO ORDERING.
11. MANUFACTURER SHALL FURNISH TO OWNER AND ARCHITECT AT THEIR REQUEST, A SAMPLE SWITCH OF SPECIFIED FIXTURE FINISH PRIOR TO SHOP DRAWING SUBMITTAL. CONTRACTOR SHALL VERIFY FINISH AND COLOR OF EXTERIOR FIXTURE SURFACES WITH ARCHITECT PRIOR TO ORDERING. FOR FIXTURES DESIGNATED WITH COLOR, CONTRACTOR AND MANUFACTURER SHALL COORDINATE WITH ARCHITECT AND/OR OWNER/ DEVELOPER REGARDING COMPLIANCE WITH REQUIRED COLOR SELECTION. CONTRACTOR SHALL BE HELD FINANCIALLY RESPONSIBLE FOR PROVING APPROVED COLOR PALETTE.
12. CONTRACTOR SHALL LOCATE GROUND RECESSED FIXTURES IN LOCATIONS AS DETERMINED IN FIELD BY STAKES MARKED BY ENGINEER/ LIGHTING DESIGNER. LOCATIONS INDICATED ON PLAN ARE FOR REFERENCE ONLY. CONTRACTOR SHALL NOT INSTALL WITHOUT FINAL ARCHITECTURAL DETAILS. HIDE WIRING AS MUCH AS POSSIBLE.
13. PLAZA OR GROUND RECESSED UP LIGHT FIXTURES SHALL BE LOCATED AS PER ARCHITECTURAL AND/OR LANDSCAPE DOCUMENTS AND CENTERLINE OF FIXTURE'S APERTURE SPACING AS NOTED FROM BUILDING OR CENTERLINE OF TREE. CONTRACTOR SHALL VERIFY EXISTING SOIL CONDITIONS, NEW OR EXISTING FOUNDATIONS OR BELOW GRADE OBSTRUCTIONS AND POWER PRIOR TO ORDERING.
14. FIXTURE FAILING TO COMPLY WITH PHYSICAL LIMITATIONS BASED ON SITE CONDITIONS, ARCHITECTURAL DETAILS, OR STRUCTURAL CONDITIONS SHALL BE REMOVED FROM BID. CONTRACTOR SHALL PROVIDE A CONCRETE POUR BASE AROUND FIXTURE TO STABILIZE AND PROVIDE SECURITY WHERE LOCATED AND DESIGNATED IN LANDSCAPE AREAS. MANUFACTURER SHALL FURNISH INSTALLATION SLEEVE FOR CONCRETE POUR APPLICATIONS TO INSURE FIXTURE'S FACEPLATE IS FLUSH WITH FINISHED PLAZA SURFACE. MANUFACTURER SHALL SUPPLY CONTRACTOR WITH INSTALLATION SLEEVE IMMEDIATELY SO AS NOT TO PROLONG CONSTRUCTION SCHEDULE. MANUFACTURER SHALL FURNISH FIXTURES WITH FACEPLATE WITH FINISH SPECIFICATION AND COORDINATED WITH SITE CONDITIONS. CONTRACTOR SHALL NOT INSTALL DIRECT BURIAL FIXTURES DURING RAIN OR HIGH-HUMID DAYS. CONTRACTOR SHALL BE RESPONSIBLE FOR INSURING THAT CONDUIT CONTAINS NO MOISTURE PRIOR TO CONNECTING TO FIXTURES ANTI-WICKING, SIPHONING CHAMBER SO AS TO PREVENT CONDENSATION ON INSIDE OF LENS. CONTRACTOR SHALL BE RESPONSIBLE FOR COMPLYING WITH MANUFACTURER'S RECOMMENDATIONS TO AVOID CONDENSATION PRIOR TO COMPLETION OF PROJECT.
14. PROVIDE COMPACT FILL AROUND MOUNTING STAKE FOR SURFACE BOLLARD/ LANDSCAPE FIXTURE. CONCRETE FILL IS NOT ACCEPTABLE. INSTALL CONDUIT UP INSIDE MANUFACTURER'S STAKE AS PER INSTALLATION INSTRUCTIONS.
15. PROVIDE 2'-0" TALL ABOVE GRADE CONCRETE BASE WITH DIAMETER SIZED AS PER STRUCTURAL ENGINEER'S DOCUMENTS. POLE MANUFACTURER SHALL PROVIDE ANCHOR BOLT TEMPLATE TO CONTRACTOR AT CONTRACTOR'S SOLE REQUEST FOR BOLLARD HOLES.
16. CONTRACTOR SHALL PROVIDE FIXTURES WITH A FLUSH WITH GRADE CONCRETE BASE WITH DIAMETER SIZED AS PER STRUCTURAL ENGINEER'S DOCUMENTS. POLE MANUFACTURER SHALL PROVIDE ANCHOR BOLT TEMPLATE TO CONTRACTOR AT CONTRACTOR'S SOLE REQUEST FOR BOLLARD HOLES.
17. MANUFACTURER SHALL FURNISH FIXTURE WITH 1/2" NPT THREADED CONNECTION FOR MOUNTING DIRECTLY TO MANUFACTURER FURNISHED 12" DEEP STAKE. SAID STAKE SHALL BE SUITABLE FOR 12V LOW VOLTAGE WIRING ONLY. CONTRACTOR SHALL PROVIDE AND ENCASE IN PVC CONDUIT #10AWG 2-WIRE CABLE FROM FIXTURE'S STAKE TO TRANSFORMER. MANUFACTURER SHALL FURNISH ONE (1) STAKE W/ 150VA TRANSFORMER WITHIN STAKE TO FEED WIRING TO CONTRACTOR SHALL REFER TO MANUFACTURER'S INSTALLATION INSTRUCTIONS FOR CONNECTION FROM TRANSFORMER STAKE TO EACH FIXTURE. CONTRACTOR SHALL NOT DASH-CHAIN LOW VOLTAGE WIRE FROM FIXTURE, BUT SHALL SPIDER-OUT FROM TRANSFORMER ONLY.
18. MANUFACTURER SHALL FURNISH FIXTURE WITH LOW VOLTAGE SURFACE/TREE MOUNT CANOPY TO ACCEPT 2-#10AWG WIRES FROM REMOTE TRANSFORMER. MOUNT CANOPY TO SIDE OF STRUCTURE AS INDICATED IN PLAN AS PER ARCHITECTURAL DETAILS. HIDE WIRING AS MUCH AS POSSIBLE. CLEAN AND NEAT MANNER, AND SECURE CANOPY TO CANOPY AND THEN SECURE CANOPY TO STRUCTURE AS PER MANUFACTURER'S INSTRUCTIONS.
19. REFER TO ARCHITECTURAL ELEVATIONS FOR EXACT MOUNTING HEIGHTS AND REQUIREMENTS WITHIN NON-COMBUSTIBLE CONCRETE OR MASONRY WALLS. MANUFACTURER SHALL PROVIDE TO CONTRACTOR REQUIRED RECESSED CONCRETE HOUSING / JUNCTION BOX FOR BOLLARD HOLES. TOP OF CONCRETE BASE SHALL NOT PROTRUDE MORE THAN 4" ABOVE GRADE. CONTRACTOR SHALL PROVIDE RECESSED HOUSING AND INSTALL RECESSED SURFACE MOUNTED FIXTURE AND INTERNAL WIRING TO RECESSED HOUSING UPON COMPLETION OF WALL. ANY FIXTURES NOT SPECIFICALLY INDICATED ON ARCHITECTURAL ELEVATIONS SHALL BE CONFIRMED WITH ARCHITECT OR INTERIOR DESIGNER PRIOR TO INSTALLATION. FAILURE TO CONSULT WITH ARCHITECT OR INTERIOR DESIGNER SHALL HOLD CONTRACTOR FINANCIALLY RESPONSIBLE FOR CORRECTING ERROR.
20. EXACT FIXTURE LOCATION TO BE VERIFIED WITH FIELD CONDITIONS AND COORDINATED WITH OWNER AND LIGHTING DESIGNER PRIOR TO ORDERING.
21. FIXTURE SHALL BE APPROVED AND STAMPED FOR WET LOCATION. FOR ALL UP LIGHT SERIES, MANUFACTURER SHALL PROVIDE WRITTEN GUARANTEE AND COMPLIANCE WITH U.L. TESTING FOR UP LIGHT CONDITIONS TO THE CONTRACTOR. FIXTURES SHALL BE SPECIFICALLY TESTED SO AS TO NOT ALLOW WATER INTO LAMP COMPARTMENT WHEN AIMED UP. FAILURE TO PROVIDE TESTING AND U.L. APPROVAL SHALL REMOVE MANUFACTURER FROM BID.
22. CONTRACTOR SHALL BE RESPONSIBLE FOR FINAL MARKETING OF LIGHT FIXTURES AND ACCORDING TO THE DISCRETION AND ACCORDING TO THE REQUIREMENTS OF THE LIGHTING DESIGNER. AMONG SHALL TAKE PLACE AFTER DARK, AT A MUTUALLY AGREED-UPON TIME. ALL COSTS ASSOCIATED WITH THIS EFFORT SHALL BE INCLUDED IN THE BASE BID.

ELECTRONIC COPY OF FINAL DOCUMENT, SEALED ORIGINAL DOCUMENT IS WITH HENDERSON ENGINEERS, 610 W. MOTTAFORD, REGISTRATION # 39542



Gensler

201 E Washington Street
Suite 750
Phoenix AZ 85018
Tel: 602.523.4900
Fax: 602.523.4949

Date	Issue Description	By	Check
01.10.2012	Site Plan Review	KJH	OM
02.17.2012	City Comments	KJH	OM



Project Name
CITY HALL COMPLEX, CITY OF MARICOPA

Project Number
57,6205,000

Description
EXTERIOR LIGHT FIXTURE SCHEDULE & DETAILS

Scale
AS NOTED



ES03.00

Project Name MARICOPA CITY HALL

Address City State ZIP

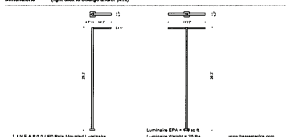
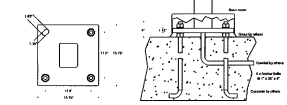

Table with columns: Type, Model, Module, Color, Temperature, Distribution, Volt, Mounting Pole, Finish, Option.

Ordering Information LAMB = ALV - W - ME - UVW - B - 2BR - N -

Project Name MARICOPA CITY HALL

Address City State ZIP



Specifications are subject to change without notification.

USAmerica P.O. Box 39, Dallas, TX 75241, Phone: 847-441-3332, Fax: 847-441-3782, www.usaamericaspecobets.com

Project Name MARICOPA CITY HALL

Address City State ZIP

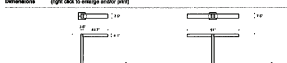

Specifications are subject to change without notification.

USAmerica P.O. Box 39, Dallas, TX 75241, Phone: 847-441-3332, Fax: 847-441-3782, www.usaamericaspecobets.com

Project Name MARICOPA CITY HALL

Address City State ZIP

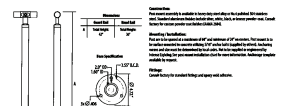

Specifications are subject to change without notification.

USAmerica P.O. Box 39, Dallas, TX 75241, Phone: 847-441-3332, Fax: 847-441-3782, www.usaamericaspecobets.com

Project Name MARICOPA CITY HALL

Address City State ZIP



Specifications are subject to change without notification.

USAmerica P.O. Box 39, Dallas, TX 75241, Phone: 847-441-3332, Fax: 847-441-3782, www.usaamericaspecobets.com

Project Name MARICOPA CITY HALL

Address City State ZIP



Specifications are subject to change without notification.

USAmerica P.O. Box 39, Dallas, TX 75241, Phone: 847-441-3332, Fax: 847-441-3782, www.usaamericaspecobets.com

Project Name MARICOPA CITY HALL

Address City State ZIP



Specifications are subject to change without notification.

USAmerica P.O. Box 39, Dallas, TX 75241, Phone: 847-441-3332, Fax: 847-441-3782, www.usaamericaspecobets.com

Project Name MARICOPA CITY HALL

Address City State ZIP

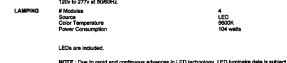

Specifications are subject to change without notification.

USAmerica P.O. Box 39, Dallas, TX 75241, Phone: 847-441-3332, Fax: 847-441-3782, www.usaamericaspecobets.com

Project Name MARICOPA CITY HALL

Address City State ZIP

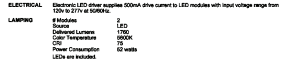

Specifications are subject to change without notification.

USAmerica P.O. Box 39, Dallas, TX 75241, Phone: 847-441-3332, Fax: 847-441-3782, www.usaamericaspecobets.com

Project Name MARICOPA CITY HALL

Address City State ZIP

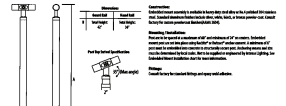

Specifications are subject to change without notification.

USAmerica P.O. Box 39, Dallas, TX 75241, Phone: 847-441-3332, Fax: 847-441-3782, www.usaamericaspecobets.com

Project Name MARICOPA CITY HALL

Address City State ZIP

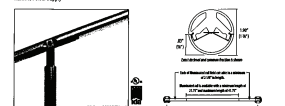

Specifications are subject to change without notification.

USAmerica P.O. Box 39, Dallas, TX 75241, Phone: 847-441-3332, Fax: 847-441-3782, www.usaamericaspecobets.com

Project Name MARICOPA CITY HALL

Address City State ZIP

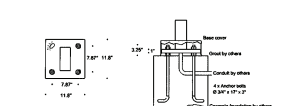

Specifications are subject to change without notification.

USAmerica P.O. Box 39, Dallas, TX 75241, Phone: 847-441-3332, Fax: 847-441-3782, www.usaamericaspecobets.com



Gensler 201 E Washington Street Suite 750 Phoenix AZ 85018 Tel: 602.523.4949 Fax: 602.523.4949

Table with columns: Date, Issue Description, By, Check. Includes entries for 01.10.2012 and 02.17.2012.

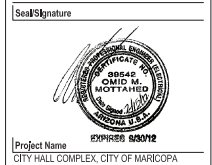

Project Name CITY HALL COMPLEX, CITY OF MARICOPA Project Number 57,6205,000 Description LIGHT FIXTURE CUT SHEETS Scale AS NOTED

ES04.01 © 2011 Gensler

GM.D. M. NOTIFIED



CITY OF MARICOPA
CITY HALL COMPLEX

Gensler

201 E Washington Street
Suite 750
Phoenix AZ 85018
Tel: 602.523.4900
Fax: 602.523.4949

Date	Issue Description	By	Check
01.10.2012	Site Plan Review	KJH	OM
02.17.2012	City Comments	KJH	OM
03.06.2012	City Comments	KJH	OM

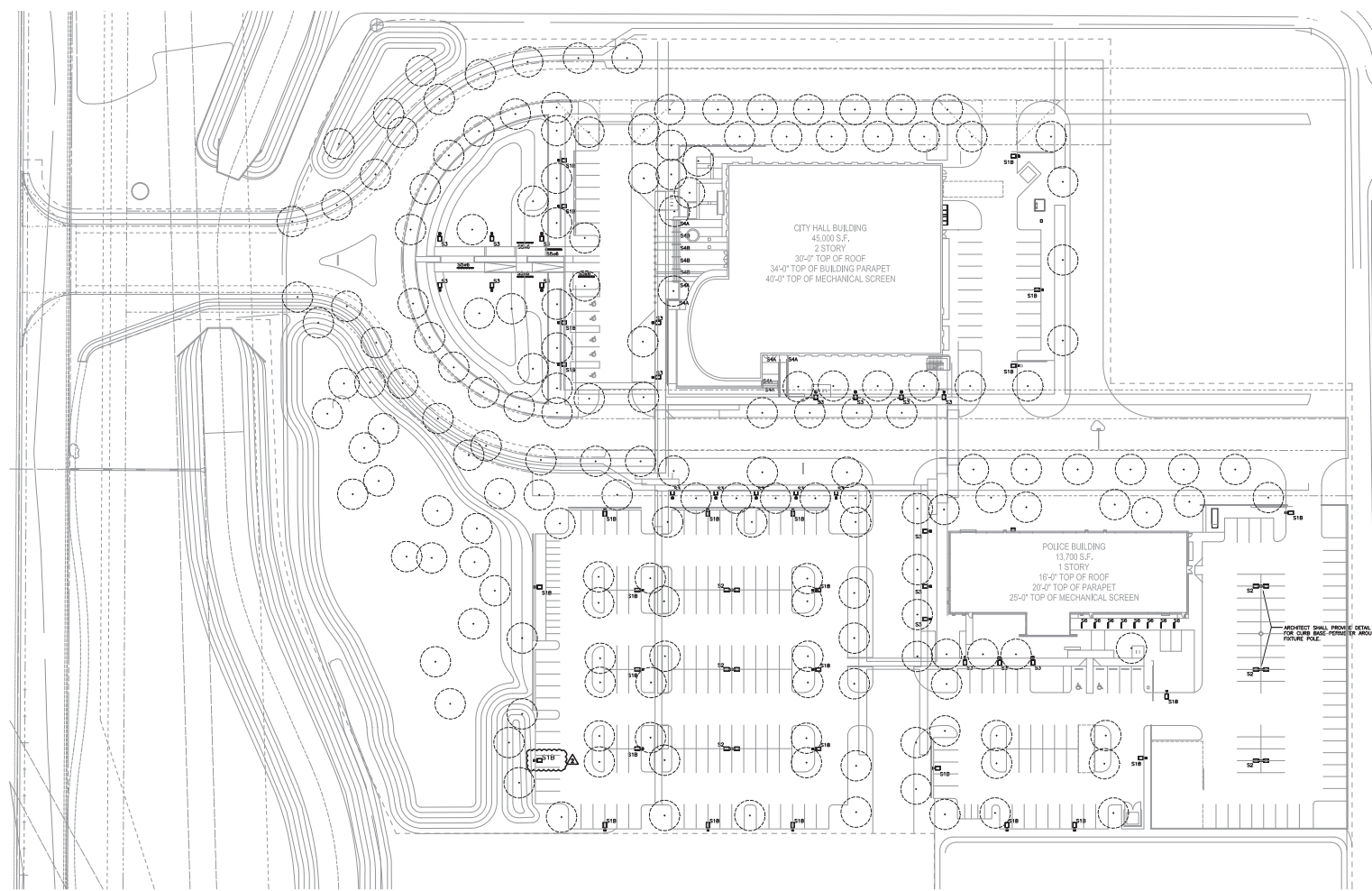

1 ON-SITE LIGHTING SITE PLAN
SCALE: 1"=30'-0"

ARCHITECT SHALL PROVIDE DETAIL FOR CURB AND PAVEMENT WIDTHS AND FIGURE POLE.

Seal/Signature



Project Name
CITY HALL COMPLEX, CITY OF MARICOPA

Project Number
57,6205,000

Description
ON-SITE LIGHTING PLAN

Scale
AS NOTED

ES01.01

© 2011 Gensler



ELECTRONIC COPY OF FINAL DOCUMENT;
SEALED ORIGINAL DOCUMENT IS WITH
HENDERSON ENGINEERS, Omid M.
MOTTAHED, REGISTRATION # 39542

7350 NORTH 14TH STREET, SUITE 4110
PHOENIX, AZ 85018
TEL: 602.351.5200 FAX: 602.351.5201
www.h-e-n-g.com

10/01/2011
AZ CONTRACT NUMBER: 104704
10/01/2011/01/11



North

OMID M. MOTTAHED



CITY OF MARICOPA
CITY HALL COMPLEX

Gensler

201 E Washington Street
Suite 750
Phoenix AZ 85018
Tel: 602.523.4900
Fax: 602.523.4949

Date	Issue Description	By	Check
01.10.2012	Site Plan Review	KJH	OM
02.17.2012	City Comments	KJH	OM
03.06.2012	City Comments	KJH	OM

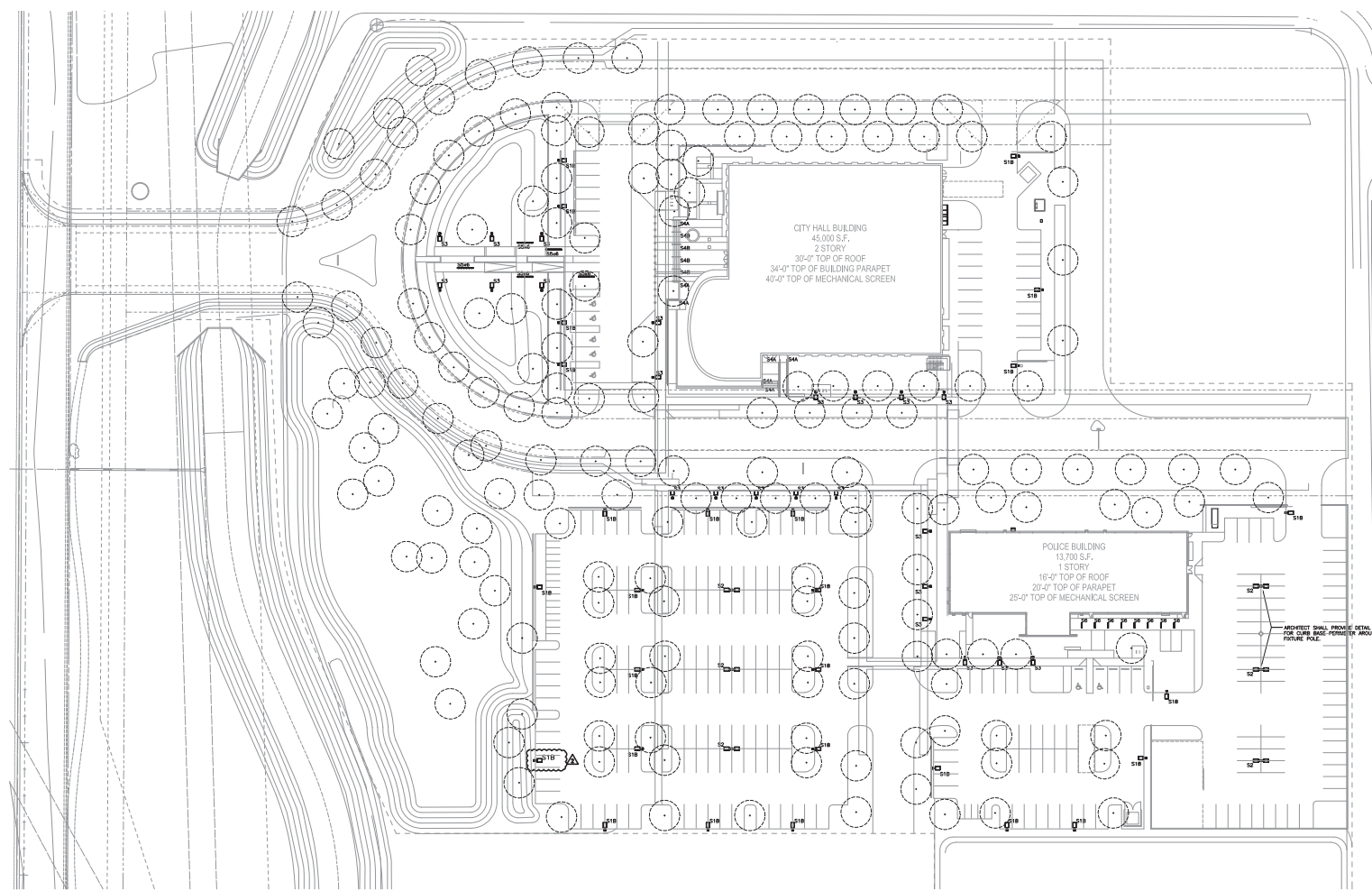

1 ON-SITE LIGHTING SITE PLAN
SCALE: 1"=30'-0"

Seal/Signature



Project Name
CITY HALL COMPLEX, CITY OF MARICOPA

Project Number
57,6205,000

Description
ON-SITE LIGHTING PLAN

Scale
AS NOTED

ES01.01

© 2011 Gensler



ELECTRONIC COPY OF FINAL DOCUMENT;
SEALED ORIGINAL DOCUMENT IS WITH
HENDERSON ENGINEERS, Omid M.
MOTTAHED, REGISTRATION # 39542

7350 NORTH 14TH STREET, SUITE 4110
PHOENIX, AZ 85018
TEL: 602.351.5200 FAX: 602.351.5201
www.h-e-n-g.com

1001000010
AZ CONTRACT NUMBER: 1041704
100100001011



North

OMID M. MOTTAHED