

Information shown on this map is for general reference and should be verified using recorded documents. It should not be used to replace a site survey.

5/25/2022

11" x 8.5"

H:\Projects\Development Services\2022\City Hall Exhibit\city_hall_exhibit.aprx

0 150 300
Feet
1 inch = 300 Feet



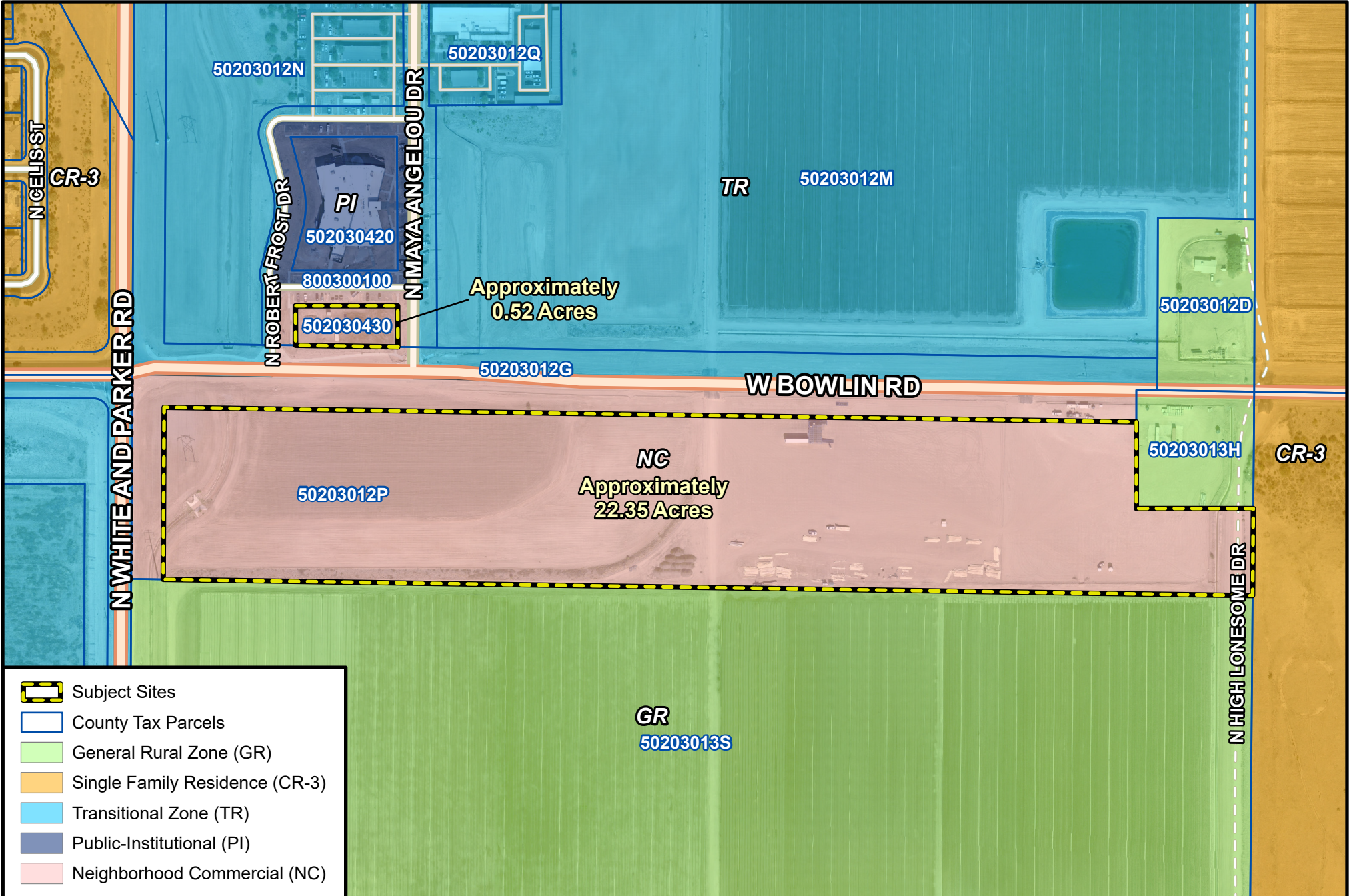

	Subject Sites
	County Tax Parcels
	General Rural Zone (GR)
	Single Family Residence (CR-3)
	Transitional Zone (TR)
	Public-Institutional (PI)
	Neighborhood Commercial (NC)

Information shown on this map is for general reference and should be verified using recorded documents. It should not be used to replace a site survey.

6/8/2022

11" x 8.5"

H:\Projects\Development Services\2022\City Center\city_hall_exhibit.aprx

