

Arizona Department of Liquor Licenses and Control  
 800 W Washington 5th Floor  
 Phoenix AZ 85007-2934  
 www.azliquor.gov  
 (602) 542-5141

FOR DLLC USE ONLY

Event date(s): \_\_\_\_\_

Event time start/end: \_\_\_\_\_

**APPLICATION FOR SPECIAL EVENT LICENSE**  
 Fee= \$25.00 per day for 1-10 days (consecutive)  
 A service fee of \$25.00 will be charged for all dishonored checks (A.R.S. §44-6852)

**IMPORTANT INFORMATION: This document must be fully completed or it will be returned.**

The Department of Liquor Licenses and Control must receive this application ten (10) business days prior to the event. If the special event will be held at a location without a permanent liquor license or if the event will be on any portion of a location that is not covered by the existing liquor license, this application must be approved by the local government before submission to the Department of Liquor Licenses and Control (see Section 15).

**SECTION 1** Name of Organization: Province Community Association

**SECTION 2** Non-Profit/IRS Tax Exempt Number: 20-0812692

**SECTION 3** The organization is a: (check one box only)

- Charitable (501.C)  Fraternal (must have regular membership and have been in existence for over five (5) years)  
 Religious  Civic (Rotary, College Scholarship)  Political Party, Ballot Measure or Campaign Committee

**SECTION 4** Will this event be held on a currently licensed premise and within the already approved premises?

- Yes  No

Province Community Association      #15114181 (expired)      520 568-8316  
 Name of Business      License Number      Phone (include Area Code)

**SECTION 5** How is this special event going to conduct all dispensing, serving, and selling of spirituous liquors? Please read R-19-318 for explanation (look in special event planning guide) and check one of the following boxes.

- Place license in non-use  
 Dispense and serve all spirituous liquors under retailer's license  
 Dispense and serve all spirituous liquors under special event  
 Split premise between special event and retail location

(If not using retail license, submit a letter of agreement from the agent/owner of the licensed premise to suspend the license during the event. If the special event is only using a portion of premise, agent/owner will need to suspend that portion of the premise.)

**SECTION 6** What is the purpose of this event?  On-site consumption  Off-site (auction)  Both

**SECTION 7** Location of the Event: Province Community Association

Address of Location: 20942 N. Province Parkway      Maricopa      Pinal, AZ      85138  
 Street      City      County/State      Zip

**SECTION 8** Will this be stacked with a wine festival/craft distiller festival?  Yes  No

**SECTION 9** Applicant must be a member of the qualifying organization and authorized by an Officer, Director or Chairperson of the Organization named in Section 1. (Authorizing signature is required in Section 13.)

1. Applicant: Weber      Wendy      Ann      May 28, 1969  
 Last      First      Middle      Date of Birth

2. Applicant's mailing address: 20942 N. Province Parkway      Maricopa      AZ      85138  
 Street      City      State      Zip

3. Applicant's home/cell phone: (484) 225-1110      Applicant's business phone: (520) 568-8316

4. Applicant's email address: wweber@aamaz.com

**SECTION 10**

1. Has the applicant been convicted of a felony, or had a liquor license revoked within the last five (5) years?  
 Yes  No (If yes, attach explanation.)

2. How many special event licenses have been issued to this location this year? 6  
 (The number cannot exceed 12 events per year; exceptions under A.R.S. §4-203.02(D).)

3. Is the organization using the services of a promoter or other person to manage the event?  Yes  No  
 (If yes, attach a copy of the agreement.)

4. List all people and organizations who will receive the proceeds. Account for 100% of the proceeds. The organization applying must receive 25% of the gross revenues of the special event liquor sales. Attach an additional page if necessary.

Name Province Community Association Percentage 25%  
 Address 20942 N. Province Parkway Maricopa AZ 85138  
Street City State Zip

Name Couple of Bartenders Percentage 75%  
 Address 3145 E. Chandler Blvd., Suite 110-522 Phoenix AZ 85048  
Street City State Zip

5. Please read A.R.S. §4-203.02 Special event license; rules and R19-1-205 Requirements for a Special Event License.

**Note: ALL ALCOHOLIC BEVERAGE SALES MUST BE FOR CONSUMPTION AT THE EVENT SITE ONLY.**

"NO ALCOHOLIC BEVERAGES SHALL LEAVE SPECIAL EVENT UNLESS THEY ARE IN AUCTION SEALED CONTAINERS OR THE SPECIAL EVENT LICENSE IS STACKED WITH WINE /CRAFT DISTILLERY FESTIVAL LICENSE"

6. What type of security and control measures will you take to prevent violations of liquor laws at this event?  
 (List type and number of police/security personnel and type of fencing or control barriers, if applicable.)

\_\_\_\_\_ Number of Police 2 \_\_\_\_\_ Number of Security Personnel  Fencing  Barriers

Explanation: The event will be contained within Province Community Village Center where staff will be on duty and will be monitoring the event. In addition, the Community contracts a security company that provides guards on duty 24 hours daily.

**SECTION 11** Date(s) and Hours of Event. May not exceed 10 consecutive days.

See A.R.S. §4-244(15) and (17) for legal hours of service.

	Date	Day of Week	Event Start Time AM/PM	License End Time AM/PM
DAY 1:	<u>09/17/2015</u>	<u>Thursday</u>	<u>3:00 pm</u>	<u>8:00 pm</u>
DAY 2:	<u>10/15/2015</u>	<u>Thursday</u>	<u>3:00 pm</u>	<u>8:00 pm</u>
DAY 3:	<u>11/19/2015</u>	<u>Thursday</u>	<u>3:00 pm</u>	<u>8:00 pm</u>
DAY 4:	<u>12/17/2015</u>	<u>Thursday</u>	<u>3:00 pm</u>	<u>8:00 pm</u>
DAY 5:	<u>01/21/2016</u>	<u>Thursday</u>	<u>3:00 pm</u>	<u>8:00 pm</u>
DAY 6:	<u>02/18/2016</u>	<u>Thursday</u>	<u>3:00 pm</u>	<u>8:00 pm</u>
DAY 7:	<u>03/17/2016</u>	<u>Thursday</u>	<u>3:00 pm</u>	<u>8:00 pm</u>
DAY 8:	<u>04/21/2016</u>	<u>Thursday</u>	<u>3:00 pm</u>	<u>8:00 pm</u>
DAY 9:	<u>05/19/2016</u>	<u>Thursday</u>	<u>3:00 pm</u>	<u>8:00 pm</u>
DAY 10:	_____	_____	_____	_____

**SECTION 12** License premises diagram. The licensed premises for your special event is the area in which you are authorized to sell, dispense or serve alcoholic beverages under the provisions of your license. The following space is to be used to prepare a diagram of your special event licensed premises. Please show dimensions, serving areas, fencing, barricades, or other control measures and security position.

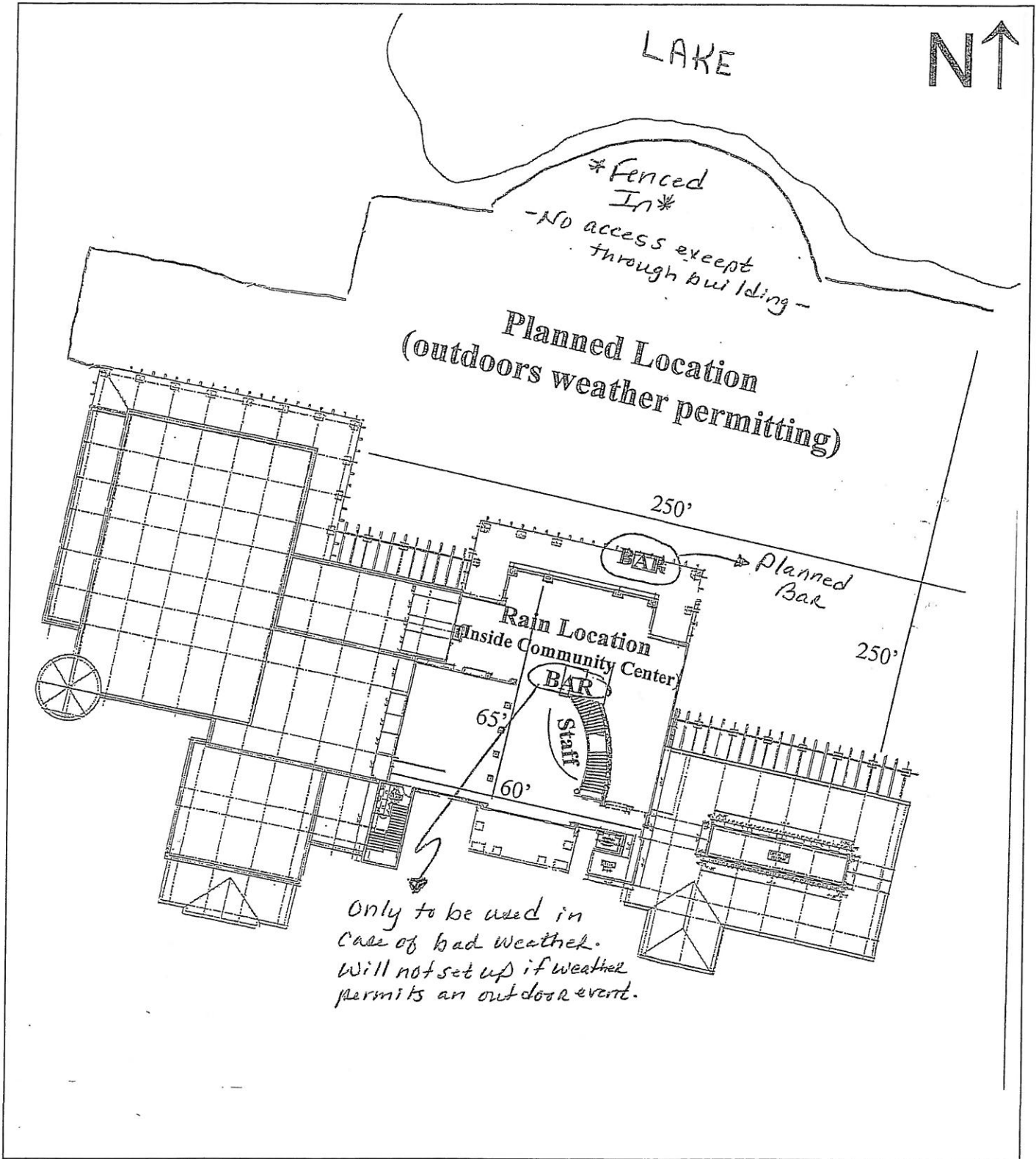



**SECTION 13** This section is to be completed only by an Officer, Director or Chairperson of the organization named in Section 1.

I, Melani Caron declare that I am an OFFICER, DIRECTOR, or CHAIRPERSON  
(Print full name)  
appointing the applicant listed in Section 9, to apply on behalf of the foregoing organization for a Special Event  
Liquor License.

x Melani Caron Community Mgr. 6-12-15 602 694 3833  
(Signature) Title/ Position Date Phone #

The foregoing instrument was acknowledged before me this 15<sup>th</sup> June 2015  
State AZ County of Pinal  
Day Month Year

My Commission Expires



**LUCIA A. RODRIGUEZ**  
Notary Public - State of Arizona  
PINAL COUNTY  
My Commission Expires  
August 24, 2016

Lucia A. Rodriguez  
Signature of Notary Public

**SECTION 14** This section is to be completed only by the applicant named in Section 9.

I, Wendy Ann Weber declare that I am the APPLICANT filing this application as  
(Print full name)  
listed in Section 9. I have read the application and the contents and all statements are true, correct and  
complete.

x Wendy Weber Lifestyle Director June 12, 2015 520-568-8316  
(Signature) Title/ Position Date Phone #

The foregoing instrument was acknowledged before me this 15<sup>th</sup> June 2015  
State AZ County of Pinal  
Day Month Year

My Commission Expires



**LUCIA A. RODRIGUEZ**  
Notary Public - State of Arizona  
PINAL COUNTY  
My Commission Expires  
August 24, 2016

Lucia A. Rodriguez  
Signature of Notary Public

The local governing body may require additional applications to be completed and submitted. Please check with local government as to how far in advance they require these applications to be submitted. Additional licensing fees may also be required before approval may be granted. For more information, please contact your local jurisdiction: [http://www.azliquor.gov/assets/documents/homepage\\_docs/spec\\_event\\_links.pdf](http://www.azliquor.gov/assets/documents/homepage_docs/spec_event_links.pdf).

**SECTION 15** Local Governing Body Approval Section

I, \_\_\_\_\_ recommend  APPROVAL  DISAPPROVAL  
(government official) (Title)

on behalf of \_\_\_\_\_  
(City, Town, County) Signature Date Phone

FOR DEPARTMENT OF LIQUOR LICENSES AND CONTROL USE ONLY

APPROVAL  DISAPPROVAL BY: \_\_\_\_\_ DATE: \_\_\_\_\_