

# ARIZONA DEPARTMENT OF LIQUOR LICENSES & CONTROL

800 W Washington 5th Floor  
Phoenix, Arizona 85007-2934  
(602) 542-5141

## APPLICATION FOR SPECIAL EVENT LICENSE

Fee = \$25.00 per day for 1-10 day events only  
A service fee of \$25.00 will be charged for all dishonored checks (A.R.S. § 44-6852)

**NOTE: THIS DOCUMENT MUST BE FULLY COMPLETED OR IT WILL BE RETURNED.**  
PLEASE ALLOW 10 BUSINESS DAYS FOR PROCESSING.

**\*\*Application must be approved by local government before submission to Department of Liquor Licenses and Control. (Section #20)**

DLLC USE ONLY
LICENSE #

1. Name of Organization: Province Community Association
2. Non-Profit/I.R.S. Tax Exempt Number: 20-0812692
3. The organization is a: (check one box only)
- Charitable     Fraternal (must have regular membership and in existence for over 5 years)
- Civic     Religious     Political Party, Ballot Measure, or Campaign Committee
4. What is the purpose of this event?  on-site consumption     off-site consumption (auction)     both
- Active Adult Monthly Community Happy Hour

5. Location of the event: 20942 N. Province Parkway    Maricopa    Pinal    85138

Address of physical location (Not P.O. Box)    City    County    Zip

**Applicant must be a member of the qualifying organization and authorized by an Officer, Director or Chairperson of the Organization named in Question #1. (Signature required in section #18)**

6. Applicant: Weber    Wendy    Ann    May 28, 1969

Last    First    Middle    Date of Birth

7. Applicant's Mailing Address: 20942 N. Province Parkway    Maricopa    AZ    85138

Street    City    State    Zip

8. Phone Numbers: ( 520 ) 568-8315    ( 520 ) 568-8316    ( 484 ) 225-1110

Site Owner #    Applicant's Business #    Applicant's Home #

9. Date(s) & Hours of Event: (see A.R.S. 4-244(15) and (17) for legal hours of service)

	Date	Day of Week	Hours from A.M./P.M.	To A.M./P.M.
Day 1:	<u>September 20, 2012</u>	<u>Thursday</u>	<u>4:00 pm</u>	<u>8:00 pm</u>
Day 2:	<u>October 18, 2012</u>	<u>Thursday</u>	<u>4:00 pm</u>	<u>8:00 pm</u>
Day 3:	<u>November 15, 2012</u>	<u>Thursday</u>	<u>4:00 pm</u>	<u>8:00 pm</u>
Day 4:	<u>December 20, 2012</u>	<u>Thursday</u>	<u>4:00 pm</u>	<u>8:00 pm</u>
Day 5:	_____	_____	_____	_____
Day 6:	_____	_____	_____	_____
Day 7:	_____	_____	_____	_____
Day 8:	_____	_____	_____	_____
Day 9:	_____	_____	_____	_____
Day 10:	_____	_____	_____	_____

\*Disabled individuals requiring special accommodations, please call (602) 542-9027



**THIS SECTION TO BE COMPLETED ONLY BY AN OFFICER, DIRECTOR OR CHAIRPERSON OF THE ORGANIZATION NAMED IN QUESTION #1**

18. I, Rachelle Lynn Reith declare that I am an Officer/Director/Chairperson appointing the applicant listed in Question 6, to apply on behalf of the foregoing organization for a Special Event Liquor License.

X Rachelle Lynn Reith

Community Manager June 14, 2012 (520 ) 568-8315  
(Title/Position) (Date) (Phone #)

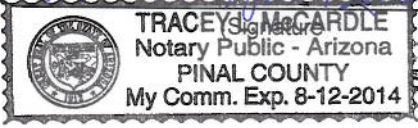

State of ARIZONA County of PINAL

The foregoing instrument was acknowledged before me this

22 JUNE 2012  
Day Month Year

My Commission expires on: 08/12/2014  
(Date)

Tracey L. McCordle  
(Signature of NOTARY PUBLIC)

**THIS SECTION TO BE COMPLETED ONLY BY THE APPLICANT NAMED IN QUESTION #6**

19. I, Wendy Ann Weber declare that I am the APPLICANT filing this application as listed in Question 6. I have read the application and the contents and all statements are true, correct and complete.

Wendy Ann Weber

State of ARIZONA County of PINAL

The foregoing instrument was acknowledged before me this

22 JUNE 2012  
Day Month Year

My commission expires on: 08/12/2014  
(Date)

Tracey L. McCordle  
(Signature of NOTARY PUBLIC)

**You must obtain local government approval. City or County MUST recommend event and complete item #20. The local governing body may require additional applications to be completed and submitted 60 days in advance of the event. Additional licensing fees may also be required before approval may be granted.**

**LOCAL GOVERNING BODY APPROVAL SECTION**

20. I, \_\_\_\_\_ hereby recommend this special event application  
(Government Official) (Title)  
on behalf of \_\_\_\_\_  
(City, Town or County) (Signature of OFFICIAL) (Date)

**FOR DLLC DEPARTMENT USE ONLY**

Department Comment Section:

\_\_\_\_\_  
(Employee) (Date)

APPROVED  DISAPPROVED BY:

\_\_\_\_\_  
(Title) (Date)

**SPECIAL EVENT LICENSED PREMISES DIAGRAM**  
(This diagram must be completed with this application)

Special Event Diagram: (Show dimensions, serving areas, and label type of enclosure and security positions)  
NOTE: Show nearest cross streets, highway, or road if location doesn't have an address.

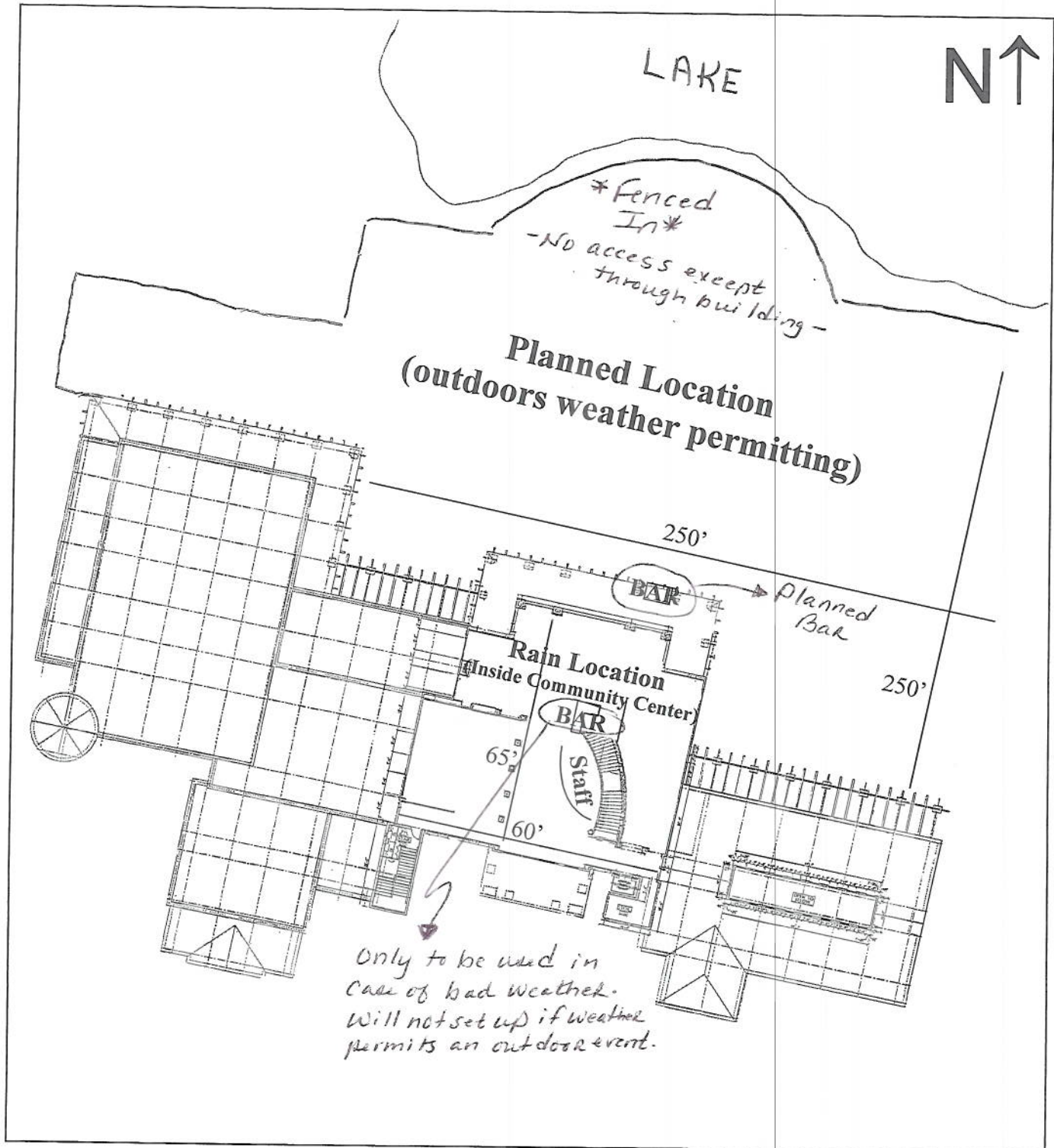

**SERIES: 15 SPECIAL EVENT LICENSE (Temporary)**

**Non-transferable  
On-sale retail privileges**

**PURPOSE:**

**Allows a charitable, civic, fraternal, political or religious organization to sell and serve spirituous liquor for consumption only on the premises where the spirituous liquor is sold, and only for the period authorized on the license. This is a temporary license.**

**ADDITIONAL RIGHTS AND RESPONSIBILITIES:**

**The applicant for a special event license must request a special event application from the Department and file the application with the governing body of the city or town, or Board of Supervisors of an unincorporated area of a county (where the special event is to take place) for approval or disapproval. Some local governing bodies may require approximately 60 days prior notice.**

**If the application is approved by the local authority, and the event meets the requirements for granting the license, the Director will issue a special event license to the qualifying organization.**

**Qualifying organizations will be granted a special event license for no more than ten (10) days in a calendar year. Events must be held on consecutive days and at the same location or additional licenses will be required. The license is automatically terminated upon closing of the last day of the event or the expiration of the license, whichever occurs first.**

**The qualified organization must receive at least twenty-five percent (25 %) of the gross revenues of the special event liquor sales.**

**A person selling spirituous liquor under a special event license must purchase the spirituous liquor from the holder of a license authorized to sell off-sale; *except that*, in the case of a non-profit organization which has obtained a special event license for the purpose of charitable fund raising activities, a person may receive the spirituous liquor from a wholesaler as a donation.**

**AVERAGE APPROVAL TIME: One (1) to seven (7) days.**

**PERIOD OF ISSUANCE:**

**Issued for no more than a cumulative total of ten (10) days in a calendar year. A special event may be held for more than one (1) day, but it must be held on consecutive days and at the same location or additional licenses will be required.**

**FEES: \$25.00 per day.**

**ARIZONA STATUTES AND REGULATIONS:**

**ARS 4-203.02, 4-244, 4-261; Rule R19-1-228, R19-1-235, R19-1-309.**

**Disabled individuals requiring special accommodations please call (602) 542-9027**