



Arizona Department of Liquor Licenses and Control
 800 W Washington 5th Floor
 Phoenix, AZ 85007-2934
 www.azliquor.gov
 (602) 542-5141

DLLC USE ONLY

CSR:
Log #:

APPLICATION FOR EXTENSION OF PREMISES/PATIO PERMIT

OBTAIN APPROVAL FROM LOCAL GOVERNING BOARD BEFORE SUBMITTING TO THE DEPARTMENT OF LIQUOR
****Notice: Allow 30-45 days to process permanent change of premises****

Permanent change of area of service. **A non-refundable \$50. Fee will apply.** Specific purpose for change:

Temporary change (**No Fee**) for date(s) of: 5/16/21 through 5/16/21 list specific purpose for change:

CAR SHOW 9AM-3PM

- Licensee's Name: MILLER, JEFFREY License#: 012110012288
Last First Middle
- Mailing address: PO BOX 2502 CHANDLER AZ 85244
Street City State Zip Code
- Business Name: HONEYCUTT COFFEE CAFE
- Business Address: 44400 W HONEYCUTT Road #109 MARICOPA Arizona 85138
Street City State Zip Code
- Email Address: LIQUORLICENSE@AZLIC.COM
- Business Phone Number: 5205104468 Contact Phone Number: 4807302675

7. Is extension of premises/patio complete?
 If no, what is your estimated completion date? / /

8. Do you understand Arizona Liquor Laws and Regulations?
 Yes No

9. Does this extension bring your premises within 300 feet of a church or school?
 Yes No

10. Have you received approved Liquor Law Training?
 Yes No

11. What security precautions will be taken to prevent liquor violations in the extended area? AREA WILL BE
ENCLOSED AND UNDER CONSTANT EMPLOYEE OBSERVATION.

12. **IMPORTANT:** Attach the revised floor plan, clearly depicting your licensed premises along with the new extended area outlined in black marker or ink, **if the extended area is not outlined and marked "extension" we cannot accept the application.**

Barrier Exemption: an exception to the requirement of barriers surrounding a patio/outdoor serving area may be requested. Barrier exemptions are granted based on public safety, pedestrian traffic, and other factors unique to a licensed premises. List specific reasons for exemption:

Approval Disapproval by **DLLC**: _____ Date: ____/____/____

MILLER, JEFFREY

I, (Print Full Name) _____, hereby swear under penalty of perjury and in compliance with A.R.S. § 4-210(A)(2) and (3) that I have read and understand the foregoing and verify that the information and statements that I have made herein are true and correct to the best of my knowledge.

Applicant Signature:  _____

GOVERNING BOARD

After completion, and **BEFORE submitting to the Department of Liquor**, please take this application to your local Board of Supervisors, City Council or Designate for their recommendation. This recommendation is not binding on the Department of Liquor.

Approval Disapproval

Authorized Signature Title Agency Date

DLLC USE ONLY

Investigation Recommendation: Approval Disapproval by: _____ Date: ____/____/____

Director Signature required for Disapprovals: _____ Date: ____/____/____

FOR CAR SHOW
May 16th

S 89°41'55" E 352.96'

BUILDING B
11,600 SF

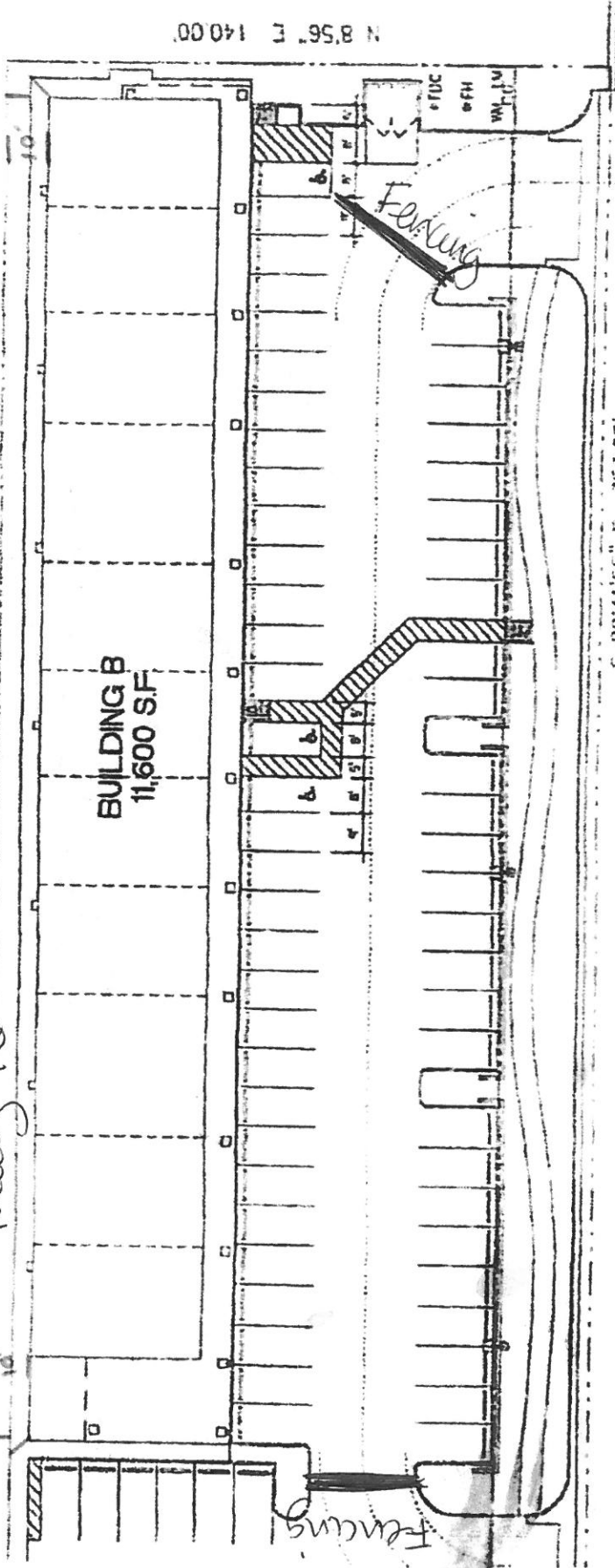

N 85°56' E 140.00'

S 89°41'55" E 353.29'

ROAD



Arizona Department of Liquor Licenses and Control
 800 W Washington 5th Floor
 Phoenix, AZ 85007-2934
 www.azliquor.gov
 (602) 542-5141

DLIC USE ONLY

CSR:
Log #:

APPLICATION FOR EXTENSION OF PREMISES/PATIO PERMIT

OBTAIN APPROVAL FROM LOCAL GOVERNING BOARD BEFORE SUBMITTING TO THE DEPARTMENT OF LIQUOR
****Notice: Allow 30-45 days to process permanent change of premises****

Permanent change of area of service. **A non-refundable \$50. Fee will apply.** Specific purpose for change:

Temporary change (**No Fee**) for date(s) of: 5/15/21 through 5/15/21 list specific purpose for change:

DANCE NIGHT 7PM-2AM

- Licensee's Name: MILLER, JEFFREY License#: 012110012288
Last First Middle
- Mailing address: PO BOX 2502 CHANDLER AZ 85244
Street City State Zip Code
- Business Name: HONEYCUTT COFFEE CAFE
- Business Address: 44400 W HONEYCUTT Road #109 MARICOPA Arizona 85138
Street City State Zip Code
- Email Address: LIQUORLICENSE@AZLIC.COM
- Business Phone Number: 5205104468 Contact Phone Number: 4807302675

7. Is extension of premises/patio complete?
 If no, what is your estimated completion date? / /

8. Do you understand Arizona Liquor Laws and Regulations?
 Yes No

9. Does this extension bring your premises within 300 feet of a church or school?
 Yes No

10. Have you received approved Liquor Law Training?
 Yes No

11. What security precautions will be taken to prevent liquor violations in the extended area? AREA WILL BE
ENCLOSED AND UNDER CONSTANT EMPLOYEE OBSERVATION.

12. **IMPORTANT:** Attach the revised floor plan, clearly depicting your licensed premises along with the new extended area outlined in black marker or ink, **if the extended area is not outlined and marked "extension" we cannot accept the application.**

Barrier Exemption: an exception to the requirement of barriers surrounding a patio/outdoor serving area may be requested. Barrier exemptions are granted based on public safety, pedestrian traffic, and other factors unique to a licensed premises. List specific reasons for exemption:

Approval Disapproval by **DLLC**: _____ Date: ____/____/____

MILLER, JEFFREY

I, (Print Full Name) _____, hereby swear under penalty of perjury and in compliance with A.R.S. § 4-210(A)(2) and (3) that I have read and understand the foregoing and verify that the information and statements that I have made herein are true and correct to the best of my knowledge.

Applicant Signature: 

GOVERNING BOARD

After completion, and **BEFORE submitting to the Department of Liquor**, please take this application to your local Board of Supervisors, City Council or Designate for their recommendation. This recommendation is not binding on the Department of Liquor.

Approval Disapproval

Authorized Signature Title Agency Date

DLLC USE ONLY

Investigation Recommendation: Approval Disapproval by: _____ Date: ____/____/____

Director Signature required for Disapprovals: _____ Date: ____/____/____

FOR ALL
OTHER DATES

S 89°41'55" E 352.96'

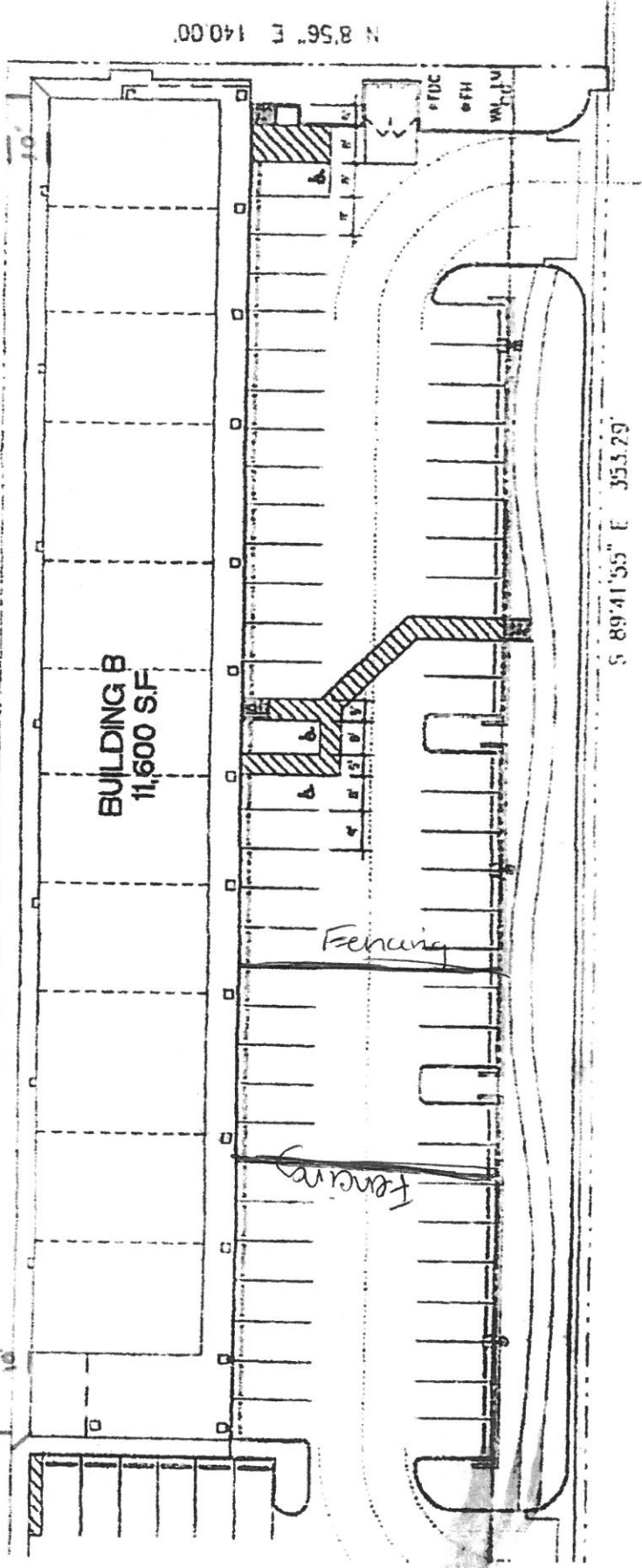

N 8°56' E 140.00'

S 89°41'55" E 353.29'

ROAD

BUILDING B
11,600 SF

Fencing

Fencings



Arizona Department of Liquor Licenses and Control
 800 W Washington 5th Floor
 Phoenix, AZ 85007-2934
 www.azliquor.gov
 (602) 542-5141

DLIC USE ONLY

CSR:
Log #:

APPLICATION FOR EXTENSION OF PREMISES/PATIO PERMIT

OBTAIN APPROVAL FROM LOCAL GOVERNING BOARD BEFORE SUBMITTING TO THE DEPARTMENT OF LIQUOR
****Notice: Allow 30-45 days to process permanent change of premises****

Permanent change of area of service. **A non-refundable \$50. Fee will apply.** Specific purpose for change:

Temporary change (**No Fee**) for date(s) of: 6/12/21 through 6/12/21 list specific purpose for change:

DANCE NIGHT 7PM-2AM

1. Licensee's Name: MILLER, JEFFREY License#: 012110012288
Last First Middle

2. Mailing address: PO BOX 2502 CHANDLER AZ 85244
Street City State Zip Code

3. Business Name: HONEYCUTT COFFEE CAFE

4. Business Address: 44400 W HONEYCUTT Road #109 MARICOPA Arizona 85138
Street City State Zip Code

5. Email Address: LIQUORLICENSE@AZLIC.COM

6. Business Phone Number: 5205104468 Contact Phone Number: 4807302675

7. Is extension of premises/patio complete?
 If no, what is your estimated completion date? / /

8. Do you understand Arizona Liquor Laws and Regulations?
 Yes No

9. Does this extension bring your premises within 300 feet of a church or school?
 Yes No

10. Have you received approved Liquor Law Training?
 Yes No

11. What security precautions will be taken to prevent liquor violations in the extended area? AREA WILL BE
ENCLOSED AND UNDER CONSTANT EMPLOYEE OBSERVATION.

12. **IMPORTANT:** Attach the revised floor plan, clearly depicting your licensed premises along with the new extended area outlined in black marker or ink, **if the extended area is not outlined and marked "extension" we cannot accept the application.**

Barrier Exemption: an exception to the requirement of barriers surrounding a patio/outdoor serving area may be requested. Barrier exemptions are granted based on public safety, pedestrian traffic, and other factors unique to a licensed premises. List specific reasons for exemption:

Approval Disapproval by **DLLC**: _____ Date: ___/___/___

MILLER, JEFFREY

I, (Print Full Name) _____, hereby swear under penalty of perjury and in compliance with A.R.S. § 4-210(A)(2) and (3) that I have read and understand the foregoing and verify that the information and statements that I have made herein are true and correct to the best of my knowledge.

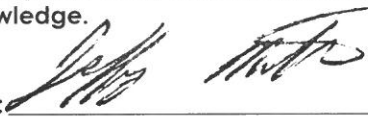
Applicant Signature:  _____

GOVERNING BOARD

After completion, and **BEFORE submitting to the Department of Liquor**, please take this application to your local Board of Supervisors, City Council or Designate for their recommendation. This recommendation is not binding on the Department of Liquor.

Approval Disapproval

Authorized Signature Title Agency Date

DLLC USE ONLY

Investigation Recommendation: Approval Disapproval by: _____ Date: ___/___/___

Director Signature required for Disapprovals: _____ Date: ___/___/___

FOR ALL
OTHER DATES

S 89°41'55" E 352.96'

BUILDING B
11,600 S.F.

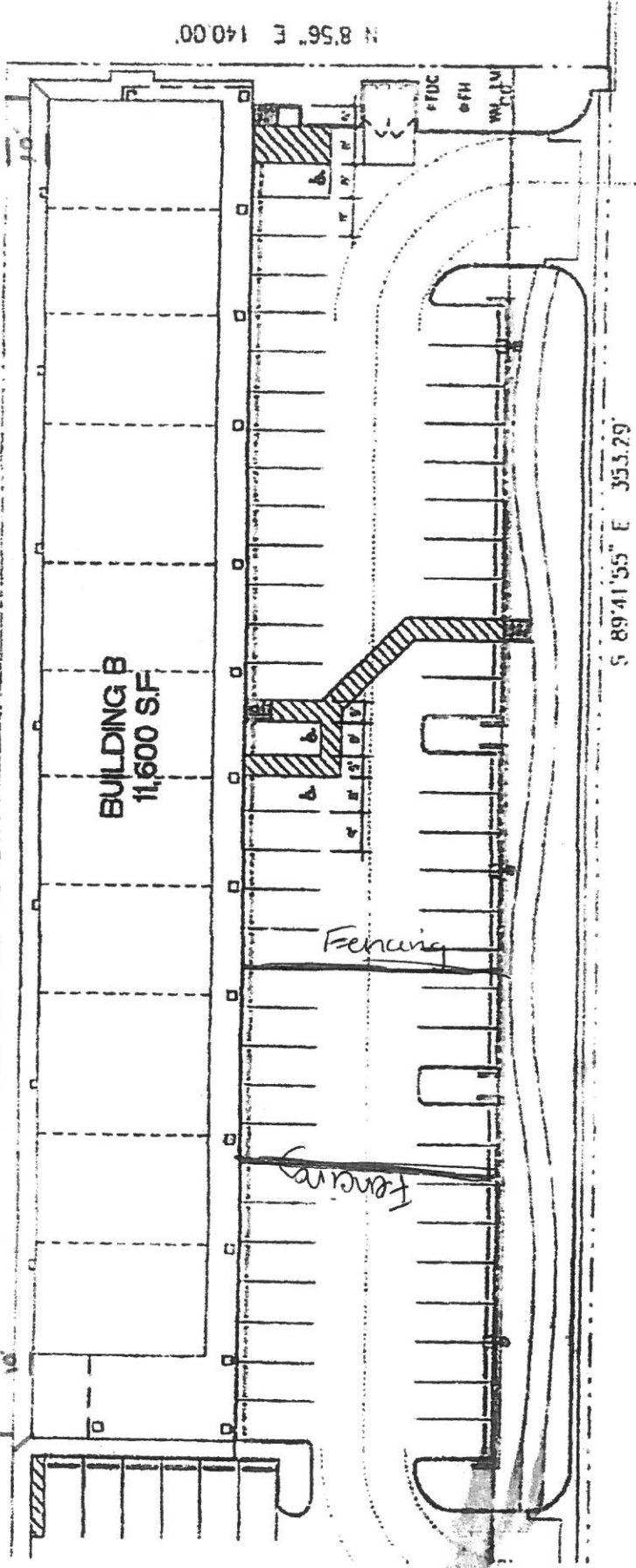

S 89°41'55" E 353.29'

ROAD



Arizona Department of Liquor Licenses and Control
 800 W Washington 5th Floor
 Phoenix, AZ 85007-2934
 www.azliquor.gov
 (602) 542-5141

DLLC USE ONLY

CSR:
Log #:

APPLICATION FOR EXTENSION OF PREMISES/PATIO PERMIT

OBTAIN APPROVAL FROM LOCAL GOVERNING BOARD BEFORE SUBMITTING TO THE DEPARTMENT OF LIQUOR
****Notice: Allow 30-45 days to process permanent change of premises****

Permanent change of area of service. **A non-refundable \$50. Fee will apply.** Specific purpose for change:

Temporary change (**No Fee**) for date(s) of: 6/19/21 through 6/19/21 list specific purpose for change:

DANCE NIGHT 7PM-2AM

- Licensee's Name: MILLER, JEFFREY License#: 012110012288
Last First Middle
- Mailing address: PO BOX 2502 CHANDLER AZ 85244
Street City State Zip Code
- Business Name: HONEYCUTT COFFEE CAFE
- Business Address: 44400 W HONEYCUTT Road #109 MARICOPA Arizona 85138
Street City State Zip Code
- Email Address: LIQUORLICENSE@AZLIC.COM
- Business Phone Number: 5205104468 Contact Phone Number: 4807302675

7. Is extension of premises/patio complete?
 If no, what is your estimated completion date? / /

8. Do you understand Arizona Liquor Laws and Regulations?
 Yes No

9. Does this extension bring your premises within 300 feet of a church or school?
 Yes No

10. Have you received approved Liquor Law Training?
 Yes No

11. What security precautions will be taken to prevent liquor violations in the extended area? AREA WILL BE
ENCLOSED AND UNDER CONSTANT EMPLOYEE OBSERVATION.

12. **IMPORTANT:** Attach the revised floor plan, clearly depicting your licensed premises along with the new extended area outlined in black marker or ink, ***if the extended area is not outlined and marked "extension" we cannot accept the application.***

Barrier Exemption: an exception to the requirement of barriers surrounding a patio/outdoor serving area may be requested. Barrier exemptions are granted based on public safety, pedestrian traffic, and other factors unique to a licensed premises. List specific reasons for exemption:

Approval Disapproval by **DLLC**: _____ Date: ____/____/____

MILLER, JEFFREY

I, (Print Full Name) _____ hereby swear under penalty of perjury and in compliance with A.R.S. § 4-210(A)(2) and (3) that I have read and understand the foregoing and verify that the information and statements that I have made herein are true and correct to the best of my knowledge.

Applicant Signature: 

GOVERNING BOARD

After completion, and **BEFORE submitting to the Department of Liquor**, please take this application to your local Board of Supervisors, City Council or Designate for their recommendation. This recommendation is not binding on the Department of Liquor.

Approval Disapproval

Authorized Signature Title Agency Date

DLLC USE ONLY

Investigation Recommendation: Approval Disapproval by: _____ Date: ____/____/____

Director Signature required for Disapprovals: _____ Date: ____/____/____

FOR ALL
OTHER DATES

S 89°41'55" E 352.96'

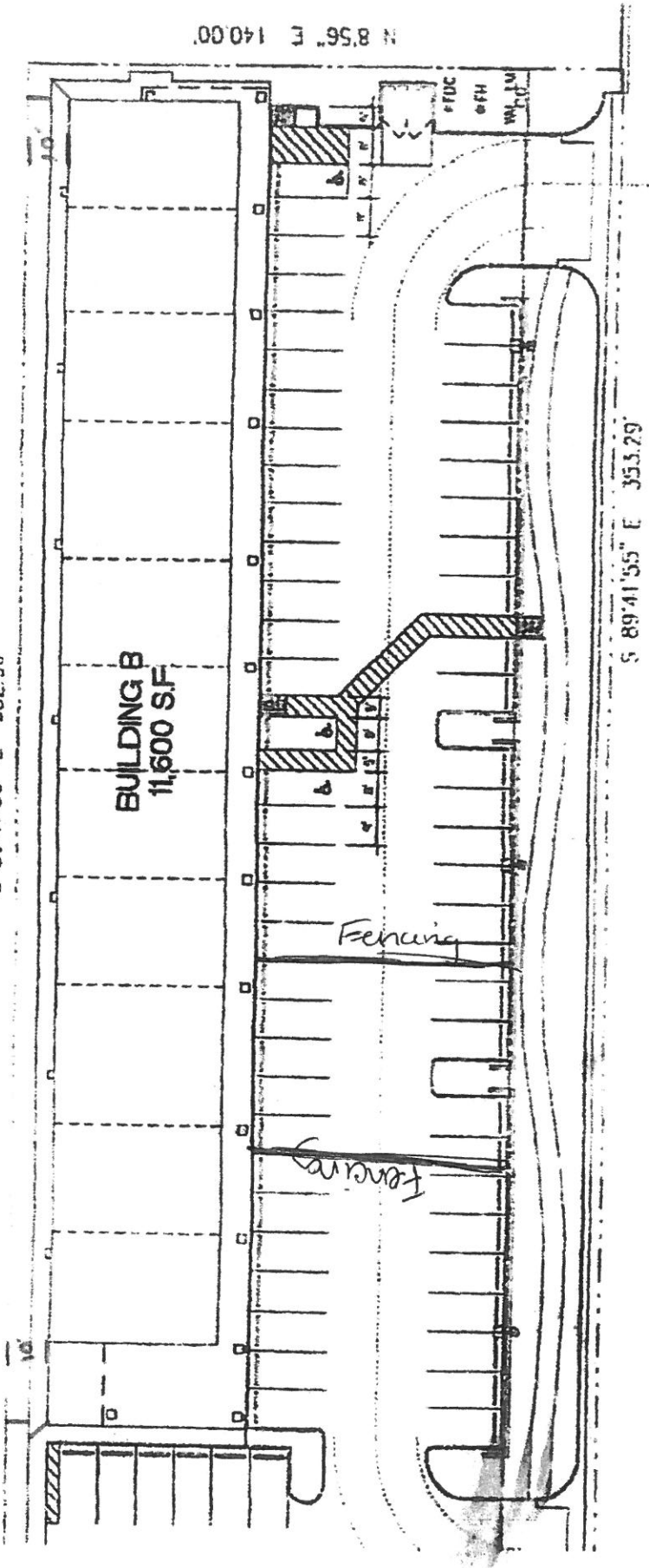

ROAD



Arizona Department of Liquor Licenses and Control
 800 W Washington 5th Floor
 Phoenix, AZ 85007-2934
 www.azliquor.gov
 (602) 542-5141

DLIC USE ONLY

CSR:
Log #:

APPLICATION FOR EXTENSION OF PREMISES/PATIO PERMIT

OBTAIN APPROVAL FROM LOCAL GOVERNING BOARD BEFORE SUBMITTING TO THE DEPARTMENT OF LIQUOR
****Notice: Allow 30-45 days to process permanent change of premises****

Permanent change of area of service. **A non-refundable \$50. Fee will apply.** Specific purpose for change:

Temporary change (**No Fee**) for date(s) of: 6/26/21 through 6/26/21 list specific purpose for change:

DANCE NIGHT 7PM-2AM

- Licensee's Name: MILLER, JEFFREY License#: 012110012288
Last First Middle
- Mailing address: PO BOX 2502 CHANDLER AZ 85244
Street City State Zip Code
- Business Name: HONEYCUTT COFFEE CAFE
- Business Address: 44400 W HONEYCUTT Road #109 MARICOPA Arizona 85138
Street City State Zip Code
- Email Address: LIQUORLICENSE@AZLIC.COM
- Business Phone Number: 5205104468 Contact Phone Number: 4807302675
- Is extension of premises/patio complete?
 If no, what is your estimated completion date? / /
- Do you understand Arizona Liquor Laws and Regulations?
 Yes No
- Does this extension bring your premises within 300 feet of a church or school?
 Yes No
- Have you received approved Liquor Law Training?
 Yes No
- What security precautions will be taken to prevent liquor violations in the extended area? AREA WILL BE
ENCLOSED AND UNDER CONSTANT EMPLOYEE OBSERVATION.

12. **IMPORTANT:** Attach the revised floor plan, clearly depicting your licensed premises along with the new extended area outlined in black marker or ink, **if the extended area is not outlined and marked "extension" we cannot accept the application.**

FOR ALL
OTHER DATES

S 89°41'55" E 352.96'

BUILDING B
11,600 S.F.

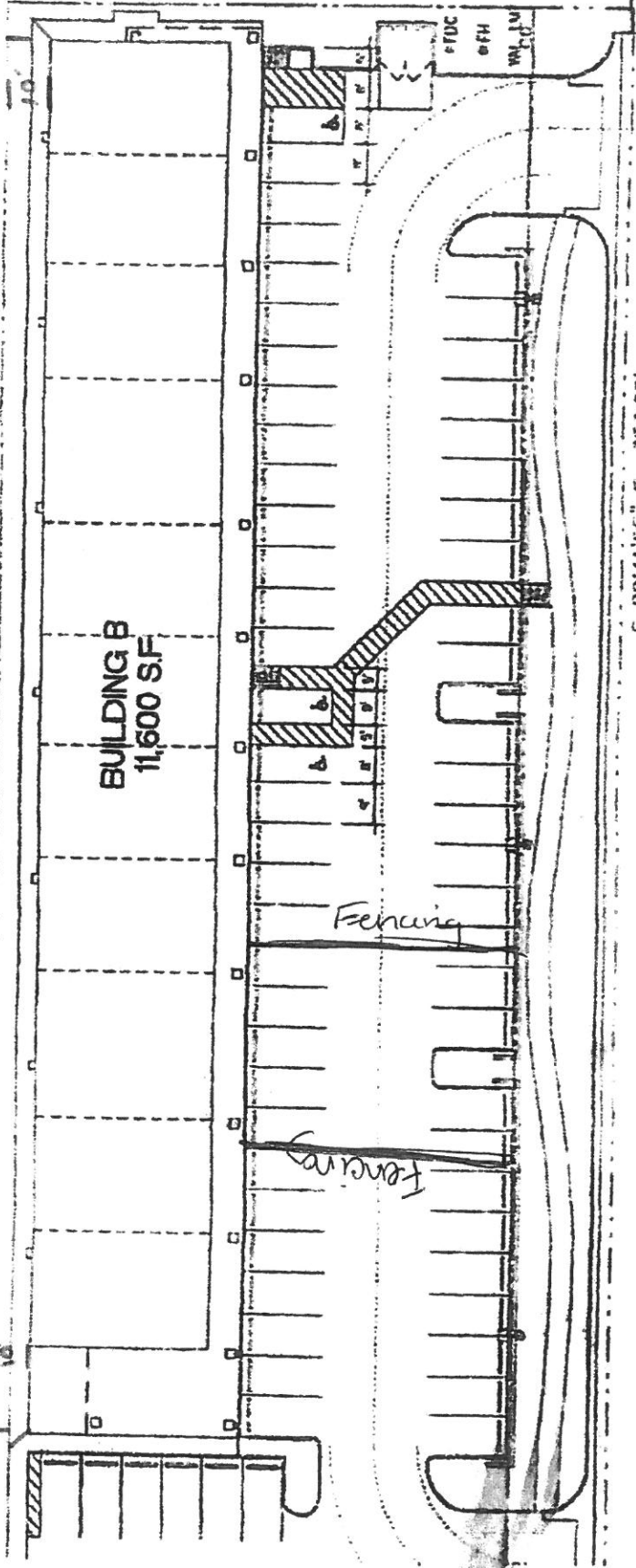

N 8°56' E 140.00'

S 89°41'55" E 353.29'

ROAD



Arizona Department of Liquor Licenses and Control
 800 W Washington 5th Floor
 Phoenix, AZ 85007-2934
 www.azliquor.gov
 (602) 542-5141

DLLC USE ONLY

CSR:
Log #:

APPLICATION FOR EXTENSION OF PREMISES/PATIO PERMIT

OBTAIN APPROVAL FROM LOCAL GOVERNING BOARD BEFORE SUBMITTING TO THE DEPARTMENT OF LIQUOR
****Notice: Allow 30-45 days to process permanent change of premises****

Permanent change of area of service. **A non-refundable \$50. Fee will apply.** Specific purpose for change:

Temporary change (**No Fee**) for date(s) of: 7/3/21 through 7/3/21 list specific purpose for change:

DANCE NIGHT 7PM-2AM

- Licensee's Name: MILLER, JEFFREY License#: 012110012288
Last First Middle
- Mailing address: PO BOX 2502 CHANDLER AZ 85244
Street City State Zip Code
- Business Name: HONEYCUTT COFFEE CAFE
- Business Address: 44400 W HONEYCUTT Road #109 MARICOPA Arizona 85138
Street City State Zip Code
- Email Address: LIQUORLICENSE@AZLIC.COM
- Business Phone Number: 5205104468 Contact Phone Number: 4807302675

7. Is extension of premises/patio complete?
 If no, what is your estimated completion date? / /

8. Do you understand Arizona Liquor Laws and Regulations?
 Yes No

9. Does this extension bring your premises within 300 feet of a church or school?
 Yes No

10. Have you received approved Liquor Law Training?
 Yes No

11. What security precautions will be taken to prevent liquor violations in the extended area? AREA WILL BE
ENCLOSED AND UNDER CONSTANT EMPLOYEE OBSERVATION.

12. **IMPORTANT:** Attach the revised floor plan, clearly depicting your licensed premises along with the new extended area outlined in black marker or ink, **if the extended area is not outlined and marked "extension" we cannot accept the application.**

Barrier Exemption: an exception to the requirement of barriers surrounding a patio/outdoor serving area may be requested. Barrier exemptions are granted based on public safety, pedestrian traffic, and other factors unique to a licensed premises. List specific reasons for exemption:

Approval Disapproval by **DLLC**: _____ Date: ___/___/___

MILLER, JEFFREY

I, (Print Full Name) _____, hereby swear under penalty of perjury and in compliance with A.R.S. § 4-210(A)(2) and (3) that I have read and understand the foregoing and verify that the information and statements that I have made herein are true and correct to the best of my knowledge.

Applicant Signature:  _____

GOVERNING BOARD

After completion, and **BEFORE submitting to the Department of Liquor**, please take this application to your local Board of Supervisors, City Council or Designate for their recommendation. This recommendation is not binding on the Department of Liquor.

Approval Disapproval

Authorized Signature Title Agency Date

DLLC USE ONLY

Investigation Recommendation: Approval Disapproval by: _____ Date: ___/___/___

Director Signature required for Disapprovals: _____ Date: ___/___/___

FOR ALL
OTHER DATES

S 89°41'55" E 352.96'

BUILDING B
11,600 SF

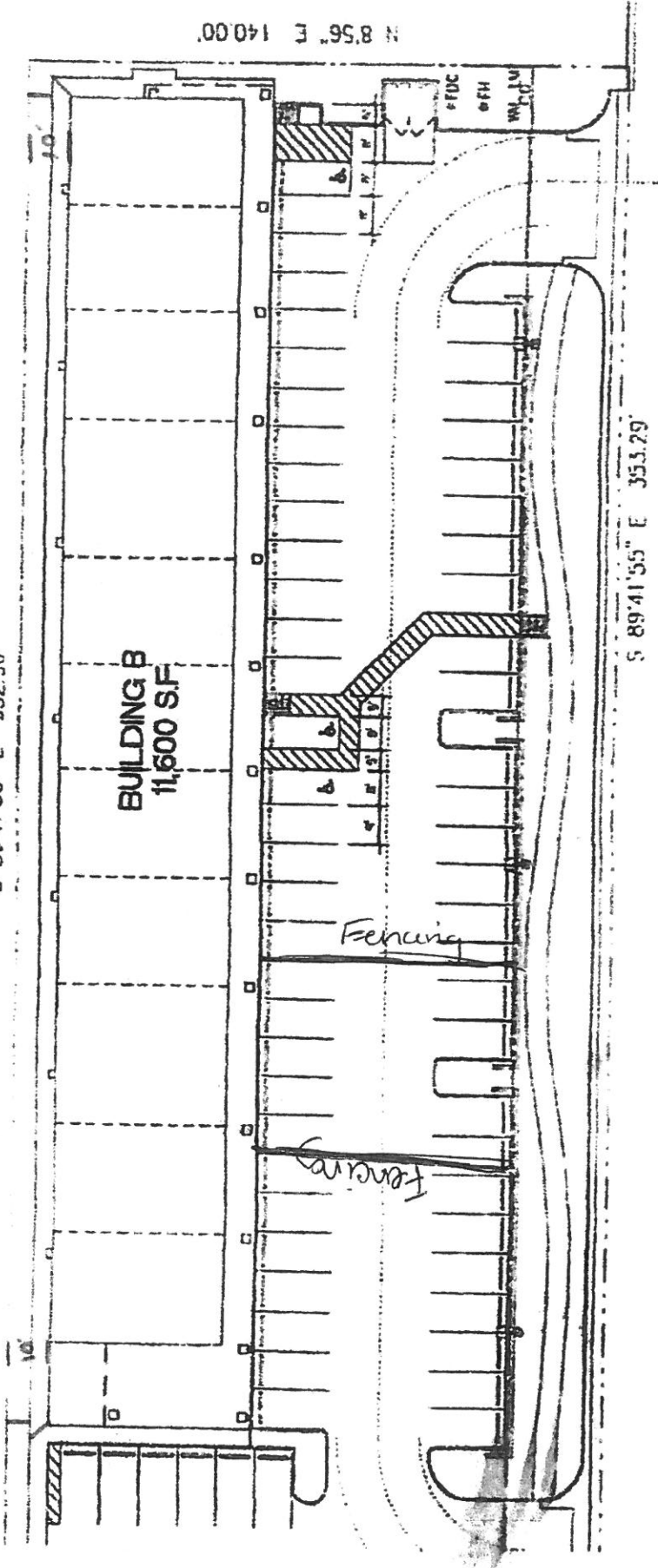

N 8°56' E 140.00'

S 89°41'55" E 353.29'

ROAD