

**PLANT SCHEDULE**

TREES	BOTANICAL / COMMON NAME	SIZE	QTY	SHRUBS	BOTANICAL / COMMON NAME	SIZE	QTY	SHRUBS	BOTANICAL / COMMON NAME	SIZE	QTY
	Caesalpinia cacalaco 'Smoothie' TM Smoothie Thornless Cascalote	2" Cal.; 11' Ht.; 6' Wd.	31		Agave desmettiana Dwarf Century Plant	5 gal.	50		Hesperaloe parviflora Red Yucca	5 gal.	140
	Olea europaea 'Fruitless' Fruitless Olive	2" Cal.; 8' Ht.; 6' Wd.	27		Agave geminiflora Century Plant	5 gal.	318		Lantana montevidensis 'New Gold' Trailing Lantana	1 gal.	243
	Parkinsonia x 'Desert Museum' Desert Museum Palo Verde	2" Cal.; 8' Ht.; 6' Wd.	9		Bougainvillea x 'Barbara Karst' Barbara Karst Bougainvillea	5 gal.	79		Muhlenbergia capillaris 'Regal Mist' TM Regal Mist Pink Muhly Grass	5 gal.	534
	Pistacia x 'Red Push' Red Push Pistache	2" Cal.; 8' Ht.; 6' Wd.	16		Carissa macrocarpa 'Boxwood Beauty' Beauty Natal Plum	5 gal.	1,001		Ruellia penninsularis Wild Petunia	5 gal.	153
	Quercus virginiana 'Heritage' Heritage Southern Live Oak	2" Cal.; 11' Ht.; 6' Wd.	14		Carissa macrocarpa 'Green Carpet' Green Carpet Natal Plum	1 gal.	228		Russelia equisetiformis Firecracker Plant	5 gal.	166
	Washingtonia filifera California Fan Palm	20' Ht.	28		Chrysactinia mexicana Damianita	1 gal.	403		Tecoma stans angustata Yellow Bells	5 gal.	96
	x Chitalpa tashkentensis 'Pink Dawn' Pink Dawn Chitalpa	2" Cal.; 8' Ht.; 6' Wd.	26		Dasyliiron longissimum Toothless Desert Spoon	5 gal.	54	<b>GROUND COVERS</b>	<b>BOTANICAL / COMMON NAME</b>	<b>QTY</b>	
					Dodonaea viscosa 'Purpurea' Purple Leafed Hopseed Bush	5 gal.	149		Cynodon dactylon 'Midiron' Bermuda Grass	28,015 sf	

**BFH Group**  
3707 EAST SOUTHERN AVENUE  
MESA, ARIZONA, 85206  
PHONE: 480.734.1446

REVISIONS:

**PRELIMINARY**  
**VILLAS AT STONEGATE**  
CITY OF MARICOPA, AZ 85138

Job No.  
Drawn By  
Checked

CALL THE WORKING DAYS  
(602) 263-1100  
**1-800-STAKE-IT**  
(OUTSIDE MARICOPA COUNTY)

JOB NO.  
21043  
LANDSCAPE  
PLAN  
SHEET NO.  
**L1**  
1 OF 3



MATCHLINE -SEE SHEET L3

MATCHLINE -SEE SHEET L1

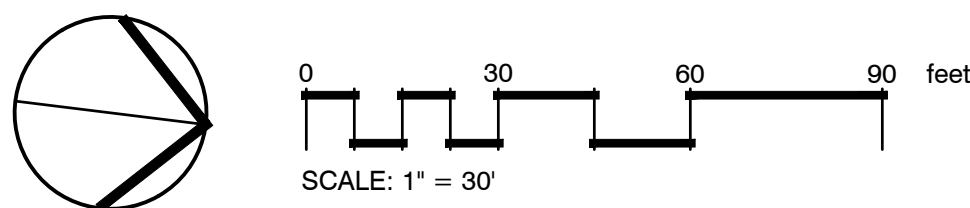
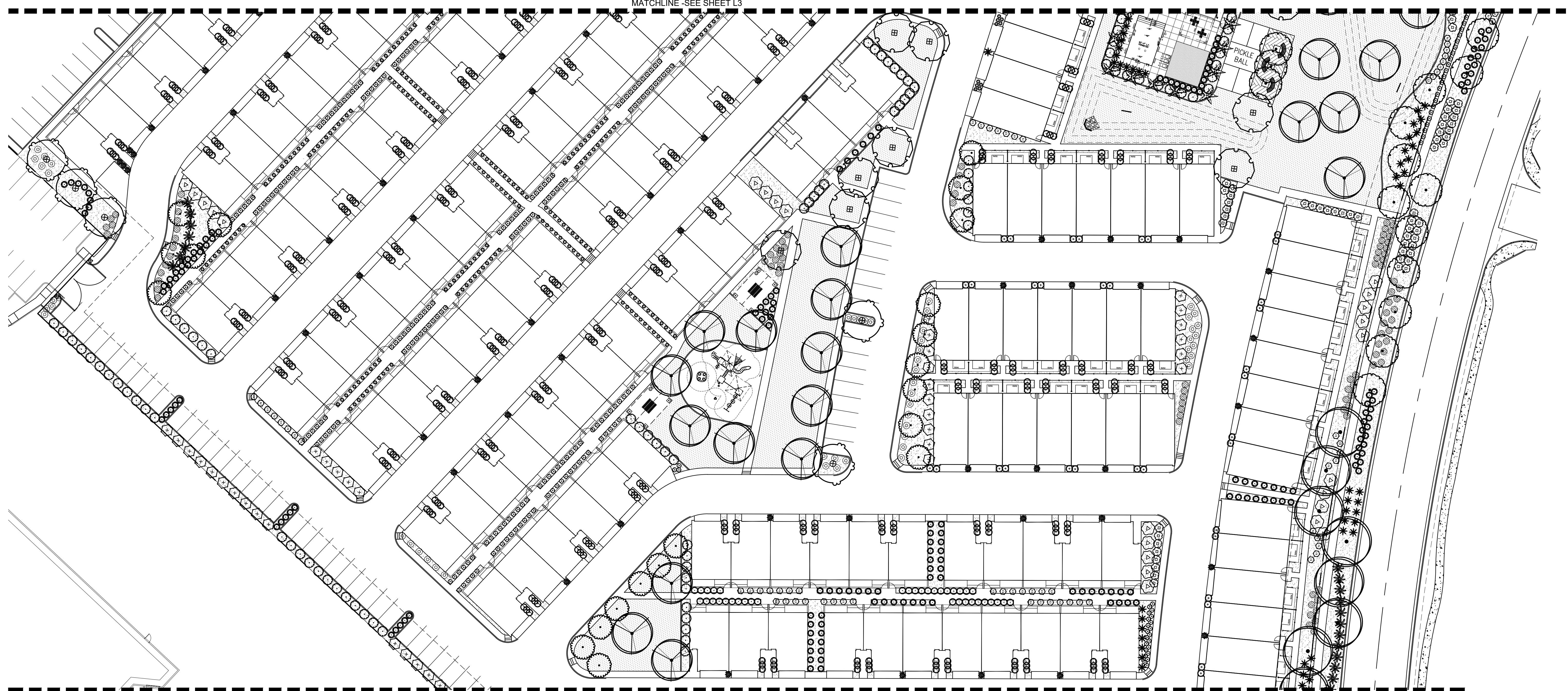

**PLANT SCHEDULE**

TREES	BOTANICAL / COMMON NAME	SIZE	QTY	SHRUBS	BOTANICAL / COMMON NAME	SIZE	QTY	SHRUBS	BOTANICAL / COMMON NAME	SIZE	QTY
	Caesalpinia cacalaco 'Smoothie' TM Smoothie Thornless Cascalote	2" Cal.; 11' Ht.; 6' Wd.	31		Agave desmettiana Dwarf Century Plant	5 gal.	50		Hesperaloe parviflora Red Yucca	5 gal.	140
	Olea europaea 'Fruitless' Fruitless Olive	2" Cal.; 8' Ht.; 6' Wd.	27		Agave geminiflora Century Plant	5 gal.	318		Lantana montevidensis 'New Gold' Trailing Lantana	1 gal.	243
	Parkinsonia x 'Desert Museum' Desert Museum Palo Verde	2" Cal.; 8' Ht.; 6' Wd.	9		Bougainvillea x 'Barbara Karst' Barbara Karst Bougainvillea	5 gal.	79		Muhlenbergia capillaris 'Regal Mist' TM Regal Mist Pink Muhly Grass	5 gal.	534
	Pistacia x 'Red Push' Red Push Pistache	2" Cal.; 8' Ht.; 6' Wd.	16		Carissa macrocarpa 'Boxwood Beauty' Beauty Natal Plum	5 gal.	1,001		Ruellia penninsularis Wild Petunia	5 gal.	153
	Quercus virginiana 'Heritage' Heritage Southern Live Oak	2" Cal.; 11' Ht.; 6' Wd.	14		Carissa macrocarpa 'Green Carpet' Green Carpet Natal Plum	1 gal.	228		Russelia equisetiformis Firecracker Plant	5 gal.	166
	Washingtonia filifera California Fan Palm	20' Ht.	28		Chrysactinia mexicana Damianita	1 gal.	403		Tecoma stans angustata Yellow Bells	5 gal.	96
	x Chitalpa tashkentensis 'Pink Dawn' Pink Dawn Chitalpa	2" Cal.; 8' Ht.; 6' Wd.	26		Dasyliion longissimum Toothless Desert Spoon	5 gal.	54	<b>GROUND COVERS</b>			
					Dodonaea viscosa 'Purpurea' Purple Leafed Hopseed Bush	5 gal.	149		Cynodon dactylon 'Midiron' Bermuda Grass		28,015 sf

**BFH Group**  
3707 EAST SOUTHERN AVENUE  
MESA, ARIZONA, 85206  
PHONE: 480.734.1446

REVISIONS:



**PRELIMINARY**  
**VILLAS AT STONEGATE**  
CITY OF MARICOPA, AZ 85138

Job No:  
Drawn By:  
Checked:

CALL THE WORKING DAYS  
(602) 263-1100  
**1-800-STAKE-IT**  
(outside maricopa county)

JOB NO.  
21043  
LANDSCAPE  
PLAN  
SHEET NO.  
**L2**  
2 OF 3

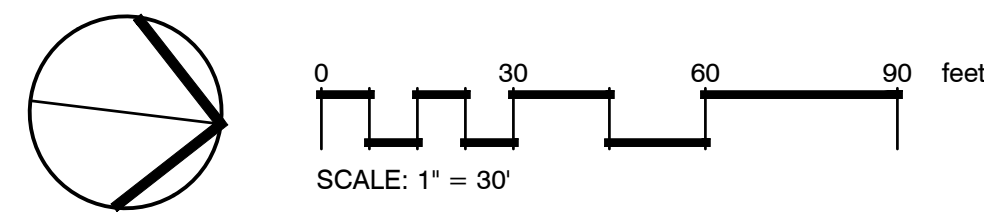
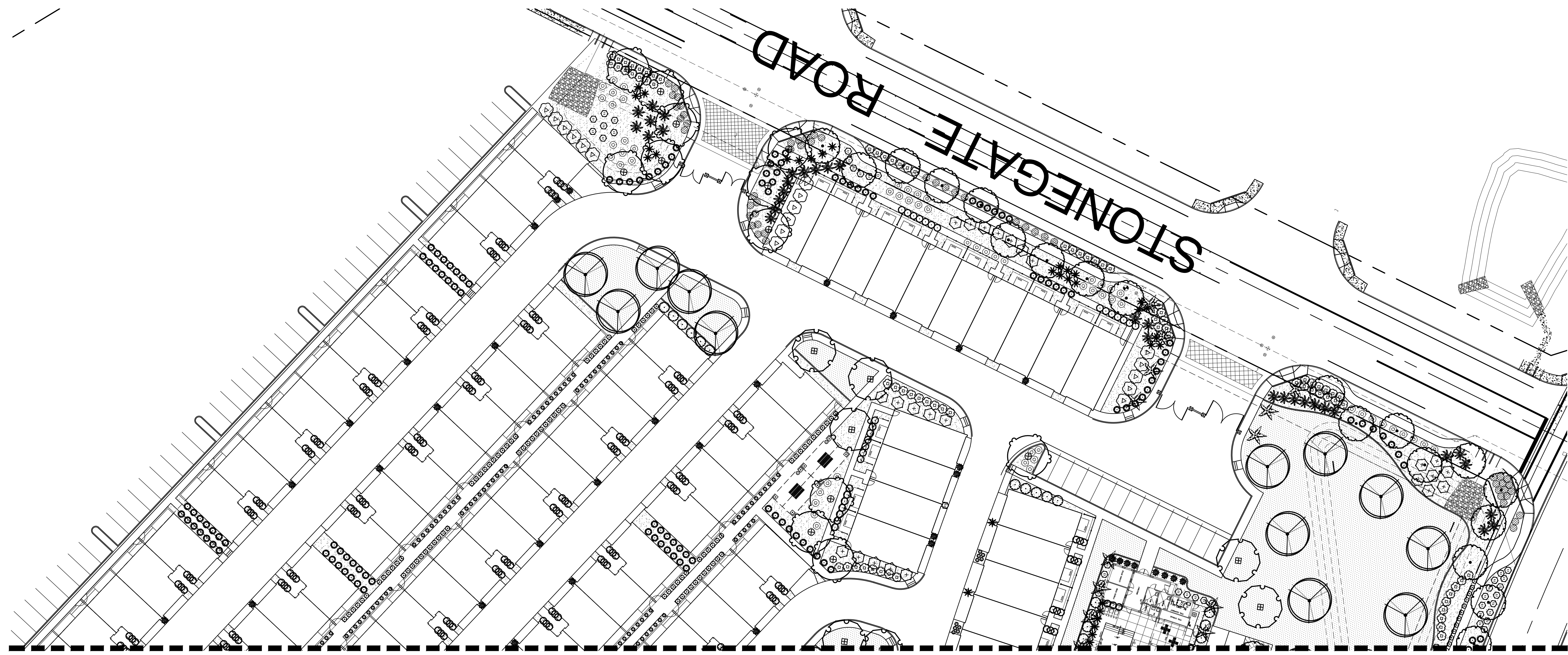



MATCHLINE -SEE SHEET L2

**PLANT SCHEDULE**

TREES	BOTANICAL / COMMON NAME	SIZE	QTY	SHRUBS	BOTANICAL / COMMON NAME	SIZE	QTY	SHRUBS	BOTANICAL / COMMON NAME	SIZE	QTY
	Caesalpinia cacalaco 'Smoothie' TM Smoothie Thornless Cascalote	2" Cal.; 11' Ht.; 6' Wd.	31		Agave desmettiana Dwarf Century Plant	5 gal.	50		Hesperaloe parviflora Red Yucca	5 gal.	140
	Olea europaea 'Fruitless' Fruitless Olive	2" Cal.; 8' Ht.; 6' Wd.	27		Agave geminiflora Century Plant	5 gal.	318		Lantana montevidensis 'New Gold' Trailing Lantana	1 gal.	243
	Parkinsonia x 'Desert Museum' Desert Museum Palo Verde	2" Cal.; 8' Ht.; 6' Wd.	9		Bougainvillea x 'Barbara Karst' Barbara Karst Bougainvillea	5 gal.	79		Muhlenbergia capillaris 'Regal Mist' TM Regal Mist Pink Muhly Grass	5 gal.	534
	Pistacia x 'Red Push' Red Push Pistache	2" Cal.; 8' Ht.; 6' Wd.	16		Carissa macrocarpa 'Boxwood Beauty' Beauty Natal Plum	5 gal.	1,001		Ruellia penninsularis Wild Petunia	5 gal.	153
	Quercus virginiana 'Heritage' Heritage Southern Live Oak	2" Cal.; 11' Ht.; 6' Wd.	14		Carissa macrocarpa 'Green Carpet' Green Carpet Natal Plum	1 gal.	228		Russelia equisetiformis Firecracker Plant	5 gal.	166
	Washingtonia filifera California Fan Palm	20' Ht.	28		Chrysactinia mexicana Damianita	1 gal.	403		Tecoma stans angustata Yellow Bells	5 gal.	96
	x Chitalpa tashkentensis 'Pink Dawn' Pink Dawn Chitalpa	2" Cal.; 8' Ht.; 6' Wd.	26		Dasyliiron longissimum Toothless Desert Spoon	5 gal.	54	<b>GROUND COVERS</b>			
					Dodonaea viscosa 'Purpurea' Purple Leafed Hopseed Bush	5 gal.	149		Cynodon dactylon 'Midiron' Bermuda Grass		28,015 sf

REVISIONS:

**PRELIMINARY**  
**VILLAS AT STONEGATE**  
CITY OF MARICOPA, AZ 85138

Job No.  
Drawn By  
Checked

CALL THE WORKING DAYS  
(602) 263-1100  
**1-800-STAKE-IT**  
(OUTSIDE MARICOPA COUNTY)



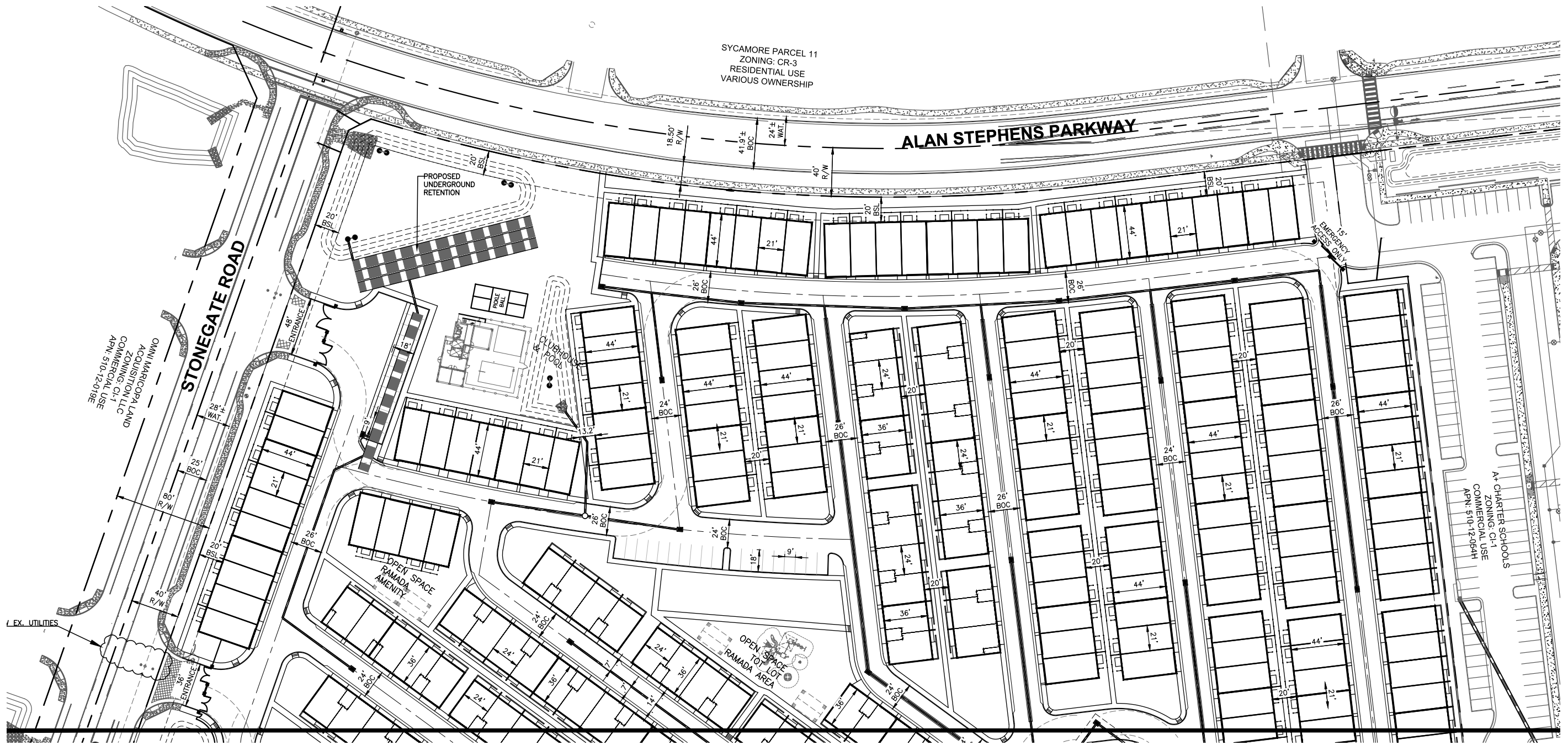

MATCH SHEET 3

SYCAMORE PARCEL 11  
ZONING: CR-3  
RESIDENTIAL USE  
VARIOUS OWNERSHIP

ALAN STEPHENS PARKWAY

STONEGATE ROAD

OMNI MARICOPA LAND  
ACQUISITION, LLC  
ZONING: C-1-1  
COMMERCIAL USE  
APN: 510-12-019E

A+ CHARTER SCHOOLS  
ZONING: C-1-1  
COMMERCIAL USE  
APN: 510-12-064H

**BFH Group**  
3707 EAST SOUTHERN AVENUE  
MESA, ARIZONA, 85206  
PHONE: 480.734.1446

**PRELIMINARY SITE PLAN**  
VILLAS AT STONEGATE  
CITY OF MARICOPA, AZ

Job No.:  
Drawn By: P.J.  
Checked: DB

CALL US FOR MORE DAYS  
(602) 263-1100  
1-800-STAKE-IT  
(OUTSIDE MARICOPA COUNTY)



JOB NO.  
202110090

SHEET NO.  
**2**

2 OF 7

NOT APPROVED FOR CONSTRUCTION

MATCH SHEET 2

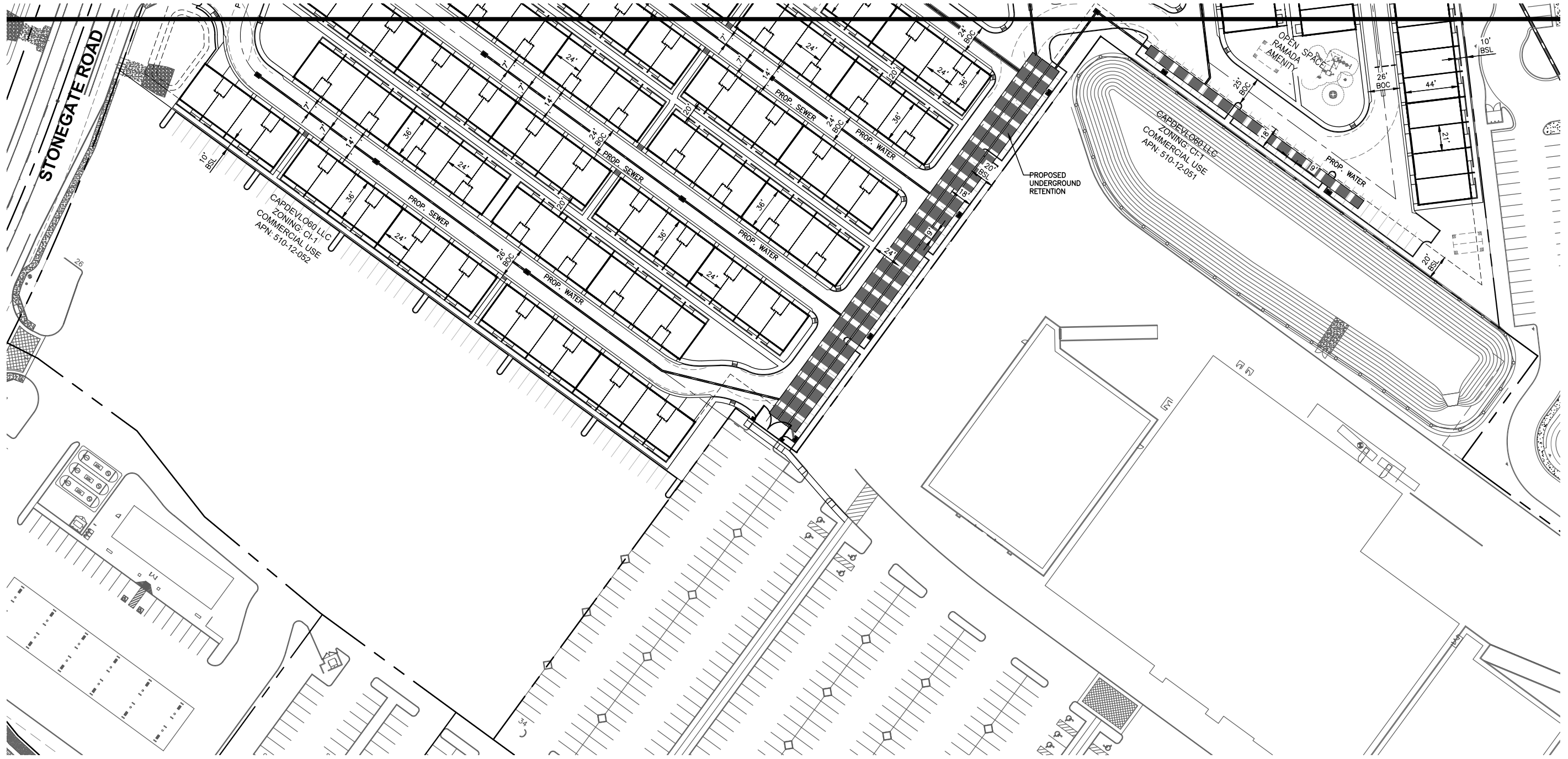

CAPDEVIL060 LLC  
 ZONING: C1-1  
 COMMERCIAL USE  
 APN: 510-12-052

CAPDEVIL060 LLC  
 ZONING: C1-1  
 COMMERCIAL USE  
 APN: 510-12-051

OPEN  
 RAMADA  
 AMENITY

PROPOSED  
 UNDERGROUND  
 RETENTION

STONEGATE ROAD

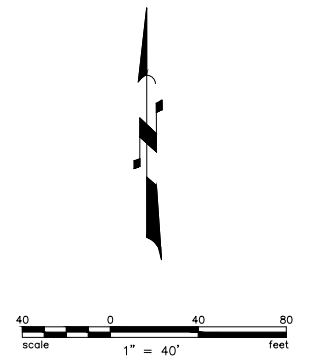

**BFH Group**  
 3707 EAST SOUTHERN AVENUE  
 MESA, ARIZONA, 85206  
 PHONE: 480.734.1446

REVISIONS:

**PRELIMINARY SITE PLAN**  
**VILLAS AT STONEGATE**  
 CITY OF MARICOPA, AZ

Job No.:	
Drawn By:	PJ
Checked:	DB

CALL US FOR MORE DAYS  
 (602) 263-1100  
 1-800-STAKE-IT  
 (OUTSIDE MARICOPA COUNTY)

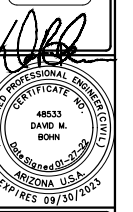

NOT APPROVED FOR CONSTRUCTION

JOB NO.	202110090
SHEET NO.	<b>3</b>
	3 OF 7