

# PRELIMINARY PLAT

FOR

## HOMESTEAD

W. HOMESTEAD AND N. CONTINENTAL BLVD  
MARICOPA, AZ 85138

### SHEET INDEX

PG #	SHEET LABEL	DESCRIPTION
1	LA CV	LANDSCAPE COVER
2	LA2.0	WALL PLANS
3-5	LA2.1-LA2.3	LAYOUT PLANS
6-8	LA3.1-LA3.3	PLANTING PLANS
9-10	LA6.1-LA6.2	CONSTRUCTION DETAILS

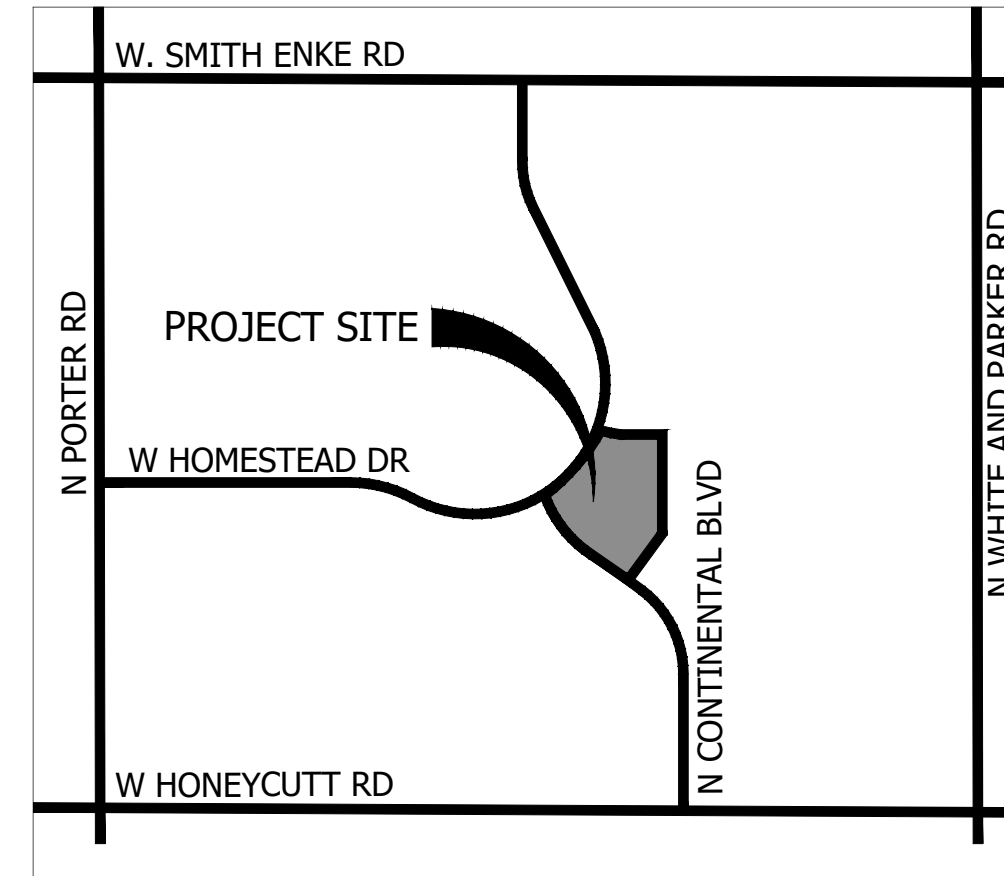

VICINITY MAP

NOT TO SCALE

### CLIENT / OWNER DEVELOPER:

DR HORTON
JOSE CASTILLO II
2525 W FRYE ROAD, SUITE 100
CHANDLER, AZ 85224
480-791-1593
jicastilloii@drhorton.com

### CONSULTANT TEAM:

LANDSCAPE ARCHITECT
ABLA, LLC
TOM DURANT
310 E. RIO SALADO PARKWAY
TEMPE, AZ 85281
480-530-0077
tom.durant@ablastudio.com

CIVIL ENGINEER
HIGARTWILSON
TY WILSON, PE
2141 E HIGHLAND AVE, SUITE 250
PHOENIX, AZ 85016
602-490-0535 EX 190
TWilson@hilgartwilson.com

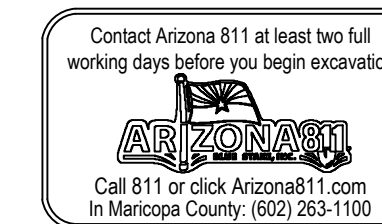

KEY MAP

NOT TO SCALE

1 2 3 4 5 6

Homestead  
Preliminary Plat  
Homestead Drive & Continental Blvd  
Maricopa, AZ  
SHEET TITLE: LANDSCAPE COVER



ABLA  
310 E. RIO SALADO PARKWAY  
TEMPE, ARIZONA 85281  
OFFICE: 480-530-0077  
WEB: ABLASTUDIO.COM

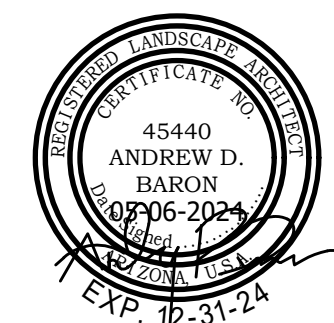

© Copyright 2024 ABLA, LLC.

DATE: 05-06-2024
ISSUED FOR: PRE-PLAT
DRAWN BY: JM
CHECKED BY: TD
PERMIT NUMBER:
ABLA PROJECT NUMBER: 50-913-24

LA CV

I:\SERVER\ABLA\LOCAL\ABLA\Projects\DR Horton\Homestead\Design Development\Pre Plat\02a-Walls\_Homestead\_DD.dwg

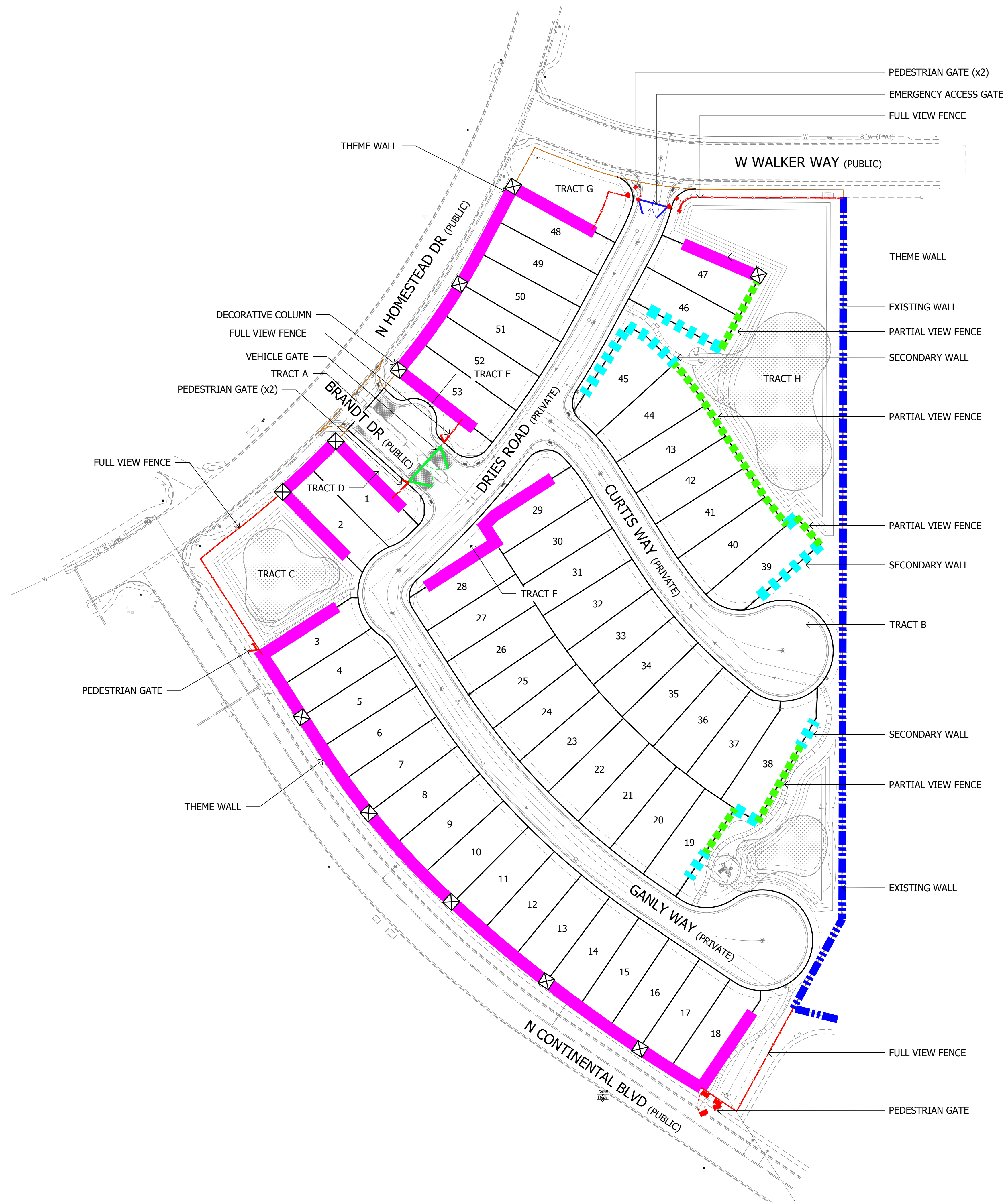

SYMBOL	DESCRIPTION	DETAIL	QTY.
	THEME WALL	DETAIL 1, SHEET LA6.1	1,892 LF
	SECONDARY WALL	DETAIL 2, SHEET LA6.1	437 LF
	PARTIAL VIEW FENCE	DETAIL 3, SHEET LA6.1	496 LF
	FULL VIEW FENCE	DETAIL 4, SHEET LA6.1	553 LF
	EXISTING WALL	EXISTING	
	DECORATIVE COLUMN	DETAIL 1, SHEET LA6.1	2 EA
	VEHICULAR GATE	DETAIL 1, SHEET LA2.1	1 EA
	EMERGENCY ACCESS GATE	DETAIL 1, SHEET LA2.2	1 EA
	PEDESTRIAN GATE	DETAIL 1, SHEETS LA2.1 & LA2.2	5 EA

**GENERAL WALL NOTES**

1. ALL WALLS TO TERMINATE WITH END WALL COLUMN 30'-0" FROM BACK OF CURB.
2. QUANTITIES SHOWN ARE FOR BIDDING AND PERMITTING PURPOSES ONLY, CONTRACTOR TO VERIFY.
3. CONTRACTOR TO VERIFY SIDEYARD RETURN LOCATIONS WITH HOMEBUILDER PRIOR TO CONSTRUCTION. (SIDEYARD RETURNS BUILT BY HOMEBUILDER)
4. QUANTITIES SHOWN FOR TOTAL LENGTHS OF ALL WALL PLAN SHEETS
5. ALL WALLS, RETURNS, COLUMNS AND MONUMENTS ARE SHOWN GRAPHICALLY AND DO NOT REPRESENT ACTUAL SIZE.
6. DECORATIVE COLUMNS SHALL BE INSTALLED AT A MINIMUM EVERY 100 FEET.

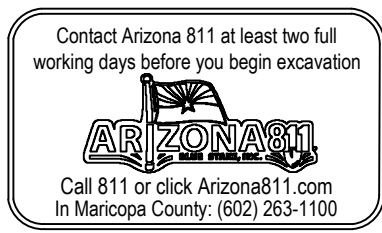
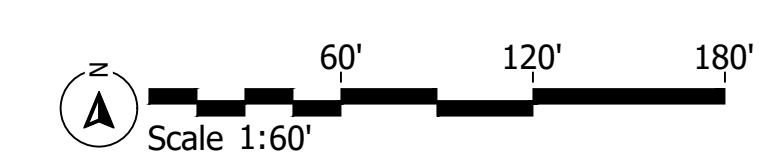

**KEY MAP**

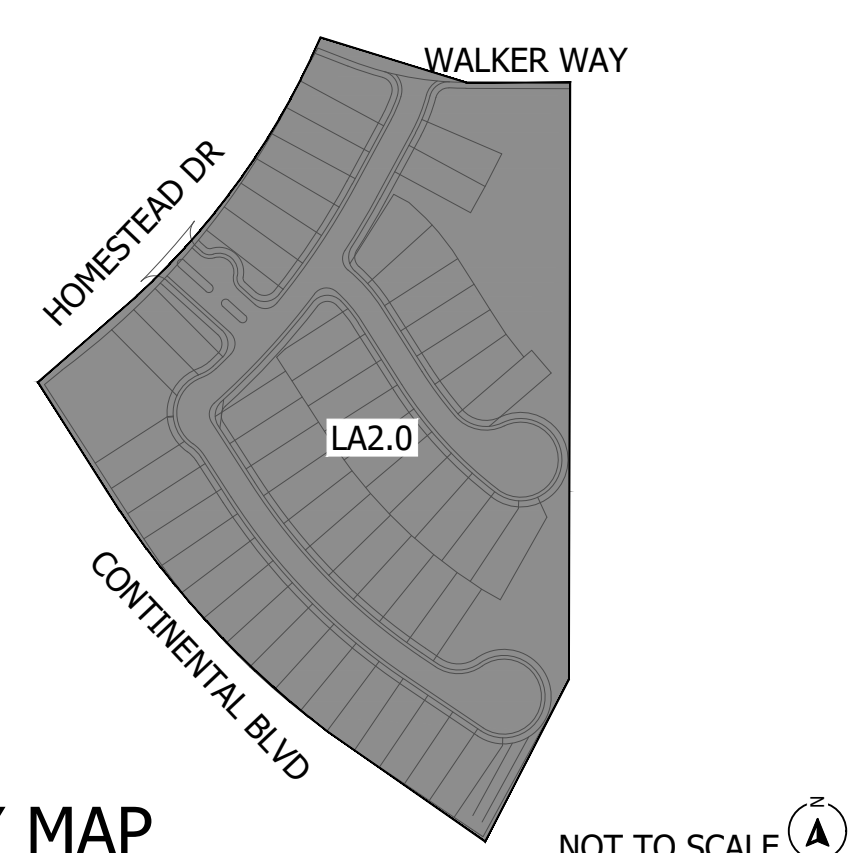

1
2
3
4
5
6

**Homestead**  
Preliminary Plat  
Homestead Drive & Continental Blvd  
Maricopa, AZ  
SHEET TITLE: WALL PLAN



**ABLA**  
**LA**  
310 E. RIO SALADO PARKWAY  
TEMPE, ARIZONA 85281  
OFFICE: 480-530-0077  
WEB: ABLASTUDIO.COM

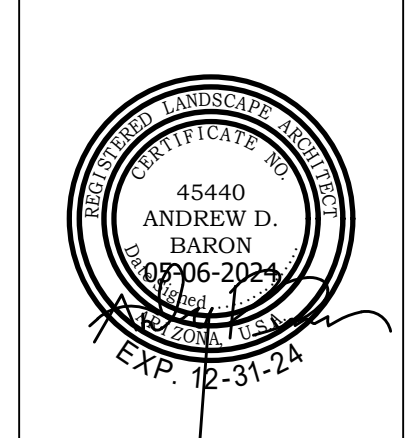

© Copyright 2024 ABLA, LLC.

DATE: 05-06-2024	ISSUED FOR: PRE-PLAT
DRAWN BY: JM	CHECKED BY: TD
PERMIT NUMBER:	ABLA PROJECT NUMBER:
	50-913-24

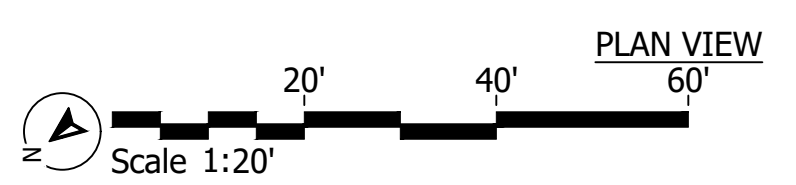
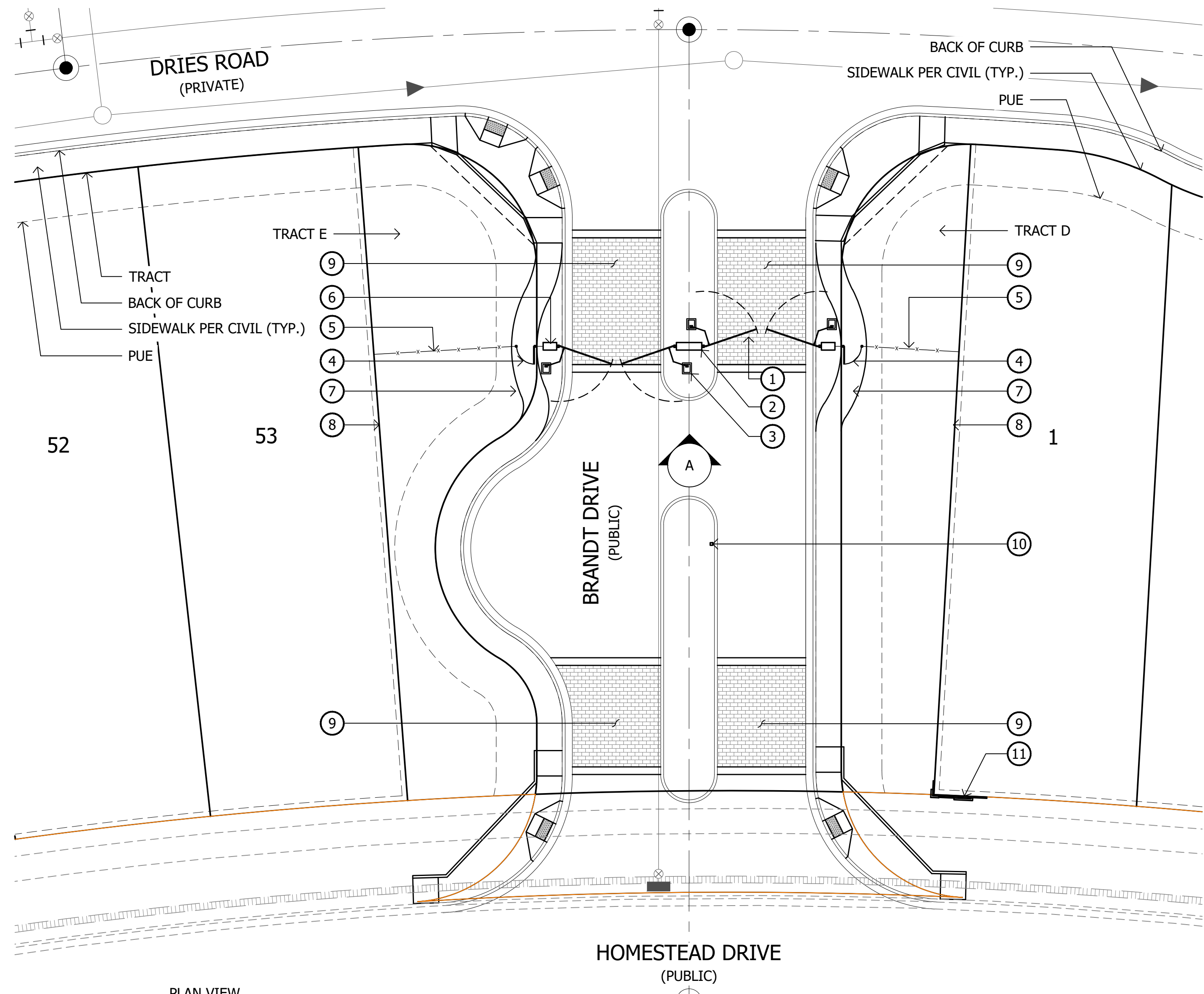

**DISCLAIMER:**  
 THIS CONCEPTUAL GRAPHIC IS INTENDED FOR ILLUSTRATIVE PURPOSES ONLY. THIS GRAPHIC IS A CONCEPTUAL ILLUSTRATION TO SHOW DESIGN INTENT. LAYOUT AND DESIGN (LOCATIONS) MAY CHANGE DURING FINAL ENGINEERING. THE DESIGN ELEMENTS/AMENITIES DEPICTED ON THE ILLUSTRATION WILL BE SHOWN ON THE FINAL CONSTRUCTION DOCUMENTS WITHIN SUBSTANTIAL CONFORMANCE TO THE ILLUSTRATION SHOWN.

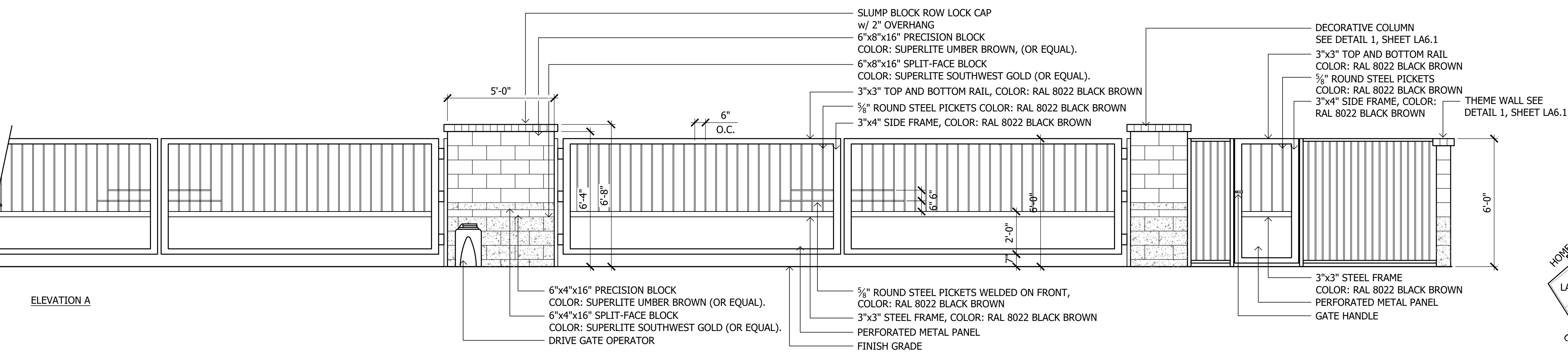

**1 Vehicle Gate Elevation**  
 SCALE: 3/8"=1'-0"

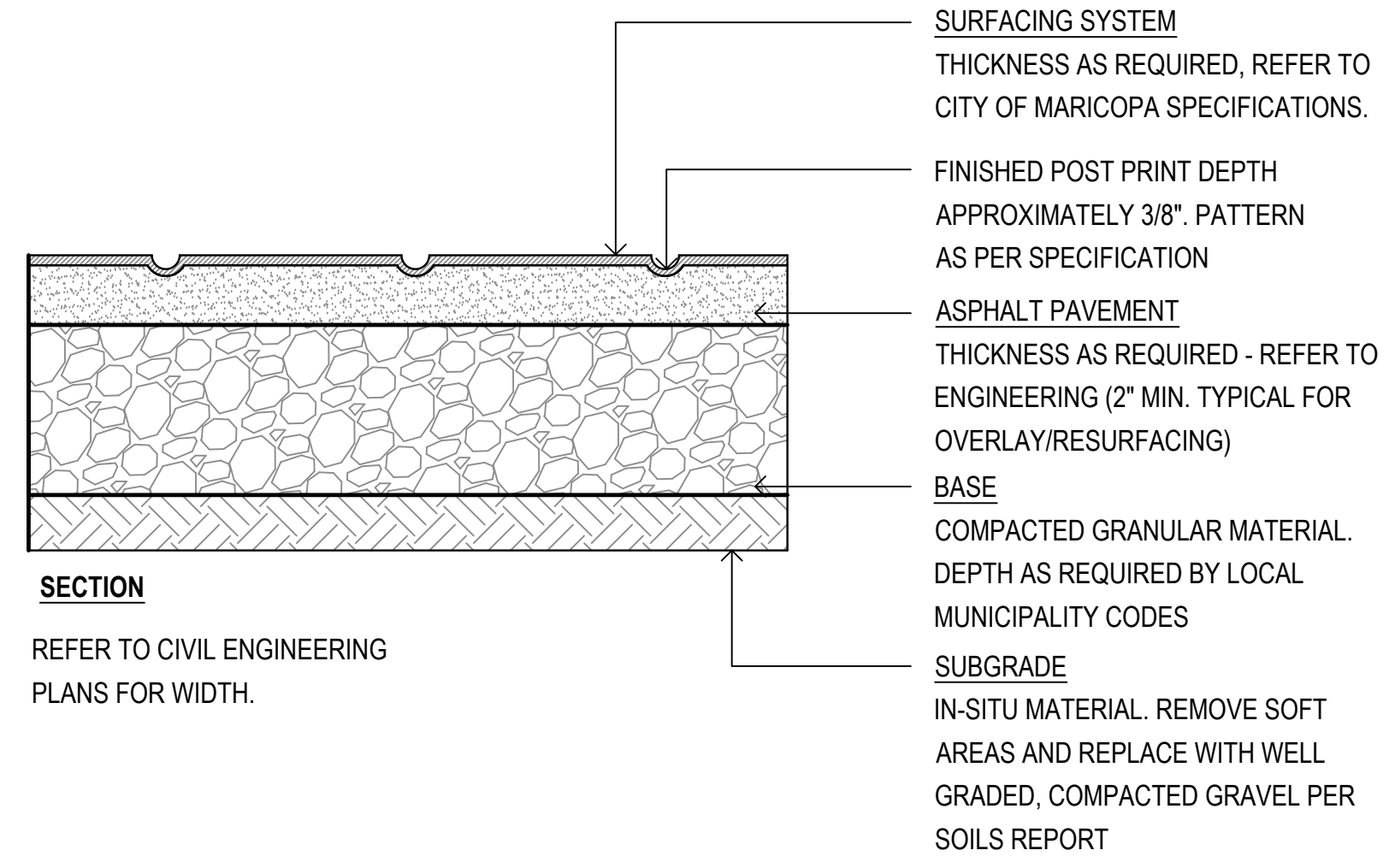

**3 Stamped Asphalt**  
 SCALE: 1/2"=1'-0"

- KEYNOTES**
- 1 VEHICLE ACCESS GATE
  - 2 VEHICLE GATE COLUMN
  - 3 GATE OPERATOR
  - 4 PEDESTRIAN ACCESS GATE
  - 5 FULL VIEW FENCE
  - 6 DECORATIVE COLUMN
  - 7 5'-0" CONCRETE SIDEWALK
  - 8 THEME WALL
  - 9 STAMPED ASPHALT
  - 10 CALL BOX
  - 11 ENTRY SIGNAGE

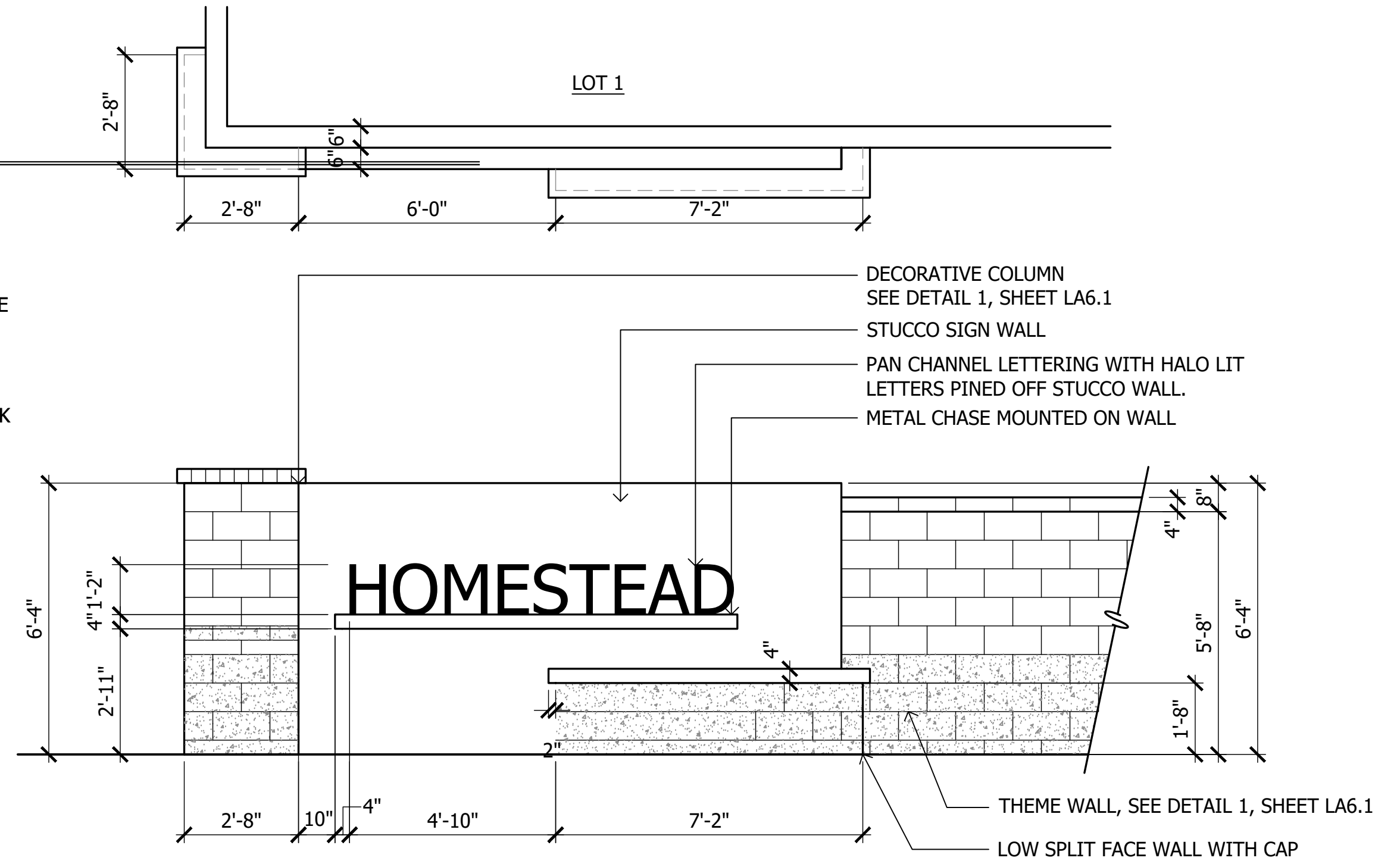

**2 Parcel Entry Feature**  
 SCALE: 3/8"=1'-0"

**STAMPED ASPHALT NOTES:**  
 Creative Paving Solutions  
 1027 E. Curry Road.  
 Tempe, AZ 85281  
 P: 480-446-9000 Ext. 228  
 WEB: www.creativepaving.com

STREETPRINT (or equal)  
 PATTERN (FIELD) - ASHLAR SLATE  
 FIELD COLOR: BROWNSTONE  
 BANDING: RUNNING BOND WITH 12" JOINTS  
 BANDING COLOR: GUN METAL

- INSTALLATION TO BE COMPLETED IN ACCORDANCE WITH MANUFACTURER'S SPECIFICATIONS

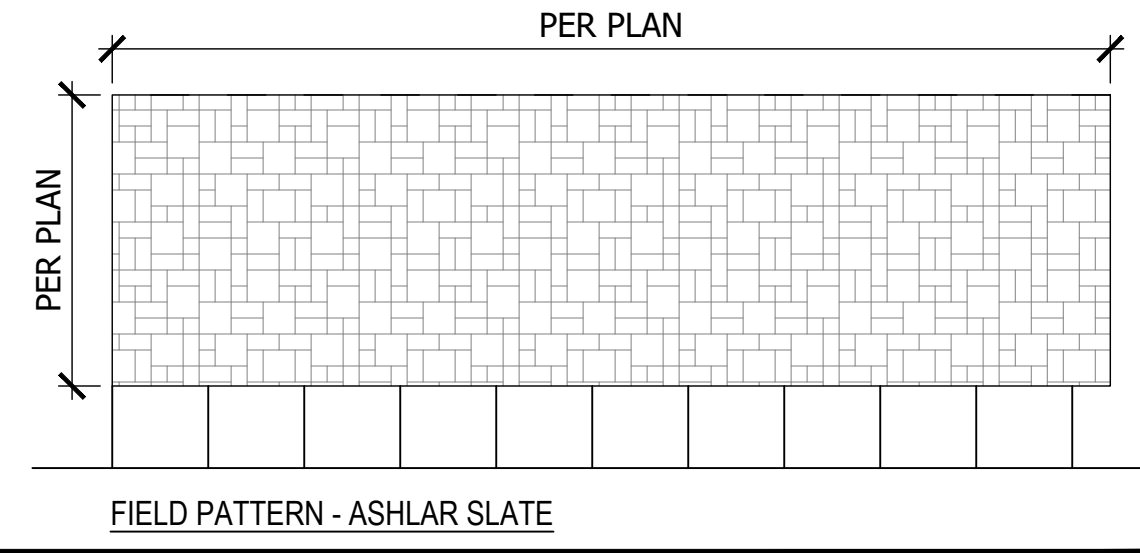

**Homestead**  
 Preliminary Plat  
 Homestead Drive & Continental Blvd  
 Maricopa, AZ

**SHEET TITLE: LAYOUT PLAN**

**D.R. HORTON**  
*America's Builder*

**LA**

**AB**

310 E. RIO SALADO PARKWAY  
 TEMPE, ARIZONA 85281  
 OFFICE: 480-530-0077  
 WEB: ABLASTUDIO.COM

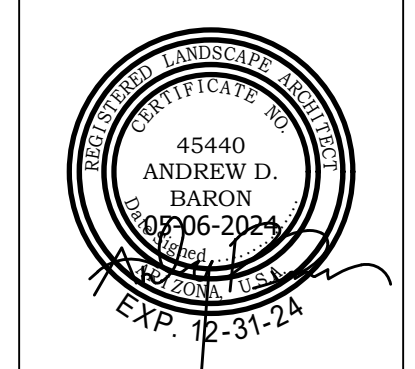

DATE: 05-06-2024  
 ISSUED FOR: PRE-PLAT  
 DRAWN BY: JM  
 CHECKED BY: TD  
 PERMIT NUMBER:  
 ABLA PROJECT NUMBER:  
 50-913-24



**KEY MAP**

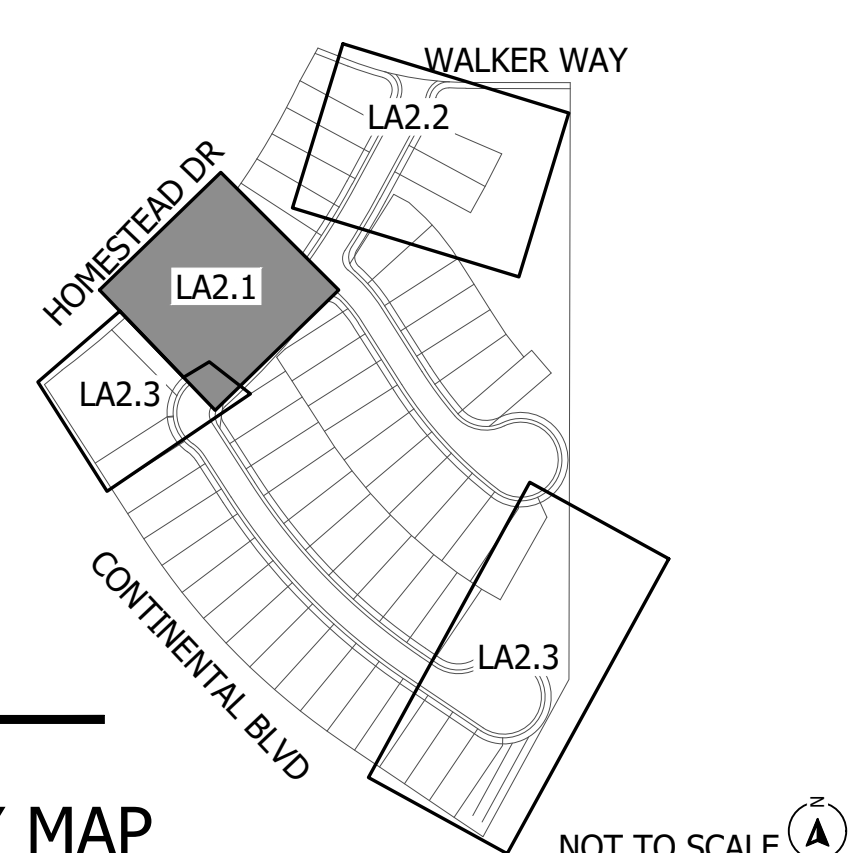

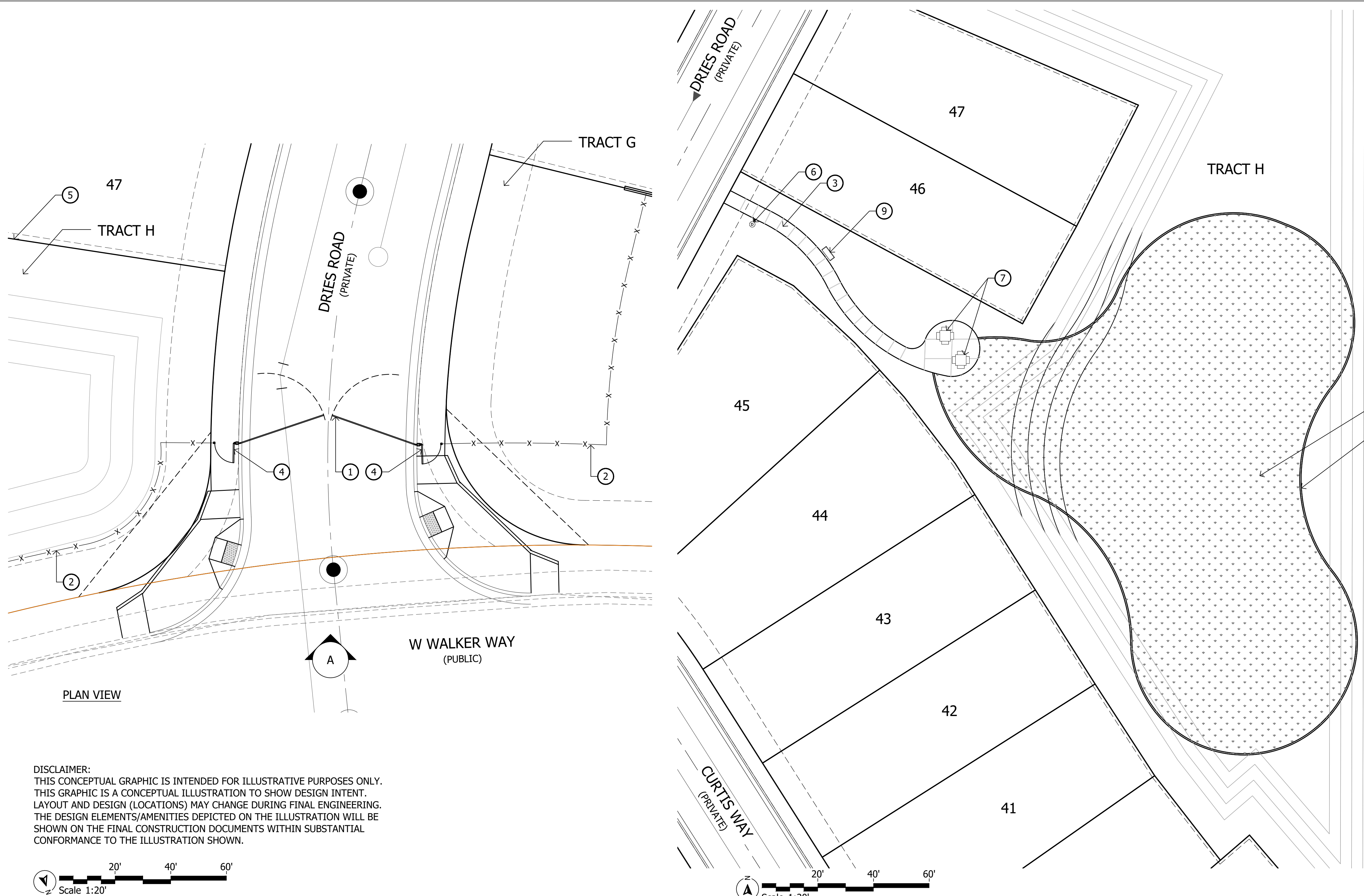

- KEYNOTES**
- ① EMERGENCY ACCESS GATE
  - ② FULL VIEW FENCE
  - ③ 5'-0" CONCRETE SIDEWALK
  - ④ PEDESTRIAN ACCESS GATE
  - ⑤ THEME WALL
  - ⑥ PET WASTE STATION
  - ⑦ TRASH RECEPTACLE
  - ⑧ GAME TABLES
  - ⑨ BENCH SEATING

TURF  
6X6  
CONCRETE  
HHEADER

**DISCLAIMER:**  
THIS CONCEPTUAL GRAPHIC IS INTENDED FOR ILLUSTRATIVE PURPOSES ONLY. THIS GRAPHIC IS A CONCEPTUAL ILLUSTRATION TO SHOW DESIGN INTENT. LAYOUT AND DESIGN (LOCATIONS) MAY CHANGE DURING FINAL ENGINEERING. THE DESIGN ELEMENTS/AMENITIES DEPICTED ON THE ILLUSTRATION WILL BE SHOWN ON THE FINAL CONSTRUCTION DOCUMENTS WITHIN SUBSTANTIAL CONFORMANCE TO THE ILLUSTRATION SHOWN.

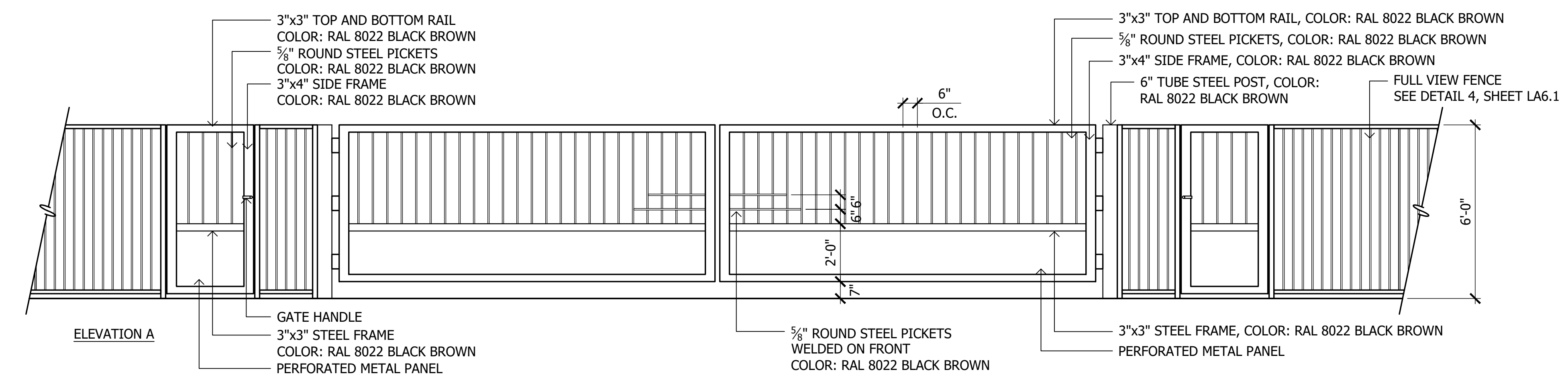
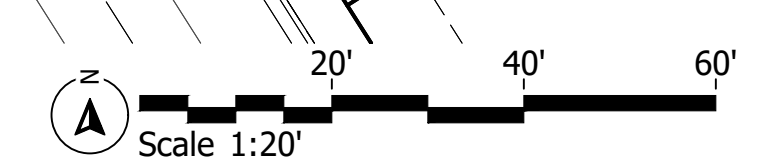
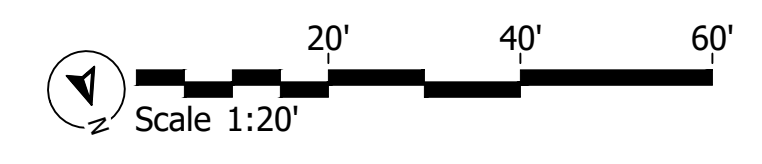

**1 Emergency Access Gate Elevation**  
SCALE: 3/8"=1'-0"

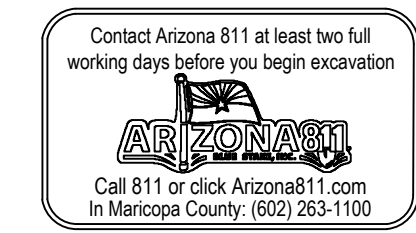

**KEY MAP**

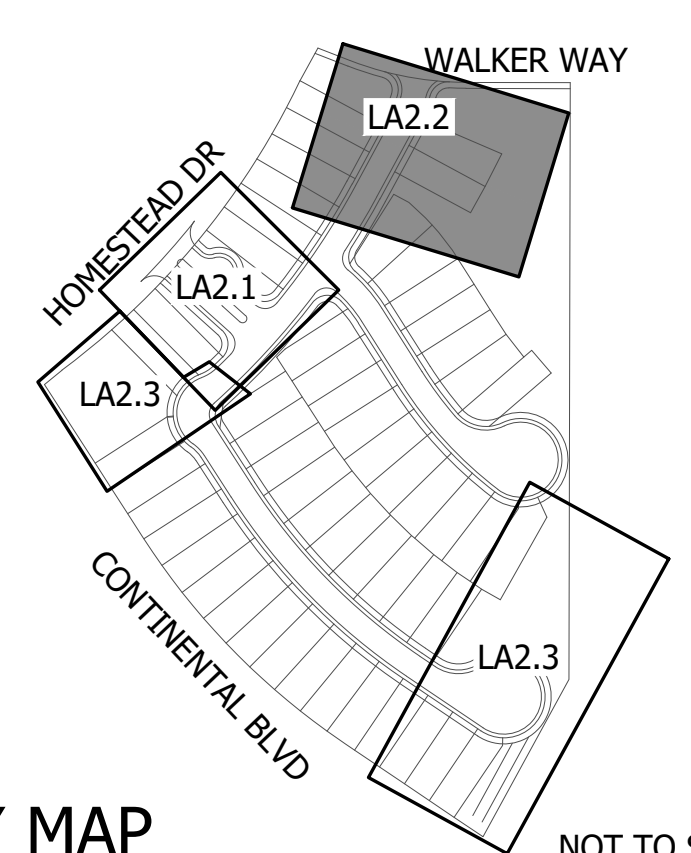

1	2	3	4	5	6
---	---	---	---	---	---

**Homestead**  
Preliminary Plat  
Homestead Drive & Continental Blvd  
Maricopa, AZ  
SHEET TITLE: LAYOUT PLAN



**ABLA**  
310 E. RIO SALADO PARKWAY  
TEMPE, ARIZONA 85281  
OFFICE: 480-530-0077  
WEB: ABLASTUDIO.COM

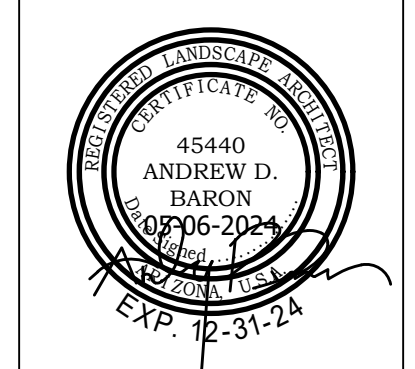

© Copyright 2024 ABLA, LLC.

DATE: 05-06-2024	ISSUED FOR: PRE-PLAT
DRAWN BY: JM	CHECKED BY: TD
PERMIT NUMBER:	ABLA PROJECT NUMBER: 50-913-24

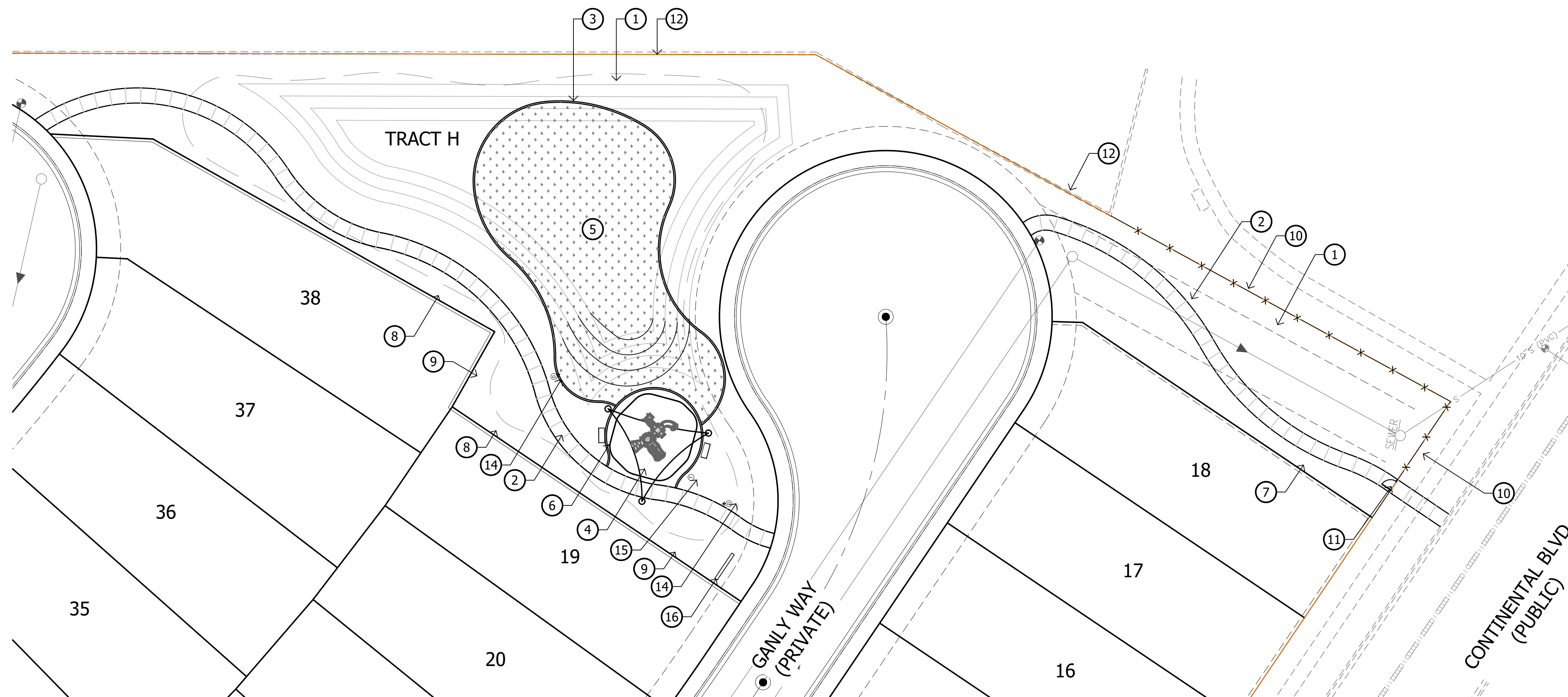

- KEYNOTES**
- 1 LANDSCAPE AREA WITH DECOMPOSED GRANITE - SEE PLANTING LEGEND
  - 2 CONCRETE SIDEWALK
  - 3 CONCRETE HEADER
  - 4 PLAY STRUCTURE WITH SLIDE AND CLIMBER AND STRUCTURE WITH ATTACHED CANVAS SHADE
  - 5 ACTIVE TURF PLAY AREA
  - 6 BENCH SEATING
  - 7 THEME WALL
  - 8 PARTIAL VIEW FENCE
  - 9 SECONDARY WALL
  - 10 FULL VIEW FENCE
  - 11 PEDESTRIAN GATE
  - 12 EXISTING WALL
  - 13 CANOPY SHADE TREES
  - 14 PET WASTE STATION
  - 15 TRASH RECEPTACLE
  - 16 PARK SIGNAGE

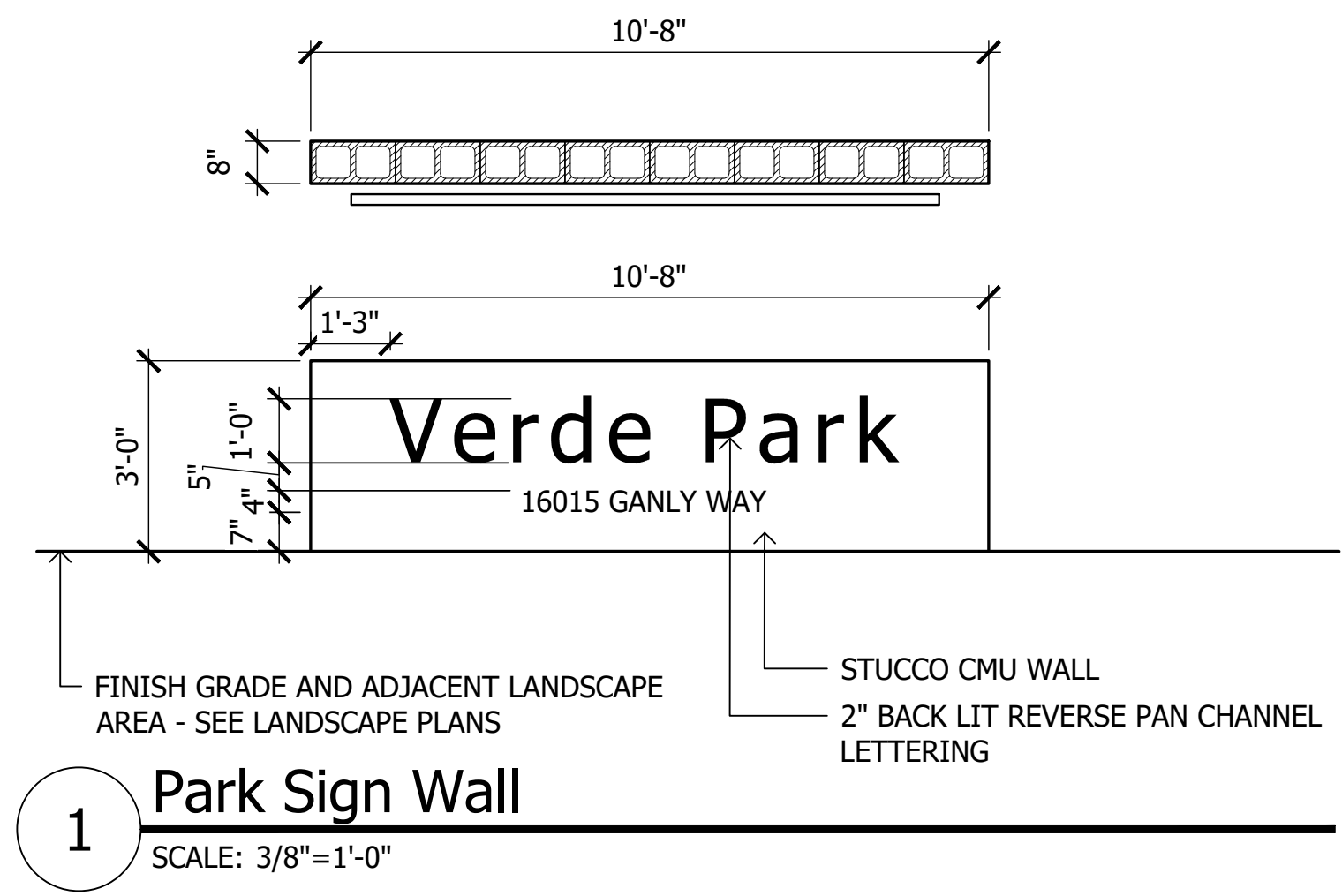
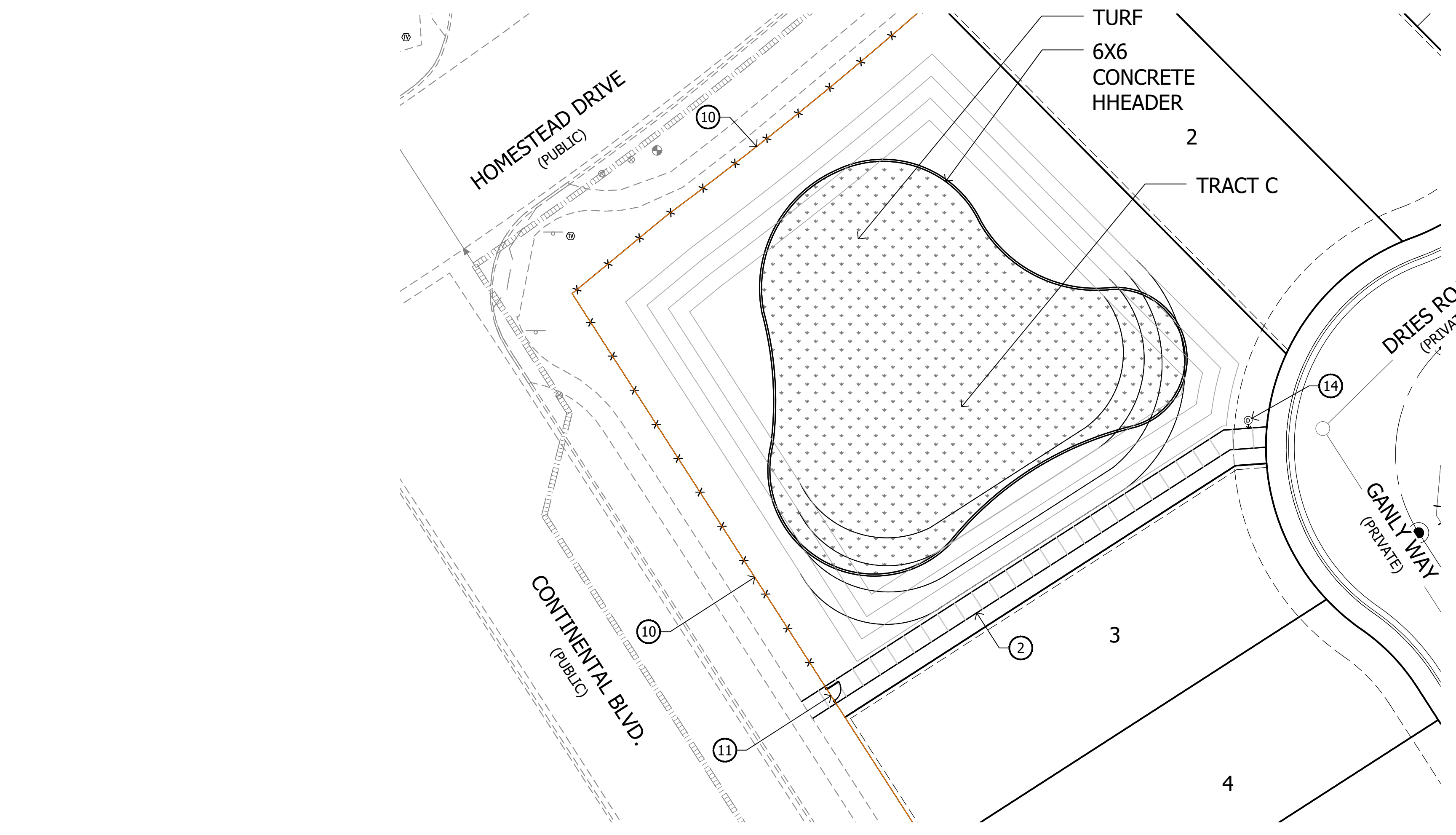

**DISCLAIMER:**  
THIS CONCEPTUAL GRAPHIC IS INTENDED FOR ILLUSTRATIVE PURPOSES ONLY. THIS GRAPHIC IS A CONCEPTUAL ILLUSTRATION TO SHOW DESIGN INTENT. LAYOUT AND DESIGN (LOCATIONS) MAY CHANGE DURING FINAL ENGINEERING. THE DESIGN ELEMENTS/AMENITIES DEPICTED ON THE ILLUSTRATION WILL BE SHOWN ON THE FINAL CONSTRUCTION DOCUMENTS WITHIN SUBSTANTIAL CONFORMANCE TO THE ILLUSTRATION SHOWN.

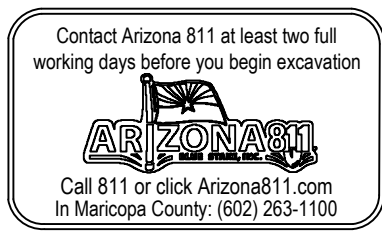
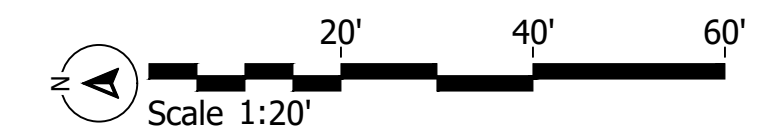

**KEY MAP**

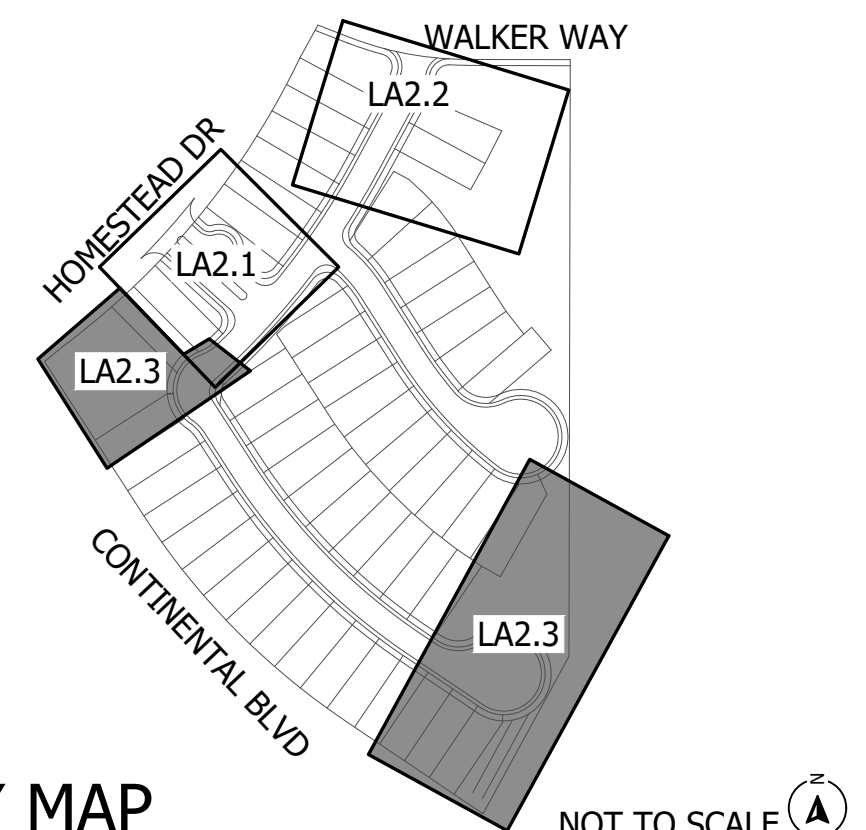

1	2	3	4	5	6
---	---	---	---	---	---

**Homestead**  
Preliminary Plat  
Homestead Drive & Continental Blvd  
Maricopa, AZ  
SHEET TITLE: LAYOUT PLAN



**ABLA**  
310 E. RIO SALADO PARKWAY  
TEMPE, ARIZONA 85281  
OFFICE: 480-530-0077  
WEB: ABLASTUDIO.COM

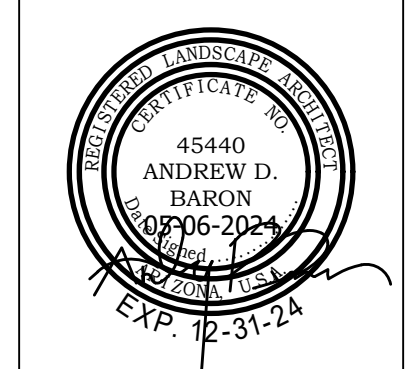

© Copyright 2024 ABLA, LLC.

DATE: 05-06-2024	ISSUED FOR: PRE-PLAT
DRAWN BY: JM	CHECKED BY: TD
PERMIT NUMBER:	ABLA PROJECT NUMBER: 50-913-24

I:\SERVER\ABLA\LOCAL\ABLA\Projects\DR Horton\Homestead\Design Development\Pre Plat\03-Planting\_Homestead\_DD.dwg

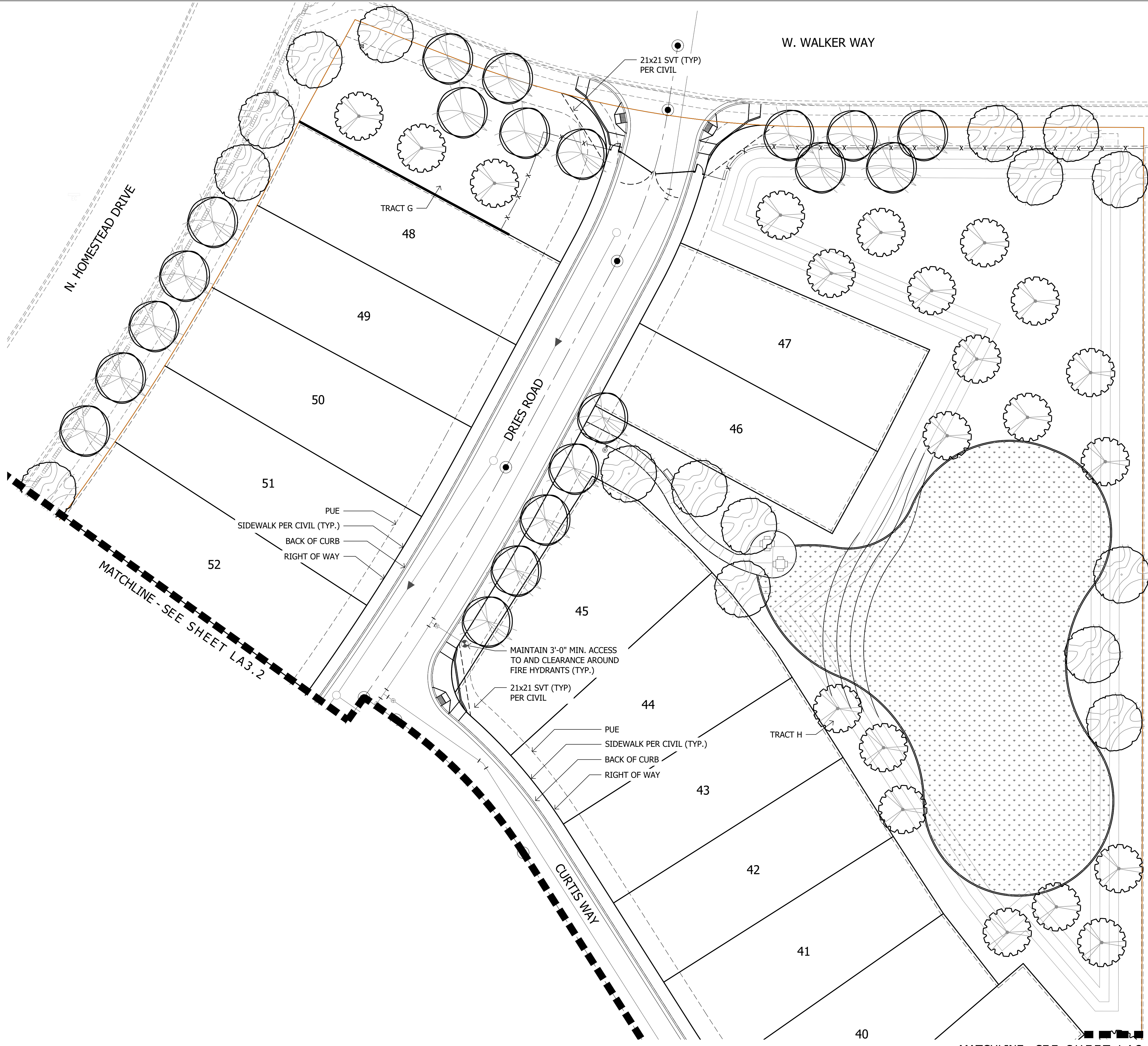

**PLANT MATERIALS LEGEND**

Tree	Box Size (in)
Caesalpinia cacalaco	24"/36"
Cascalote	24"/36"
Pistacia chinensis	24"/36"
Chinese Pistache	24"/36"
Prosopis hybrid	24"/36"
Thornless Mesquite	24"/36"
Quercus virginiana 'Cathedral'	24"/36"
Cathedral Live Oak	24"/36"
Ulmus parvifolia 'Bosque'	24"/36"
Bosque Elm	24"/36"

Extra Large Shrubs	Size	Small Shrubs	Size
Ⓢ4 Bougainvillea 'San Diego Red'	5 gal.	Ⓢ Russelia equisetiformis	5 gal.
Ⓢ9 Red Bougainvillea	5 gal.	Ⓢ Coral Fountain	5 gal.
Ⓢ Yellow Bird of Paradise	5 gal.	Ⓢ Groundcovers	Size
Ⓢ Caesalpinia pulcherrima	5 gal.	Ⓢ Eremophila prostrata	5 gal.
Ⓢ Red Bird of Paradise	5 gal.	Ⓢ Outback Sunrise Eremophila	5 gal.
Ⓢ Dodonaea viscosa	5 gal.	Ⓢ Lantana sp.	1 gal.
Ⓢ Hoppbush	5 gal.	Ⓢ 'New Gold' Lantana	1 gal.
Ⓢ Hyptis emoryi	15 gal.	Ⓢ 'New Red' Lantana	1 gal.
Ⓢ Desert Lavender	15 gal.	Ⓢ Teucrium chamaedrys 'prostratum'	1 gal.
Ⓢ Tecoma 'Sparky'	5 gal.	Ⓢ Prostrate Germander	1 gal.
Ⓢ Sparky Bells	5 gal.	Ⓢ Cacti/ Accents	Size
Ⓢ Vauquelinia californica	15 gal.	Ⓢ Asclepias subulata	5 gal.
Ⓢ Arizona Rosewood	15 gal.	Ⓢ Desert Milkweed	5 gal.
Ⓢ Large Shrubs	Size	Ⓢ Bouteloua gracilis	1 gal.
Ⓢ Calliandra californica	5 gal.	Ⓢ Blonde Ambition	1 gal.
Ⓢ Red Fairy Duster	5 gal.	Ⓢ Hesperaloe parviflora 'Brakelights'	3 gal.
Ⓢ Cassia nemophila	5 gal.	Ⓢ Brakelights Red Yucca	3 gal.
Ⓢ Desert Cassia	5 gal.	Ⓢ Muhlenbergia lindheimeri	5 gal.
Ⓢ Leucophyllum langmaniae 'Lynn's Legacy'	5 gal.	Ⓢ 'Autumn Glow'	5 gal.
Ⓢ Lynn's Legacy Sage	5 gal.	Ⓢ Muhlenbergia rigida 'Nashville'	1 gal.
Ⓢ Medium Shrubs	Size	Ⓢ Purple Muhly	1 gal.
Ⓢ Eremophila glabra spp. carnososa	5 gal.	Ⓢ Opuntia santa rita	5 gal.
Ⓢ Winter Blaze	5 gal.	Ⓢ Purple Prickly Pear	5 gal.
Ⓢ Eremophila hygrophana Blue Bells	5 gal.		
Ⓢ Blue Bells	5 gal.		
Ⓢ Leucophyllum frutescens 'Compacta'	5 gal.		
Ⓢ Compact Texas Sage	5 gal.		
Ⓢ Nerium oleander 'Little Red'	5 gal.		
Ⓢ Little Red Oleander	5 gal.		
Ⓢ Perovskia atriplicifolia	5 gal.		
Ⓢ Russian Sage	5 gal.		
Ⓢ Ruellia peninsularis	5 gal.		
Ⓢ Desert Ruellia	5 gal.		
Ⓢ Inerts	Size		
Ⓢ Decomposed Granite 7/8" Screened			
Ⓢ Apache Brown or Equal - 2.5" Deep			

- Mid-Iron Sod
  - Concrete Header - 6" Wide Standard Color and Finish
- NOTES:**
1. QUANTITIES SHOWN FOR SUBMITTAL PURPOSES ONLY.
  2. ALL QUANTITIES SHOWN ARE FOR THE LANDSCAPE ARCHITECT'S ESTIMATING PURPOSES ONLY AND THEREFORE ARE NOT GUARANTEED. THE CONTRACTOR SHALL CALCULATE QUANTITIES BASED ON THIS DRAWING SET.
  3. ALL TREES SHALL COMPLY WITH THE LATEST AMENDED EDITION OF THE "ARIZONA NURSERY ASSOCIATION - RECOMMENDED TREE SPECIFICATIONS." SEE SECTION 1903(6)(A), ZONING CODE.
  4. ALL PLANTING AREAS WILL RECEIVE A MIN. 2.5" DEPTH OF DECOMPOSED GRANITE (GRANITE TO BE 7/8" SCREENED APACHE BROWN)
  5. ALL EARTHWORK WILL BE DONE TO DRAIN AWAY FROM SIDEWALKS AND STRUCTURES & WILL NOT IMPEDE NATURAL DRAINAGE EASEMENTS.
  6. LANDSCAPE AND STRUCTURES W/IN SIGHT TRIANGLES WILL BE MAINTAINED AT A MAXIMUM HEIGHT OF 2'-0". TREES SHALL BE MAINTAINED AT A MINIMUM OF 10'-0" TO BOTTOM OF CANOPY.
  7. AT MATURITY, TREES, SHRUBS, AND GROUND COVER SHALL MAINTAIN A 3'-0" CLEARANCE FROM ALL FIRE HYDRANTS.
  8. MAINTENANCE OF ALL COMMON AREAS, TRACTS, AND LANDSCAPING IN ALL RIGHTS-OF-WAY ON ALL LOCAL, ARTERIAL, AND COLLECTOR ROADWAYS IS THE RESPONSIBILITY OF THE OWNER.
  9. NO PALO VERDES OR MESQUITE TREES ARE ALLOWED WITHIN THE RIGHT OF WAY THAT IS MAINTAINED BY THE CITY.

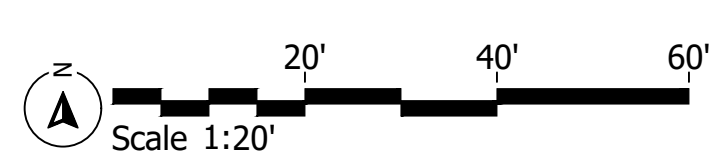
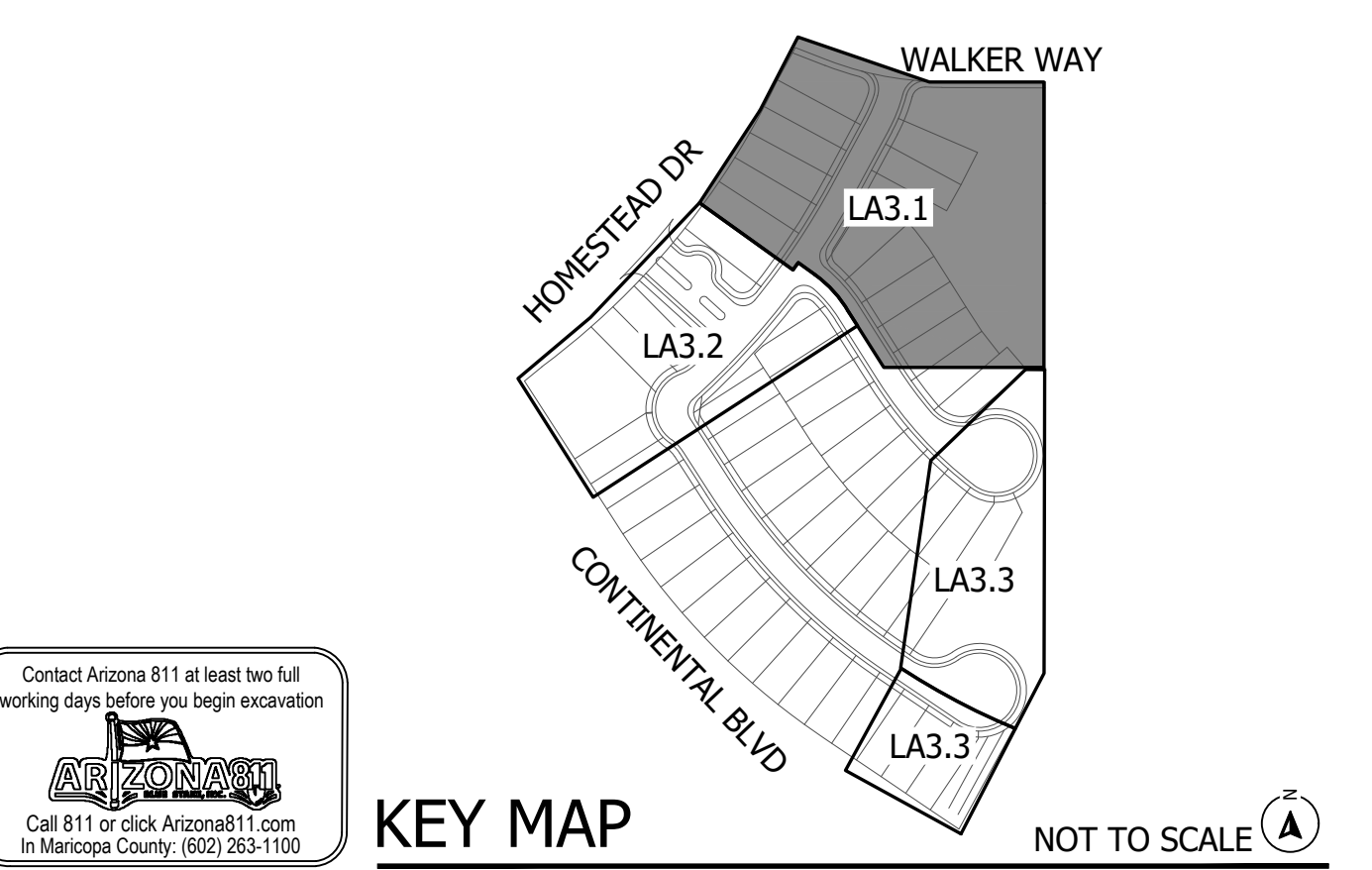

1
2
3
4
5
6

**Homestead**  
Preliminary Plat  
Homestead Drive & Continental Blvd  
Maricopa, AZ  
**SHEET TITLE: PLANTING PLAN**



**ABLA**  
**LA**  
310 E. RIO SALADO PARKWAY  
TEMPE, ARIZONA 85281  
OFFICE: 480-530-0077  
WEB: ABLASTUDIO.COM

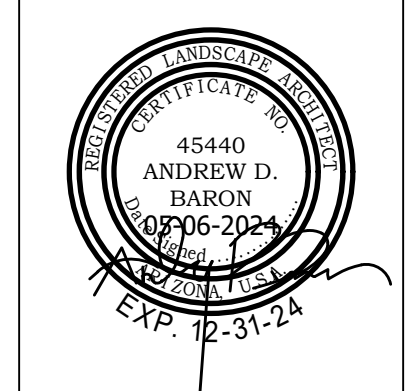

© Copyright 2024 ABLA, LLC.

DATE: 05-06-2024  
ISSUED FOR: PRE-PLAT  
DRAWN BY: JM  
CHECKED BY: TD  
PERMIT NUMBER:  
ABLA PROJECT NUMBER:  
50-913-24

I:\SERVER\ABLA\LOCAL\ABLA\Projects\DR Horton\Homestead\Design Development\Pre Plat\03-Planting\_Homestead\_DD.dwg



**PLANT MATERIALS LEGEND**

Tree	Box Size (in)
Caesalpinia cacalaco	24"/36"
Cascalote	24"/36"
Pistacia chinensis	24"/36"
Chinese Pistache	24"/36"
Prosopis hybrid	24"/36"
Thornless Mesquite	24"/36"
Quercus virginiana 'Cathedral'	24"/36"
Cathedral Live Oak	24"/36"
Ulmus parvifolia 'Bosque'	24"/36"
Bosque Elm	24"/36"

Extra Large Shrubs	Size	Small Shrubs	Size
Ⓚ Bougainvillea 'San Diego Red'	5 gal.	Ⓚ Russelia equisetiformis	5 gal.
Ⓚ Red Bougainvillea	5 gal.	Ⓚ Coral Fountain	5 gal.
Ⓚ Caesalpinia gillesii	5 gal.	Ⓚ Groundcovers	Size
Ⓚ Yellow Bird of Paradise	5 gal.	Ⓚ Eremophila prostrata	5 gal.
Ⓚ Caesalpinia pulcherrima	5 gal.	Ⓚ Outback Sunrise Eremophila	5 gal.
Ⓚ Red Bird of Paradise	5 gal.	Ⓚ Lantana sp.	1 gal.
Ⓚ Dodonaea viscosa	5 gal.	Ⓚ 'New Gold' Lantana	1 gal.
Ⓚ Hoppbush	5 gal.	Ⓚ Lantana sp.	1 gal.
Ⓚ Hyptis emoryi	15 gal.	Ⓚ 'New Red' Lantana	1 gal.
Ⓚ Desert Lavender	15 gal.	Ⓚ Teucrium chamaedrys 'prostratum'	1 gal.
Ⓚ Tecoma 'Sparky'	5 gal.	Ⓚ Prostrate Germander	1 gal.
Ⓚ Sparky Bells	5 gal.	Ⓚ Cacti/ Accents	Size
Ⓚ Vauquelinia californica	15 gal.	Ⓚ Asclepias subulata	5 gal.
Ⓚ Arizona Rosewood	15 gal.	Ⓚ Desert Milkweed	5 gal.
Ⓚ Large Shrubs	Size	Ⓚ Bouteloua gracilis	5 gal.
Ⓚ Calliandra californica	5 gal.	Ⓚ Blonde Ambition	1 gal.
Ⓚ Red Fairy Duster	5 gal.	Ⓚ Hesperaloe parviflora 'Brakelights'	3 gal.
Ⓚ Cassia nemophila	5 gal.	Ⓚ Brakelights Red Yucca	3 gal.
Ⓚ Desert Cassia	5 gal.	Ⓚ Muhlenbergia lindheimeri	5 gal.
Ⓚ Leucophyllum langmaniae 'Lynn's Legacy'	5 gal.	Ⓚ 'Autumn Glow'	5 gal.
Ⓚ Lynn's Legacy Sage	5 gal.	Ⓚ Muhlenbergia rigida 'Nashville'	1 gal.
Ⓚ Medium Shrubs	Size	Ⓚ Purple Muhly	1 gal.
Ⓚ Eremophila glabra spp. carnosa	5 gal.	Ⓚ Opuntia santa rita	5 gal.
Ⓚ Winter Blaze	5 gal.	Ⓚ Purple Prickly Pear	5 gal.
Ⓚ Eremophila hygrophana	5 gal.		
Ⓚ Blue Bells	5 gal.		
Ⓚ Leucophyllum frutescens 'Compacta'	5 gal.		
Ⓚ Compact Texas Sage	5 gal.		
Ⓚ Nerium oleander 'Little Red'	5 gal.		
Ⓚ Little Red Oleander	5 gal.		
Ⓚ Perovskia atriplicifolia	5 gal.		
Ⓚ Russian Sage	5 gal.		
Ⓚ Ruellia peninsularis	5 gal.		
Ⓚ Desert Ruellia	5 gal.		
Ⓚ Inerts	Size		
Ⓚ Decomposed Granite 7/8" Screened			
Ⓚ Apache Brown or Equal - 2.5" Deep			

- NOTES:**
1. QUANTITIES SHOWN FOR SUBMITTAL PURPOSES ONLY.
  2. ALL QUANTITIES SHOWN ARE FOR THE LANDSCAPE ARCHITECT'S ESTIMATING PURPOSES ONLY AND THEREFORE ARE NOT GUARANTEED. THE CONTRACTOR SHALL CALCULATE QUANTITIES BASED ON THIS DRAWING SET.
  3. ALL TREES SHALL COMPLY WITH THE LATEST AMENDED EDITION OF THE "ARIZONA NURSERY ASSOCIATION - RECOMMENDED TREE SPECIFICATIONS." SEE SECTION 1903(6)(A), ZONING CODE.
  4. ALL PLANTING AREAS WILL RECEIVE A MIN. 2.5" DEPTH OF DECOMPOSED GRANITE (GRANITE TO BE 7/8" SCREENED APACHE BROWN)
  5. ALL EARTHWORK WILL BE DONE TO DRAIN AWAY FROM SIDEWALKS AND STRUCTURES & WILL NOT IMPEDE NATURAL DRAINAGE EASEMENTS.
  6. LANDSCAPE AND STRUCTURES W/IN SIGHT TRIANGLES WILL BE MAINTAINED AT A MAXIMUM HEIGHT OF 2'-0". TREES SHALL BE MAINTAINED AT A MINIMUM OF 10'-0" TO BOTTOM OF CANOPY.
  7. AT MATURITY, TREES, SHRUBS, AND GROUND COVER SHALL MAINTAIN A 3'-0" CLEARANCE FROM ALL FIRE HYDRANTS.
  8. MAINTENANCE OF ALL COMMON AREAS, TRACTS, AND LANDSCAPING IN ALL RIGHTS-OF-WAY ON ALL LOCAL, ARTERIAL, AND COLLECTOR ROADWAYS IS THE RESPONSIBILITY OF THE OWNER.
  9. NO PALO VERDES OR MESQUITE TREES ARE ALLOWED WITHIN THE RIGHT OF WAY THAT IS MAINTAINED BY THE CITY.

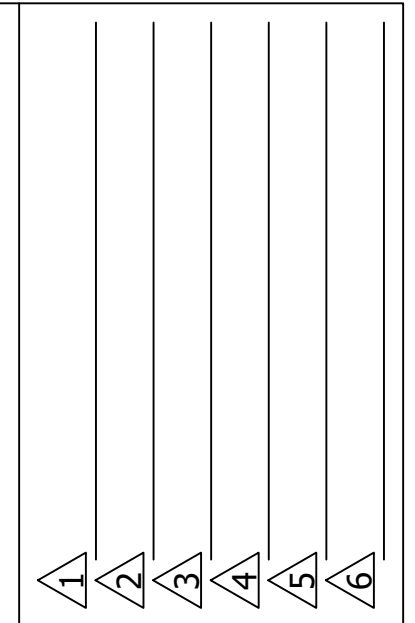
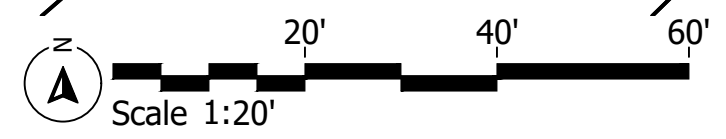
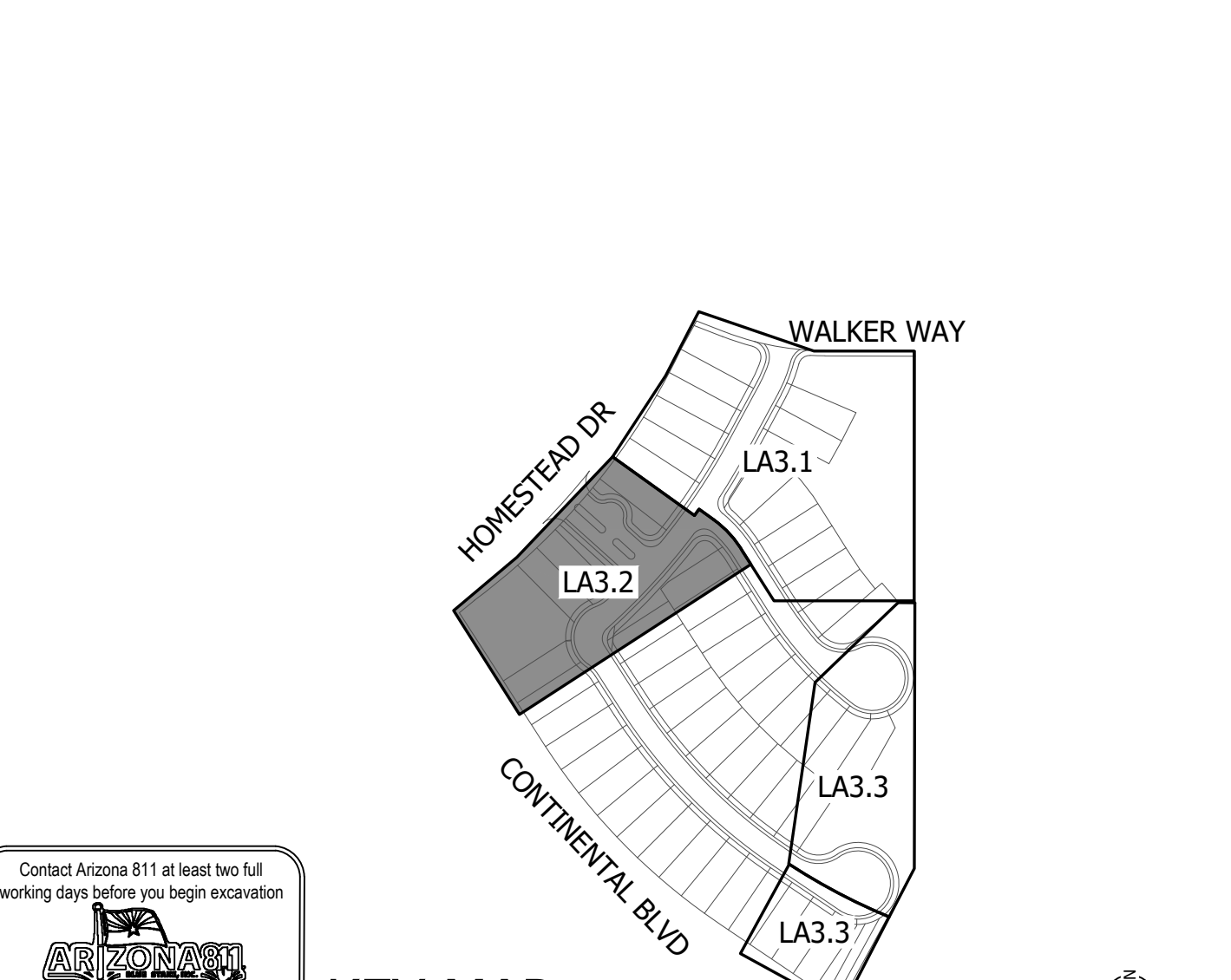

**Homestead**  
 Preliminary Plat  
 Homestead Drive & Continental Blvd  
 Maricopa, AZ  
 SHEET TITLE: PLANTING PLAN



**ABLA**  
 310 E. RIO SALADO PARKWAY  
 TEMPE, ARIZONA 85281  
 OFFICE: 480-530-0077  
 WEB: ABLASTUDIO.COM

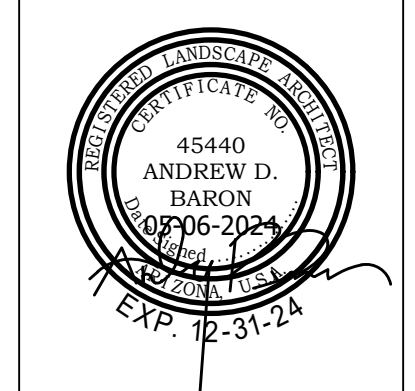

© Copyright 2024 ABLA, LLC.

DATE: 05-06-2024
ISSUED FOR: PRE-PLAT
DRAWN BY: JM
CHECKED BY: TD
PERMIT NUMBER:
ABLA PROJECT NUMBER: 50-913-24

I:\SERVER\ABLA\LOCAL\ABLA\Projects\DR Horton\Homestead\Design Development\Pre Plat\03-Planting\_Homestead\_DD.dwg

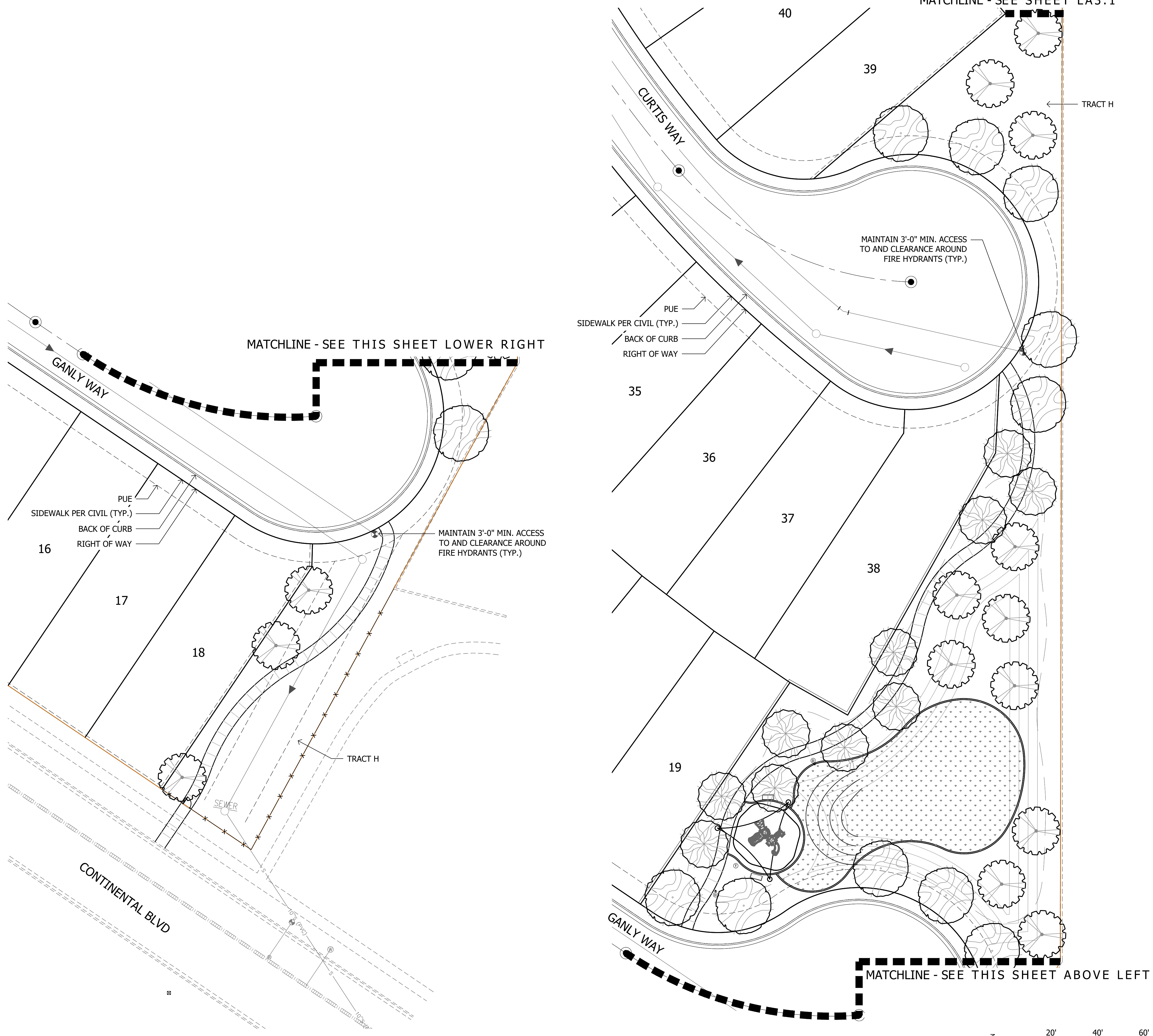

**PLANT MATERIALS LEGEND**

Tree	Box Size (in)
Caesalpinia cacalaco	24"/36"
Cascalote	24"/36"
Pistacia chinensis	24"/36"
Chinese Pistache	24"/36"
Prosopis hybrid	24"/36"
Thornless Mesquite	24"/36"
Quercus virginiana 'Cathedral'	24"/36"
Cathedral Live Oak	24"/36"
Ulmus parvifolia 'Bosque'	24"/36"
Bosque Elm	24"/36"

Extra Large Shrubs	Size	Small Shrubs	Size
Ⓢ4 Bougainvillea 'San Diego Red'	5 gal.	Ⓢ Russelia equisetiformis	5 gal.
Ⓢ Red Bougainvillea	5 gal.	Ⓢ Coral Fountain	5 gal.
Ⓢ Caesalpinia gillesii	5 gal.	Ⓢ Groundcovers	Size
Ⓢ Yellow Bird of Paradise	5 gal.	Ⓢ Eremophila prostrata	5 gal.
Ⓢ Caesalpinia pulcherrima	5 gal.	Ⓢ Outback Sunrise Eremophila	5 gal.
Ⓢ Red Bird of Paradise	5 gal.	Ⓢ Lantana sp.	1 gal.
Ⓢ Dodonaea viscosa	5 gal.	Ⓢ 'New Gold' Lantana	1 gal.
Ⓢ Hoppbush	5 gal.	Ⓢ Lantana sp.	1 gal.
Ⓢ Hyptis emoryi	15 gal.	Ⓢ 'New Red' Lantana	1 gal.
Ⓢ Desert Lavender	15 gal.	Ⓢ Teucrium chamaedrys 'prostratum'	1 gal.
Ⓢ Tecoma 'Sparky'	5 gal.	Ⓢ Prostrate Germander	1 gal.
Ⓢ Sparky Bells	5 gal.	Ⓢ Cacti/ Accents	Size
Ⓢ Vauquelinia californica	15 gal.	Ⓢ Asclepias subulata	5 gal.
Ⓢ Arizona Rosewood	15 gal.	Ⓢ Desert Milkweed	5 gal.
Ⓢ Large Shrubs	Size	Ⓢ Bouteloua gracilis	1 gal.
Ⓢ Calliandra californica	5 gal.	Ⓢ Blonde Ambition	1 gal.
Ⓢ Red Fairy Duster	5 gal.	Ⓢ Hesperaloe parviflora 'Brakelights'	3 gal.
Ⓢ Cassia nemophila	5 gal.	Ⓢ Brakelights Red Yucca	3 gal.
Ⓢ Desert Cassia	5 gal.	Ⓢ Muhlenbergia lindheimeri	5 gal.
Ⓢ Leucophyllum langmaniae 'Lynn's Legacy'	5 gal.	Ⓢ 'Autumn Glow'	5 gal.
Ⓢ Lynn's Legacy Sage	5 gal.	Ⓢ Muhlenbergia rigida 'Nashville'	1 gal.
Ⓢ Medium Shrubs	Size	Ⓢ Purple Muhly	1 gal.
Ⓢ Eremophila glabra spp. carnososa	5 gal.	Ⓢ Opuntia santa rita	5 gal.
Ⓢ Winter Blaze	5 gal.	Ⓢ Purple Prickly Pear	5 gal.
Ⓢ Eremophila hygrophana Blue Bells	5 gal.		
Ⓢ Blue Bells	5 gal.		
Ⓢ Leucophyllum frutescens 'Compacta'	5 gal.		
Ⓢ Compact Texas Sage	5 gal.		
Ⓢ Nerium oleander 'Little Red'	5 gal.		
Ⓢ Little Red Oleander	5 gal.		
Ⓢ Perovskia atriplicifolia	5 gal.		
Ⓢ Russian Sage	5 gal.		
Ⓢ Ruellia peninsularis	5 gal.		
Ⓢ Desert Ruellia	5 gal.		
Ⓢ Inerts	Size		
Ⓢ Decomposed Granite 7/8" Screened			
Ⓢ Apache Brown or Equal - 2.5" Deep			

- NOTES:**
1. QUANTITIES SHOWN FOR SUBMITTAL PURPOSES ONLY.
  2. ALL QUANTITIES SHOWN ARE FOR THE LANDSCAPE ARCHITECT'S ESTIMATING PURPOSES ONLY AND THEREFORE ARE NOT GUARANTEED. THE CONTRACTOR SHALL CALCULATE QUANTITIES BASED ON THIS DRAWING SET.
  3. ALL TREES SHALL COMPLY WITH THE LATEST AMENDED EDITION OF THE "ARIZONA NURSERY ASSOCIATION - RECOMMENDED TREE SPECIFICATIONS." SEE SECTION 1903(6)(A), ZONING CODE.
  4. ALL PLANTING AREAS WILL RECEIVE A MIN. 2.5" DEPTH OF DECOMPOSED GRANITE (GRANITE TO BE 7/8" SCREENED APACHE BROWN)
  5. ALL EARTHWORK WILL BE DONE TO DRAIN AWAY FROM SIDEWALKS AND STRUCTURES & WILL NOT IMPEDE NATURAL DRAINAGE EASEMENTS.
  6. LANDSCAPE AND STRUCTURES W/IN SIGHT TRIANGLES WILL BE MAINTAINED AT A MAXIMUM HEIGHT OF 2'-0". TREES SHALL BE MAINTAINED AT A MINIMUM OF 10'-0" TO BOTTOM OF CANOPY.
  7. AT MATURITY, TREES, SHRUBS, AND GROUND COVER SHALL MAINTAIN A 3'-0" CLEARANCE FROM ALL FIRE HYDRANTS.
  8. MAINTENANCE OF ALL COMMON AREAS, TRACTS, AND LANDSCAPING IN ALL RIGHTS-OF-WAY ON ALL LOCAL, ARTERIAL, AND COLLECTOR ROADWAYS IS THE RESPONSIBILITY OF THE OWNER.
  9. NO PALO VERDES OR MESQUITE TREES ARE ALLOWED WITHIN THE RIGHT OF WAY THAT IS MAINTAINED BY THE CITY.

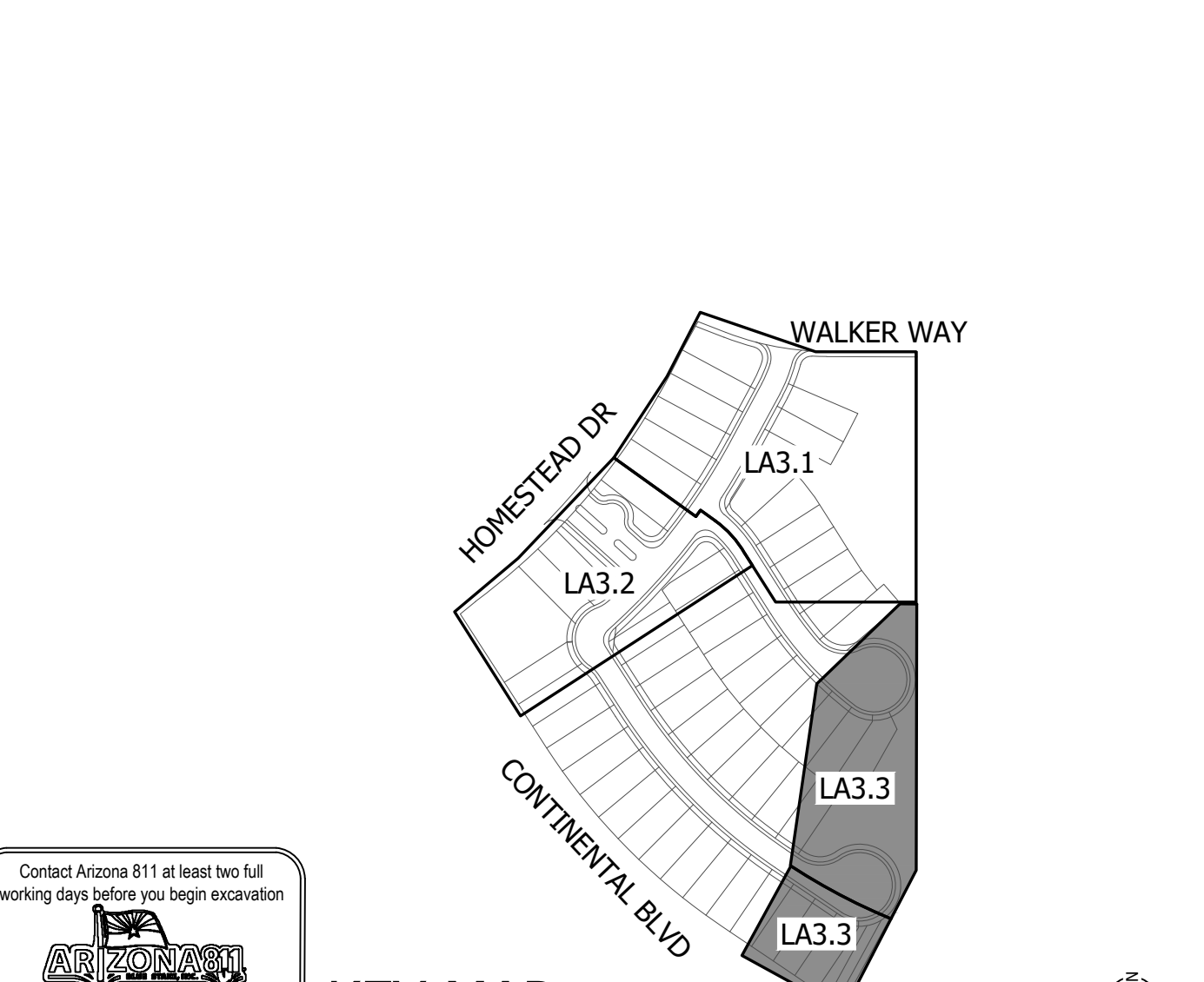

1	2	3	4	5	6
---	---	---	---	---	---

**Homestead**  
Preliminary Plat  
Homestead Drive & Continental Blvd  
Maricopa, AZ

**DR. HORTON**  
*America's Builder*

**ABLA** **LA**

310 E. RIO SALADO PARKWAY  
TEMPE, ARIZONA 85281  
OFFICE: 480-530-0077  
WEB: ABLASTUDIO.COM

45440  
ANDREW D. BARON  
07/06/2024  
EXP. 12-31-24

© Copyright 2024 ABLA, LLC.

DATE: 05-06-2024  
ISSUED FOR: PRE-PLAT  
DRAWN BY: JM  
CHECKED BY: TD  
PERMIT NUMBER:  
ABLA PROJECT NUMBER:  
50-913-24

**LA3.3**

PG: 8 OF 10



**NOTES:**  
 DECORATIVE COLUMNS SHALL BE INSTALLED  
 AT A MINIMUM EVERY 100 FEET.

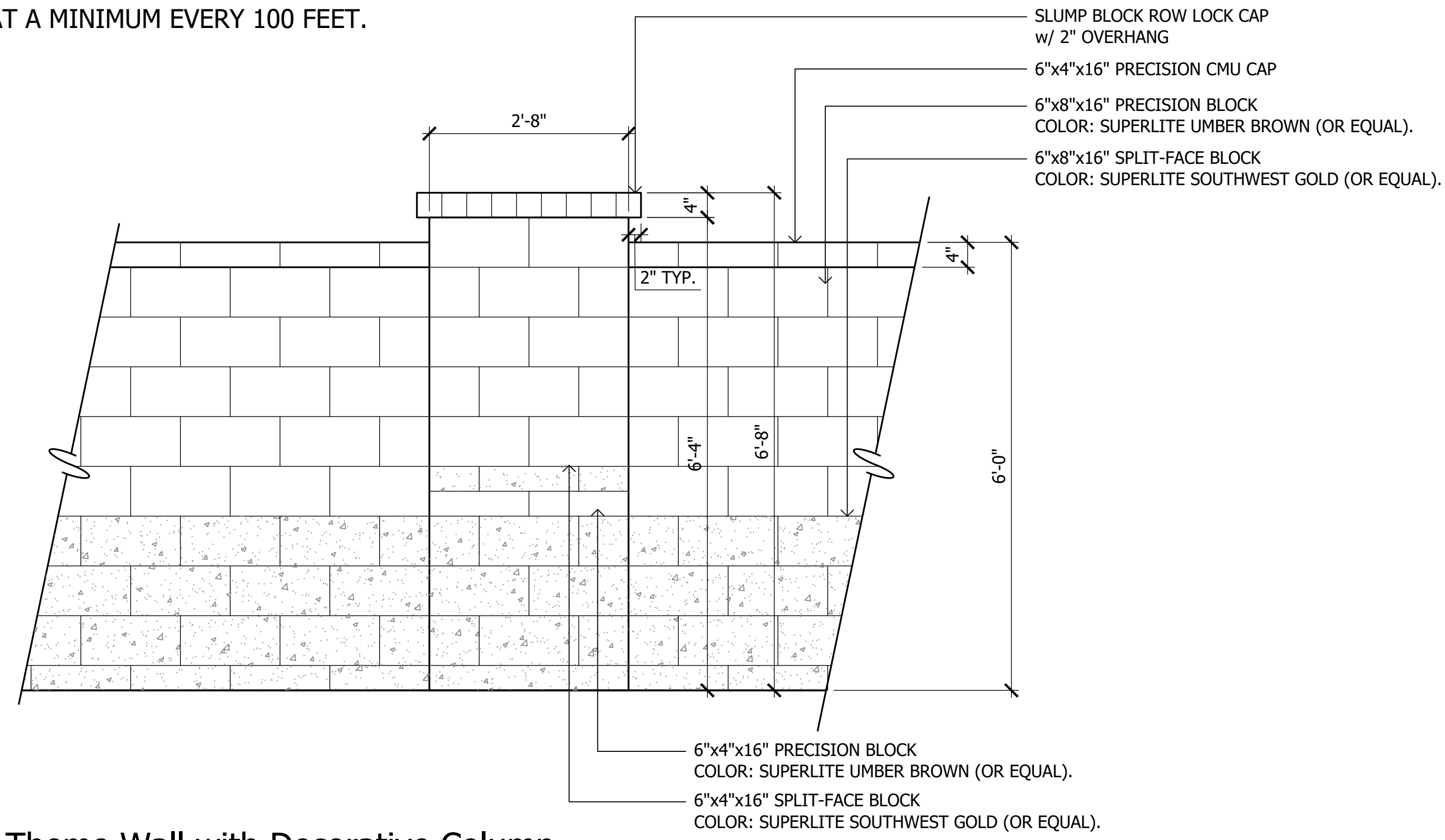

**1 Theme Wall with Decorative Column**  
 SCALE: 1/2"=1'-0"

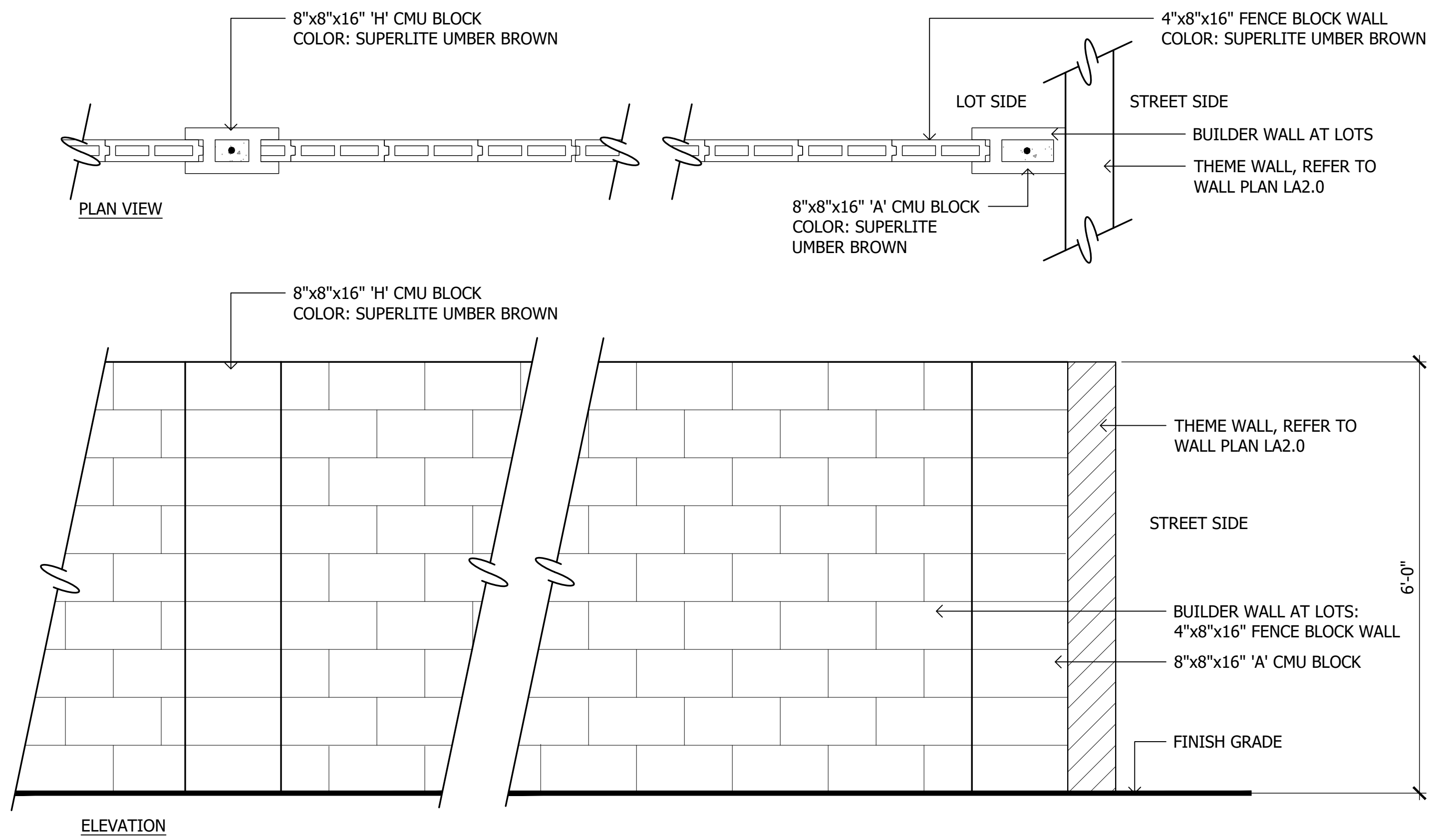

**2 Secondary Wall**  
 SCALE: 1/2"=1'-0"

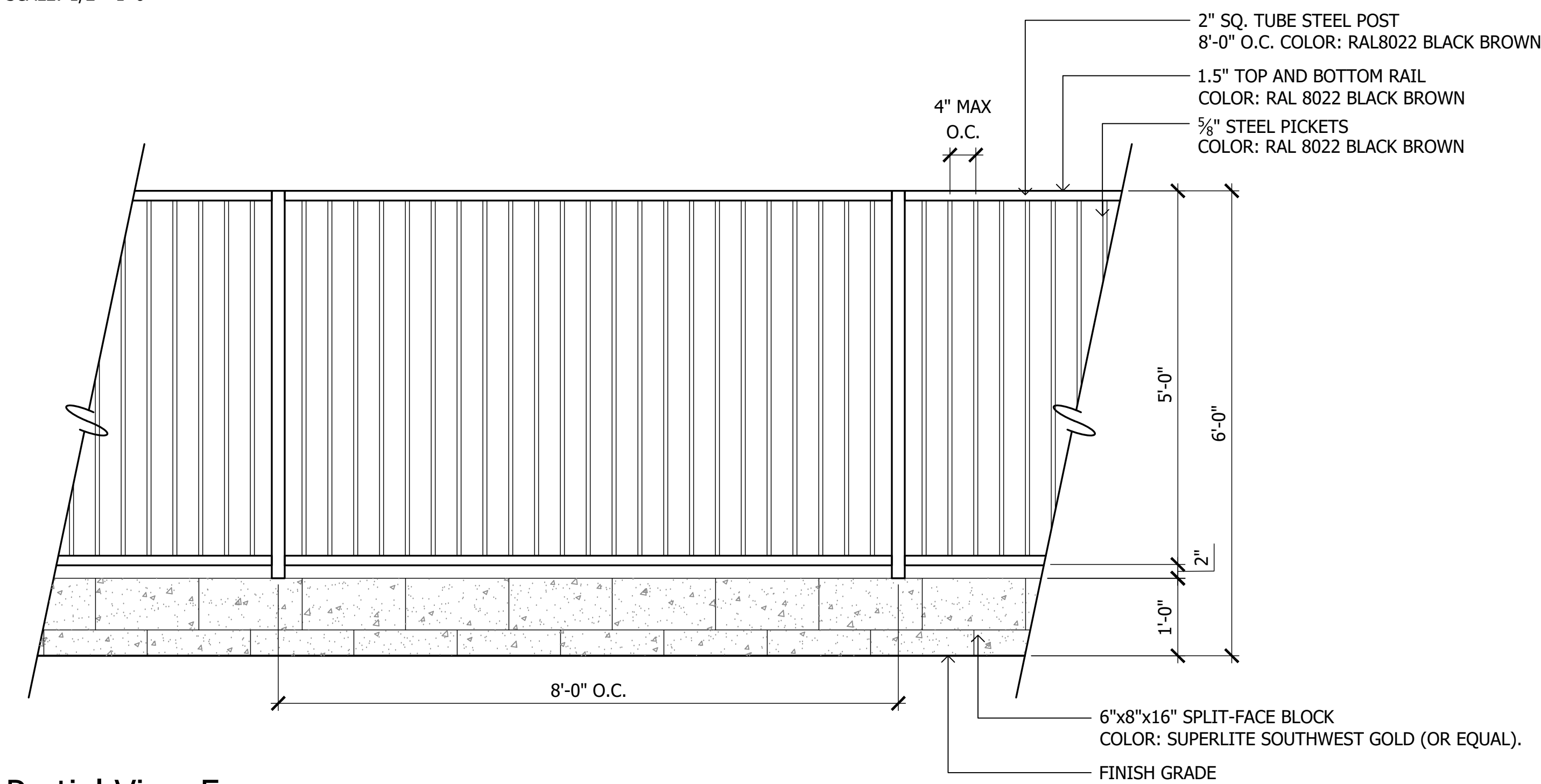

**3 Partial View Fence**  
 SCALE: 1/2"=1'-0"

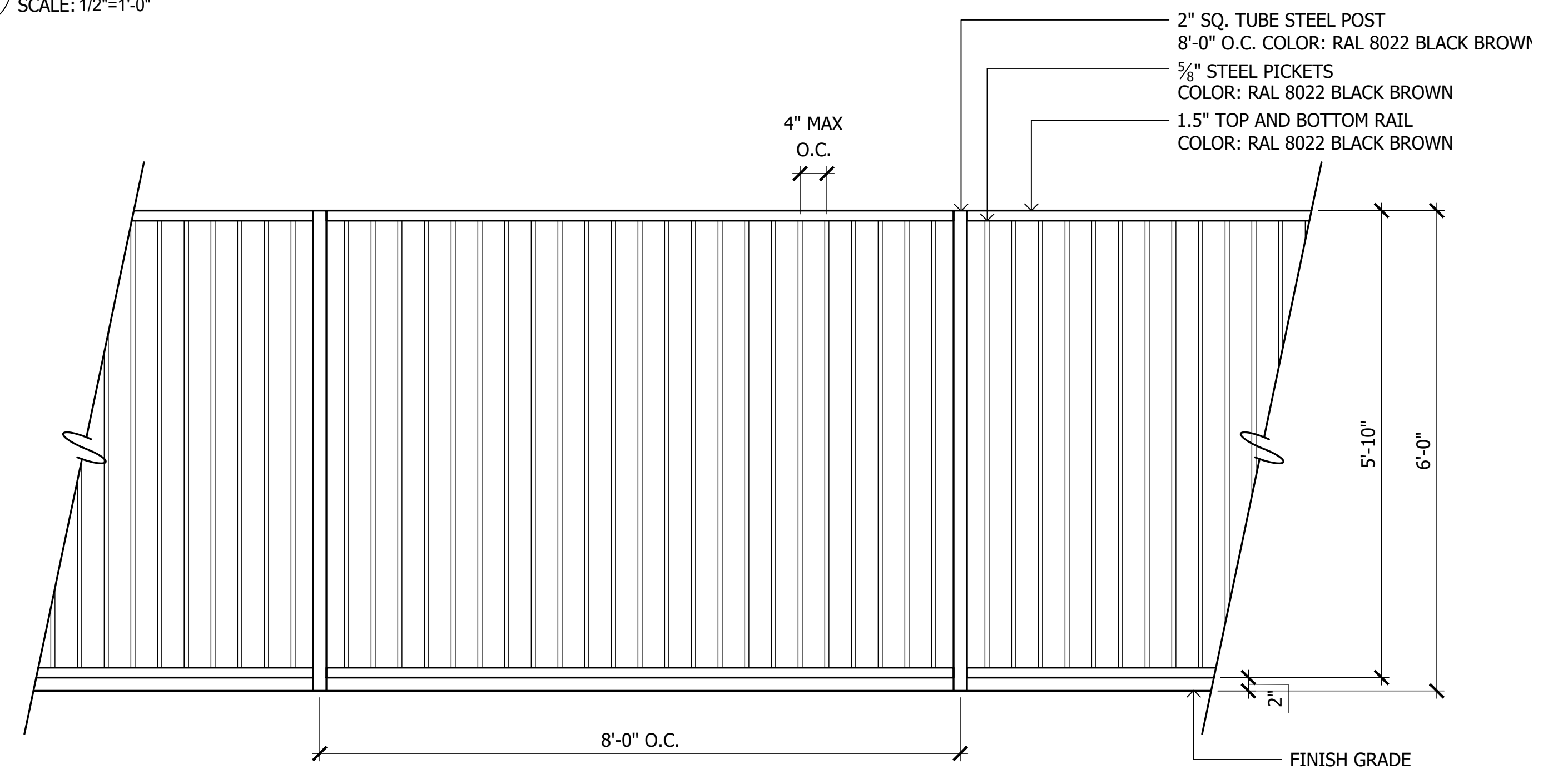

**4 Full View Fence**  
 SCALE: 1/2"=1'-0"



**SUPERLITE SPLIT-FACE:  
SOUTHWEST GOLD (OR EQUAL).**



**SUPERLITE PRECISION:  
UMBER BROWN (OR EQUAL).**



**STEEL FRAME AND PICKETS  
COLOR RAL8022:  
BLACK BROWN**

1
2
3
4
5
6

**Homestead**  
 Preliminary Plat  
 Homestead Drive & Continental Blvd  
 Maricopa, AZ  
 SHEET TITLE: CONSTRUCTION DETAILS



**ABLA**  
 310 E. RIO SALADO PARKWAY  
 TEMPE, ARIZONA 85281  
 OFFICE: 480-530-0077  
 WEB: ABLASTUDIO.COM



© Copyright 2024 ABLA, LLC.

DATE: 05-06-2024  
 ISSUED FOR: PRE-PLAT  
 DRAWN BY: JM  
 CHECKED BY: TD  
 PERMIT NUMBER:  
 ABLA PROJECT NUMBER:  
 50-913-24

**LA6.1**  
 PG: 9 OF 10



1 Pet Waste Station  
SCALE: NTS



2 Bench  
SCALE: NTS



3 Game Table  
SCALE: NTS



4 Trash Receptacle  
SCALE: NTS



5 Shade Sail at Tot Lot  
SCALE: NTS



6 Tot Lot Plat Structure  
SCALE: NTS

1
2
3
4
5
6

Homestead  
Preliminary Plat  
Homestead Drive & Continental Blvd  
Maricopa, AZ  
SHEET TITLE: CONSTRUCTION DETAILS



**ABLA**  
310 E. RIO SALADO PARKWAY  
TEMPE, ARIZONA 85281  
OFFICE: 480-530-0077  
WEB: ABLASTUDIO.COM

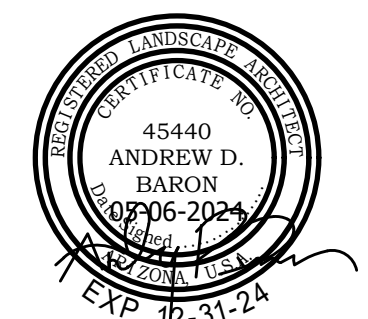

© Copyright 2024 ABLA, LLC.

DATE: 05-06-2024  
ISSUED FOR: PRE-PLAT  
DRAWN BY: JM  
CHECKED BY: TD  
PERMIT NUMBER:  
ABLA PROJECT NUMBER:  
50-913-24

I:\SERVER\ABLA\LOCAL\ABLA\Projects\DR Horton\Homestead\Landscapes\Design Development\Pre Plat\06-Details\_Homestead\_DD.dwg